



SHOP DRAWING

ELECTRONIC THERMOSTAT

STE302P SERIES - MULTIPLE PROGRAMMING



FEATURES

COLOUR

white

FINISH

molded plastic

WATTAGE & VOLTAGE

150 W to 1500 W @ 120 V / 260 W to 2600 W @ 208 V / 300 W to 3000 W @ 240 V

CONTROL

- 2-wire connection
- compatible with forced-air units (Fan mode)
- easily choose the desired preprogramming with one button
- able to program 4 periods a day during the week and 4 others per day during the weekend, for a maximum of 8/week
- anticipated start (the thermostat reaches the desired temperature at the requested hour)
- frost-free warning
- lock option at a minimum and maximum temperature setpoint (Security mode)
- protection against power failure (2 hours)
- the hour can be displayed in 12 or 24-hour mode
- display in either Celsius or Fahrenheit

ACCURACY

accurate ambient temperature control of $\pm 0.1^{\circ}\text{C}$ (0.18°F)

TEMPERATURE RANGE

between 3 and 30°C (37°F to 86°F)

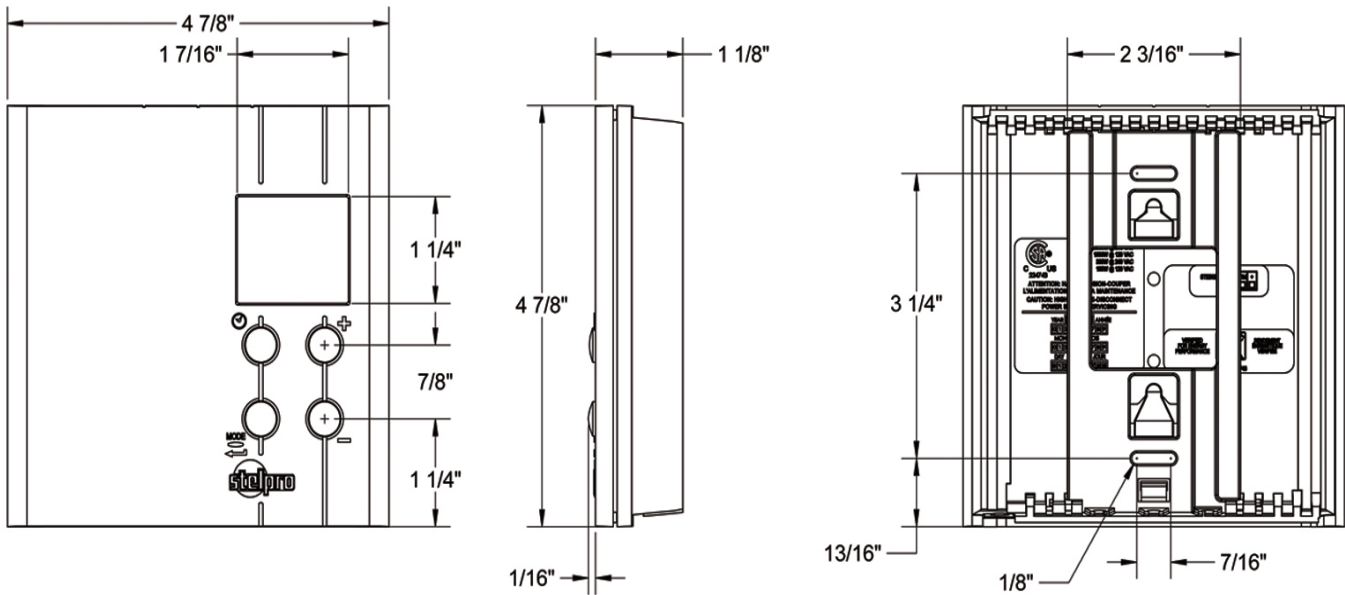

QTY	MODEL	WATTS min.	WATTS max.	VOLTS	AMP	HZ	COLOR	BACKLIGHT	UNITS

MODEL	DESCRIPTION	DELIVERY TIME

COMMENTS:	PROJECT:	
	ARCHITECT:	
	ENGINEER:	
	CONTRACTOR:	
	DISTRIBUTOR:	
	DATE:	