



Quality Products. Service Excellence.

Type 3R Mild Steel Metering Cabinets *C3RMC Series*

Hinge Door with Handle



Application

- Designed for outdoor housing of metering transformers.

Standards

- CSA Approved, Type 3R
- Complies with
 - NEMA Type 3R
 - IEC 60529, IP24

Construction

- Formed and seam welded from 14 or 16 gauge steel.
- Smooth, continuously welded seams ground smooth.
- Formed lip on enclosure to exclude flowing liquids and contaminants.
- Padlockable "L" style handle.
- Oil resistant gaskets are permanently secured.
- Removable inner panel included.
- Collar studs provided for mounting inner panel.
- Doors may be easily removed for modifications and are interchangeable.
- Bonding stud provided on door and grounding stud installed in enclosure.
- Hinges are constructed from 304 stainless steel.
- Hinge pins are stainless steel.

Finish

- Cover and enclosure are phosphatized and finished with a recoatable ANSI 61 smooth Gray powder inside and out.
- Removable inner panel is finished in white powder coating.

Accessories

- Door Stop Kit
- Mounting Foot Kit
- Drip Shield Kit

Single Door

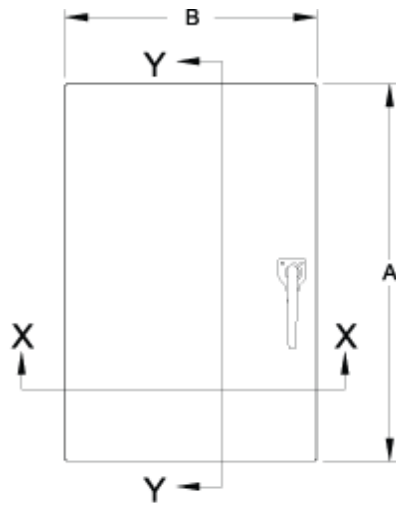

Front View

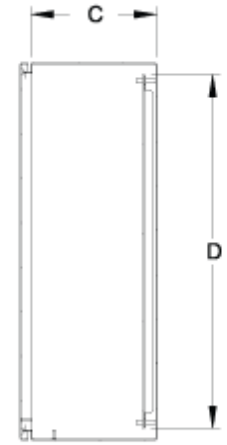

Section Y-Y

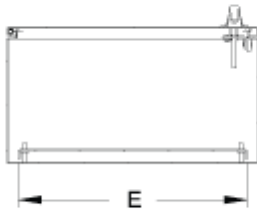

Section X-X

Double Door

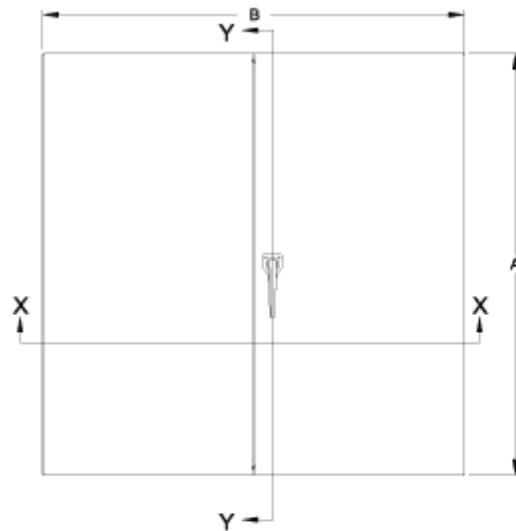

Front View



Section Y-Y

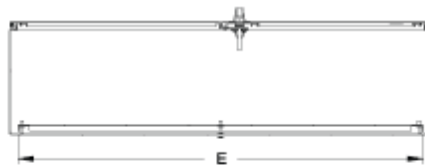

Section X-X

Part No.	Overall Dimensions			Panel Dimensions		Type of Door	Ship Wt. Lbs
	A	B	C	D	E		
C3RMC202010	20.00	20.00	10.00	18.17	18.17	Single	42
C3RMC271310	27.00	13.00	10.00	25.17	11.17	Single	38
C3RMC302010	30.00	20.00	10.00	28.17	18.17	Single	69

Part No.	Overall Dimensions			Panel Dimensions		Type of Door	Ship Wt. Lbs
	A	B	C	D	E		
C3RMC303010	30.00	30.00	10.00	28.17	28.17	Double	92
C3RMC363612	36.00	36.00	12.00	34.17	34.17	Double	131
C3RMC484812	48.00	48.00	12.00	46.17	46.17	Double	210

Data subject to change without notice

© 2017. Hammond Manufacturing Ltd. All rights reserved.