

TYPE KPU-TC

POLYTAP™



Insulated Gutter Tap for All Copper and Aluminum Combinations

Wide range-taking tin-plated aluminum parallel and perpendicular clamp and insulating cover for industrial and multiple story structure applications. Covers having flexible fingers that conform to the conductor, fully insulating the connection - eliminating the need for taping. Connector and Cover can be ordered separately. 600 Volt Max. 90° C

Features & Benefits

- 600 Volt Rated
- AL9CU dual rated for use with aluminum or copper conductor
- UL Listed to UL486A-B; CSA Certified to C22.2, No. 65
- Manufactured from high strength 6061-T6 aluminum alloy
- Electro tin plated for low contact resistance and protection against corrosion
- Tap parallel or perpendicular to run conductor
- Connectors are re-useable

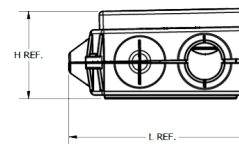
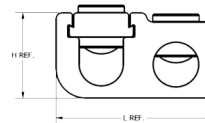
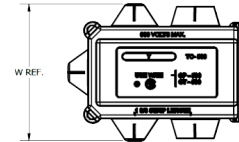
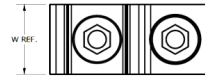
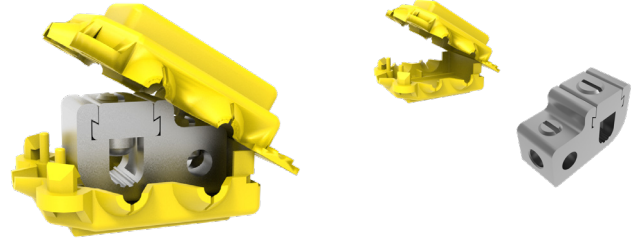

Catalog Number			Wire Range (Copper or Aluminum)		Connector/Cover in [mm]			Cover Color	Rec. Tightening Torque in-lb (AWG)
Connector with Cover	Connector Only	Cover Only	Run	Tap	H	L	W		
KPU2C4CTC	KPU2C4CT	KPU1C	12 AWG - 2 AWG	14 AWG - 4 AWG (Cu) 12 AWG - 4 AWG (Al)	.88 [22] 2.62 [67]	1.39 [35] 1.55 [39]	.63 [16] 1.26 [32]	Yellow	35 (10-14); 40 (8); 45 (4-6); 50 (2-3)
KPU2929TC	KPU2929T	KPU3C	1/0 AWG - 250 kcmil	6 AWG - 250 kcmil	1.31 [33] 3.44 [87]	2.28 [58] 2.00 [51]	1.06 [27] 1.63 [41]	Red	275
KPU3434TC	KPU3434T	KPU5C	350 kcmil - 500 kcmil	2 AWG - 500 kcmil	1.75 [44] 4.89 [124]	3.13 [79] 2.34 [59]	1.38 [35] 2.12 [54]	Blue	375

TYPE UCU-AC

RISER TAP



600 VOLT MAX. 90° C MAX

Parallel-groove riser tap and insulation cover for copper and aluminum. Wide range-taking assembly for apartment house and light industrial applications. Cover and connector are packaged together. Covers having insulating fingers that conform to conductors, fully insulating the connection. UL486B Listed for 600 volts max. 90° C service

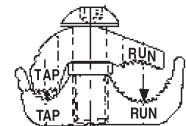
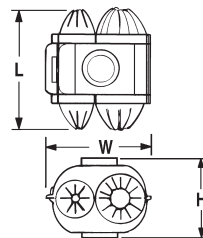
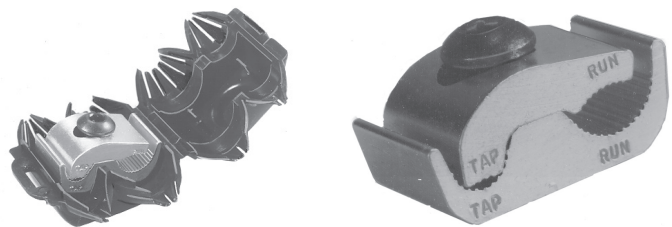

Catalog Number	Conductor Copper or Aluminum		W	H	L	Recommended Tightening ▲ Torque in-lb
	Run	Tap				
UCU28AC	#2 Str. - 4/0 Str.	#10 Sol. - #2 Str.	2-1/4	1-13/16	2-5/8	120

▲ Listed torque values are for maximum conductor combinations accommodated. Consult UL486 Tables 21, 22, 23 (found in Section O of this catalog) for smaller conductor combinations.