



Continuous light element, green, 12-230 V AC/DC, 70 mm diameter, base BA 15d without light element

product brand name	SIRIUS	
product designation	Continuous light element	
design of the product	without light source	
<b>General technical data</b>		
type of voltage of the operating voltage	AC/DC	
operating voltage		
• at DC rated value	12 ... 230 V	
• at AC at 50 Hz rated value	12 ... 230 V	
• at AC at 60 Hz rated value	12 ... 230 V	
reference code according to EN 61346-2	P	
<b>Lamp</b>		
product component light source	No	
type of light source	filament lamp / LED	
design of the optical signal	continuous light	
light intensity	0.52 cd	
light intensity	0.4 ... 0.67 cd	
socket design	BA 15d	
<b>Enclosure</b>		
height	65.5 mm	
width	70 mm	
outer diameter of the signal column element	70 mm	
material	PC	
color	green	
fastening method	Bayonet	
protection class IP	IP65	
<b>Ambient conditions</b>		
ambient temperature during operation	-20 ... +60 °C	
<b>Certificates/ approvals</b>		
General Product Approval	EMC	Declaration of Conformity

[Confirmation](#)



other

[Confirmation](#)

## Further information

Information- and Downloadcenter (Catalogs, Brochures,...)

<https://www.siemens.com/ic10>

Industry Mall (Online ordering system)

<https://mall.industry.siemens.com/mall/en/en/Catalog/product?mfb=8WD4400-1AC>

Cax online generator

<http://support.automation.siemens.com/WW/CAXorder/default.aspx?lang=en&mfb=8WD4400-1AC>

Service&Support (Manuals, Certificates, Characteristics, FAQs,...)

<https://support.industry.siemens.com/cs/ww/en/ps/8WD4400-1AC>

Image database (product images, 2D dimension drawings, 3D models, device circuit diagrams, EPLAN macros, ...)

[http://www.automation.siemens.com/bilddb/cax\\_de.aspx?mfb=8WD4400-1AC&lang=en](http://www.automation.siemens.com/bilddb/cax_de.aspx?mfb=8WD4400-1AC&lang=en)

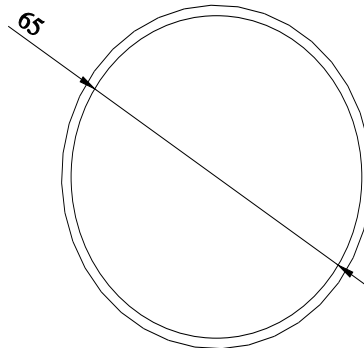
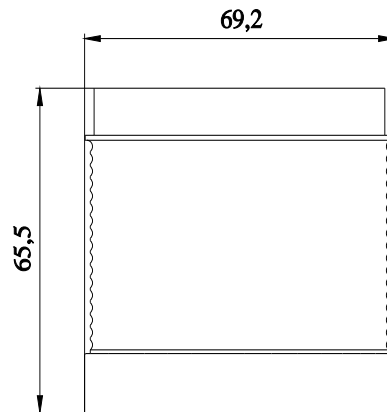

**-P**

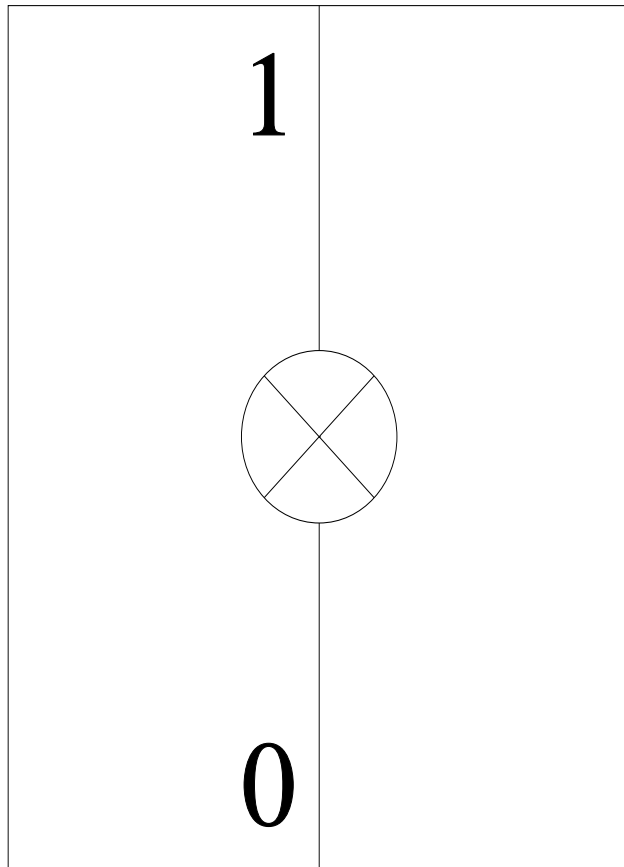

last modified:

2/25/2021 