

## Wireless Decora® 0-10V Wall Dimmer



### Description

The ZS057 is a robust rocker manual switch with dimming bar used to provide wireless control of lighting loads including high inrush LED loads. The ZS057 is compatible with other Leviton wireless products. Requires use with Lumina™ RF Keypad Room Controller or GreenMAX® DRC Wireless Keypad Room Controller.

### Features

- Use as a standalone dimmer or as part of a wireless system
- Compatible with multiple load types—any 0-10V controlled load, ex: LED, HID, inductive, fluorescent
- Integrated H.I.S. (High Inrush Stability) Relay—for ON/OFF control
- Aesthetically pleasing intuitive design—rocker switch and slender raise/lower side bar for ON/OFF, raise/lower control
- Wireless mesh network—self-healing mesh network has no hardwired backbone and connects all products together for a more robust and reliable wireless system
- Requires a room controller to wirelessly operate within a mesh network

### Features, cont'd

- Robust and reliable—mechanically held latching relay for high inrush (LED) and large commercial loads
- LED flexibility—enable, disable or turn OFF LED lights after five seconds for applications where brightness is a factor (i.e. hospitality)
- LED Indicator—inconspicuous LED light level indicator for locating in a dark room
- 3-way switching
- Standard size for seamless installation—fits in a standard single-gang wall box
- Available in White with Color Change Kit available for Ivory and Light Almond
- Complies with IEEE 802.15.4 standards—for domestic and international wireless networks
- Can be used as a component in a system to meet energy code requirements for IECC, ASHRAE 90.1, and 2019 Title 24, Part 6 space/area control, dimming, manual-ON/OFF occupancy/vacancy control and automatic shutoff requirements

### Wiring Diagram

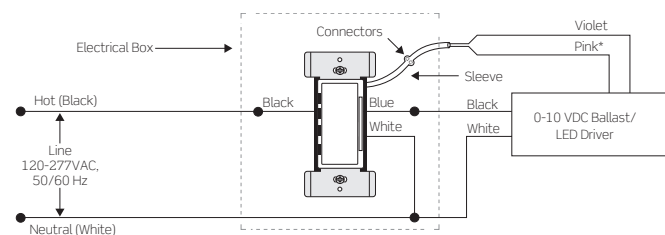

\*Depending on manufacture date, pink wire may be gray

### Leviton Manufacturing Co., Inc. Lighting & Controls

10385 SW Avery Street, Tualatin, OR 97062 tel 503-404-5500 tech line (8:30AM-7:30PM ET Mon-Fri) 800-824-3005

©2022 Leviton Manufacturing Co., Inc. All rights reserved. Subject to change without notice.

**Dimensions Diagram**

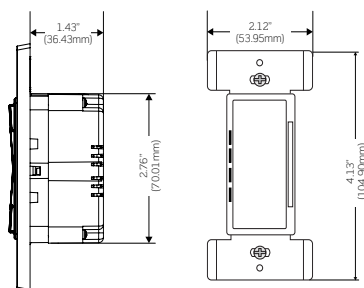

**User Interface**

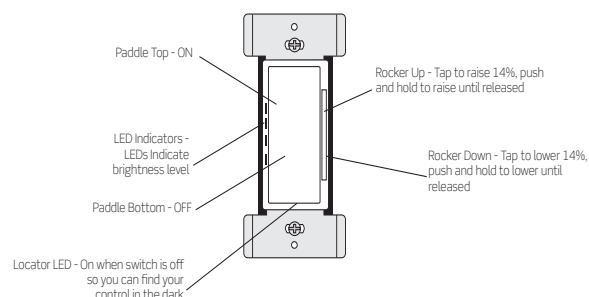

**Specifications**

Electrical	ZS057-D0Z	ZS057-30Z
Input Voltage	120-277VAC, 50/60Hz, +/- 5%	347VAC +/- 8%, 60Hz +/- 5%
Load Rating	Current Rating: 8A@120VAC for Electronic and Magnetic Ballast, @277VAC and CFL, LED Loads Incandescent/Tungsten: 120VAC, 50/60Hz, 800W Ballast: 1200VA @120VSV, 2700VA @277VAC	Current Rating: 4A for Electronic and Magnetic Ballast, CFL, LED Loads Incandescent/Tungsten: 347VAC, 60Hz, 800W Ballast: 347VAC, 60Hz, 1200VA
Motor Load	1/4HP @ 120VAC, 1/3HP @ 277VAC	347VAC, 60Hz, 1/4 HP
Radio Frequency	2.4GHz	
Environmental		
Operating Temperature Range	32° to 104° F (0° to 40° C), 0-90% non-condensing humidity	
Storage Temperature Range	14° to 185° F (-10° to 85° C)	
Usage	Indoors only	
Header		
Energy Codes	Can be used as a component in a system to meet energy code requirements for IECC, ASHRAE 90.1, and 2019 Title 24, Part 6 space/area control, dimming, manual-ON/OFF, occupancy control and automatic shutoff requirements	
Listings	FCC ID: QGH-B167601; IC: 2473A-B167601; UL Listed; NOM Certified, IC Certified (Canada)	
Dimensions	4.13" x 2.12" x 1.43" (104.90mm x 53.95mm x 36.43mm)	
Weight	0.25lbs (0.11kg)	
Warranty	2-Year Limited	

**Ordering Information**

Product Name	
Cat. No.	Description
ZS057-D0Z	Wireless Decora 0-10V Wall Dimmer, 2.4GHz, 120-277VAC, 50/60Hz, 8A Load, 0-10V Sinking, 50mA, Available in White with Color Change Kit available for Ivory and Light Almond
ZS057-30Z	Wireless Decora 0-10V Wall Dimmer, 2.4GHz, 347VAC, 50/60Hz, 4A Load, 0-10V Sinking, 50mA, Available in White with Color Change Kit available for Ivory and Light Almond

**Leviton Manufacturing Co., Inc. Lighting & Controls**

10385 SW Avery Street, Tualatin, OR 97062 tel 503-404-5500 tech line (8:30AM-7:30PM ET Mon-Fri) 800-824-3005

Visit our Website at: [www.leviton.com/greenmaxdrc](http://www.leviton.com/greenmaxdrc)

©2022 Leviton Manufacturing Co., Inc. All rights reserved. Subject to change without notice.

LES-G-10371E/H22-aa  
REV AUG 2022