

LEVITON[®]

Getting Started Guide



decora smart[™]
DIMMER

WEB VERSION

Cat. No. DW6HD



Welcome to the My Leviton™ Family



See the complete line of My Leviton™ app compatible dimmers, switches, plug-ins and controllers at leviton.com/decorasmart



works with
my leviton

WEB VERSION



Welcome



The Decora Smart dimmer with Wi-Fi technology allows you to control your lights from a smartphone or tablet even when you're away from home as long as you have an internet connection. Use the built-in scheduling to control your light at specific times of the day, and at sunrise or sunset.

The Decora Smart dimmer looks at home with your other Decora branded devices. It has a convenient manual on/off control, an integrated bar to provide light level adjustment, and hidden indicator lights.

We are here to help



CALL

1-800-824-3005 (USA)
1-800-405-5320 (Canada)



CHAT

www.leviton.com



ONLINE

leviton.com/decorasmart



EMAIL

dssupport@leviton.com



Your dimmer works with:

- Your Decora Smart Dimmer with Wi-Fi Technology is compatible with dimmable LED, dimmable CFL, and incandescent bulbs.
- Your dimmer should not be used with metal wallplates, electronic low voltage, motor loads or aluminum wire.
- If the dimmer is controlled from more than one location, you will need a DD00R remote. See the DD00R installation instructions for wiring directions.
- When two or more dimmers are installed next to each other the incandescent load rating becomes 500W for each dimmer. No reduction is necessary if the load is LED or CFL.
- For LED compatibility recommendations, go to www.leviton.com/LED.
- For additional support use the support options in the My Leviton app.



RATINGS	
LED / CFL	300W - 120VAC, 60Hz
Incandescent	600W - 120VAC, 60Hz
Operating Temp	0°C - 40°C (32°F - 104°F)
Operating Humidity	0-90% non-condensing
NETWORK	
Wi-Fi	802.11 a/b/g/n @ 2.4GHz and 5GHz
Security	WPA or WPA2
MY LEVITON APP	
iOS	Version 11 or later
Android	Version 6 or later



Features

Dim / bright bar

Manually adjust light levels.

Rocker

Manually turn light on.
The bottom of the paddle
turns the light off.

Brightness indicator lights

Displays light level when
adjusting brightness.

Status light

Illuminates when load is off.

Air gap switch

This feature will stop power to the dimmer. Gently pull bottom out until a click is heard. Power to the dimmer and indicator lights will turn off. After servicing is complete, push back in for normal operation.

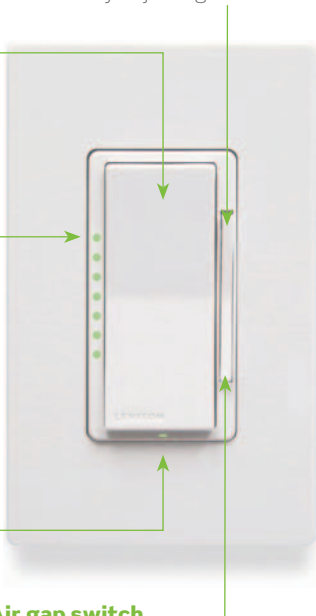

WEB VERSION



Identify your wires

WARNING: TO AVOID FIRE, SHOCK OR DEATH, turn off power at the circuit breaker.

Check your wall box:

1. Remove wallplate and disconnect switch.
2. Restore power. Carefully test wires with voltage tester to find the hot wire.
3. **Turn off power at the circuit breaker.**
4. Mark the wires as shown:

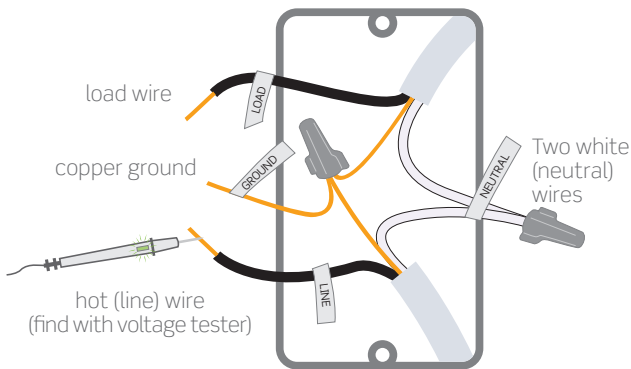

**If your wall box looks different,
call an electrician.**



Wire your dimmer

1. Work on only one connection at a time.
2. Connect wires as shown.
3. Secure wire connections.

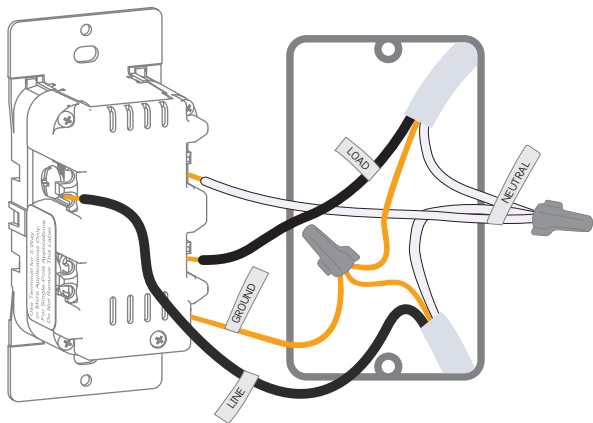

**If your wall box looks different,
call an electrician.**

WEB VERSION



Test and install

1. Restore power. Status light should flash green indicating your dimmer is ready to be enrolled.

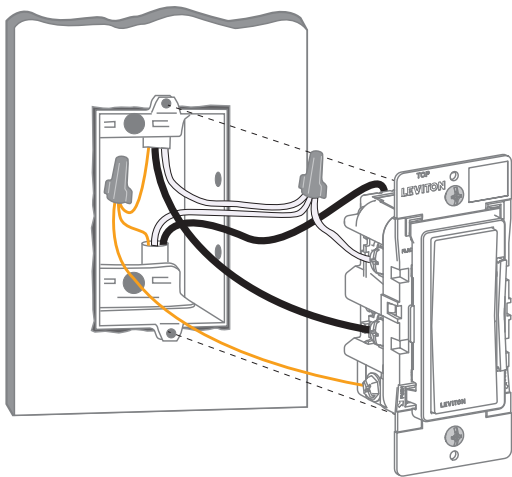

Turn off power at circuit breaker before screwing in your dimmer.

- 2.** Gently push wires into wall box.
Screw dimmer to box.

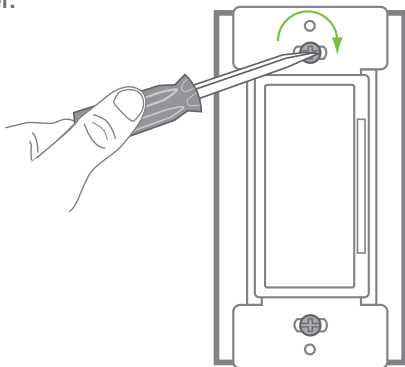

- 3.** Snap on Decora® wallplate.
Restore power.

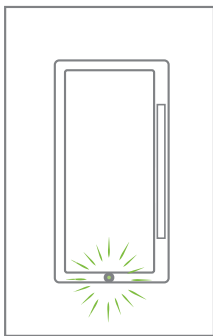

Congratulations!
Your Decora Smart dimmer
is ready to control your light.

WEB VERSION



Get the app

Visit www.my.leviton.com and select the link for your smartphone or tablet.

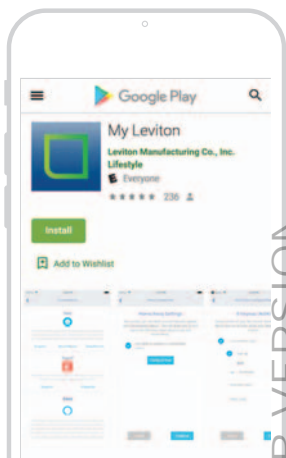
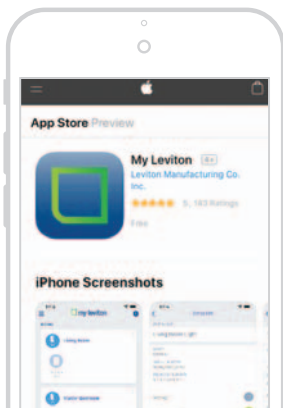

WEB-VERSION



Launch the app



1. Launch the My Leviton app.
2. Log in or choose Sign Up for an Account.
3. Follow the instructions on the screen.



Add to your home network

1. Tap the  in the upper right corner and select Add Device.
2. Follow the app instructions to add your device to your home network.

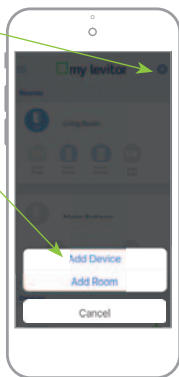

WEB VERSION



Test app control

1. Open the My Leviton app.
2. Tap icon to turn on/off.





Connect to My Leviton partners (optional)

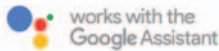

Visit my.leviton.com for a complete list of compatible smart home products.

To add voice control or integrate with another service:

1. Tap menu icon in upper left corner.

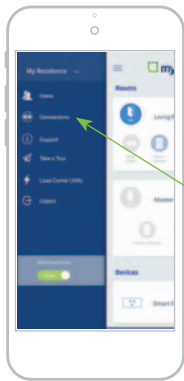

2. Tap Connections, choose desired service and follow app instructions.



WEB VERSION



Diagnostic status light

If your dimmer is not connecting to your My Leviton app, the status light can be used as a diagnostic tool. Press the top of the rocker for at least 2 seconds but less than 7 seconds and release. The light will blink a diagnostic code for two seconds:

- Yellow - the dimmer is not connected to Wi-Fi.
- Red - the dimmer is connected to Wi-Fi but not the My Leviton™ cloud.
- Alternating green/yellow - the dimmer is connected to Wi-Fi and My Leviton cloud but has been unable to set the time from the internet.
- Green - the dimmer is connected to Wi-Fi and My Leviton cloud and is working properly.



Reset

To reset the dimmer to factory settings:

- 1.** Hold the top of the paddle for a total of 14 seconds.
- 2.** After the first 7 seconds the status light turns amber. Continue to hold.
- 3.** After a total of 14 seconds, the status light will quickly flash red/amber.
- 4.** Release the top of the paddle and it will reset.

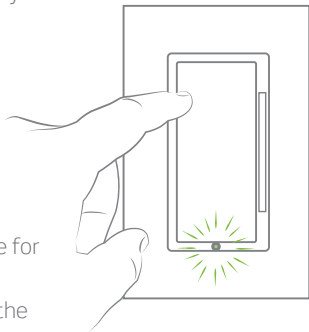



Quick tips

If your dimmer is not performing as expected, visit www.leviton.com/decorasmart or contact technical services.

- When power is applied, the light turns on but the dimmer does not have the ability change the light level.
 - For proper operation the dimmer needs a line, neutral, load and ground connection, confirm the white conductor is a neutral.
- The dimmer does not dim low enough or begins to flicker.
 - In the app devices settings adjust the minimum dim level to the lowest point that does not cause the LED bulb to flicker.



Status light

COLOR	ACTIVITY	STATUS
Green	Slow blink	Ready to be added to a Wi-Fi network
Green	Flash	Connecting to a Wi-Fi network
Green or Off	Solid	Normal operation, can be configured in setup
Amber	Blinking	Device was not able to connect to the Wi-Fi network
Green, Red, Amber	Scrolling	Enrolling to My Leviton or identify feature was triggered in the app
Please see My.Leviton.com support for additional diagnostic assistance		



Safety First

WARNINGS:

- **TO AVOID FIRE, SHOCK, OR DEATH; TURN OFF POWER** at circuit breaker or fuse and test that power is off before wiring!
- **TO AVOID FIRE, PERSONAL INJURY OR PROPERTY DAMAGE, DO NOT** install to control a receptacle, a motor, or transformer operated appliance.
- This product is to be installed and/or used in accordance with electrical codes and regulations.
- For indoor use only.
- If you are unsure about any part of these instructions, consult an electrician.

CAUTIONS

- Use with incandescent, LED, CFL or 120V halogen fixtures only. Use a Leviton electronic low voltage dimmer to control electronic (solid state) low voltage transformers.
- The Decora Smart DW6HD dimmer is not compatible with standard 3-way or 4-way switches. It must be used with up to 4 Decora® Digital DD00R-DL remotes for multi-location dimming.
- Maximum wire length from dimmer to all installed remotes cannot exceed 300 ft.
- Save this instruction sheet. It contains important technical data along with testing and troubleshooting information which will be useful after installation is complete.
- Dimmer may feel warm to the touch during normal operation.
- Recommended minimum wall box depth is 2-3/4".
- Use this dimmer with copper or copper clad wire only.
- Use with compatible dimmable LED, CFL bulbs, incandescent or 120V halogen fixtures only. For a list of compatible LED and CFL bulbs refer to www.leviton.com.
- DO NOT mix bulb types when multiple bulbs are used with one dimmer. All bulbs shall be either LED; CFL or incandescent. Using the same make/model of each bulb will enhance dimmer performance.
- Leviton Wi-Fi enabled devices rely on Wi-Fi communication. Increasing the number of Wi-Fi devices can affect Wi-Fi performance. Consult the network's wireless access point specifications to determine the maximum number of supported Wi-Fi devices. For installations with a large number of Leviton Wi-Fi devices, a high performance wireless access point capable of supporting a large number of devices may be required.

ADDITIONAL RATINGS:

- Purpose of control: Operating Control
- Action Control Type: 1
- Pollution Degree: 2
- Impulse Voltage: 2500V
- Disconnection Type: Micro

Limited 5 Year Warranty

For Leviton's limited product warranty, go to www.leviton.com. For a printed copy of the warranty, call 1-800-824-3005.

FOR CANADA ONLY

For warranty information and/or product returns, residents of Canada should contact Leviton in writing at Leviton Manufacturing of Canada ULC to the attention of the Quality Assurance Department, 165 Hymus Blvd, Pointe-Claire (Quebec), Canada H9R 1E9 or by telephone at 1-800-405-5320.

FCC COMPLIANCE STATEMENT

The enclosed device complies with Part 15 of the FCC Rules. Operation is subject to the following two conditions: (i) This device may not cause harmful interference (ii) This device must accept any interference received, including interference that may cause undesired operation. Any changes or modifications not expressly approved by Leviton could void the user's authority to operate this equipment. This equipment has been tested and found to comply with the limits for a Class B digital device, pursuant to part 15 of the FCC Rules. These limits are designed to provide reasonable protection against harmful interference in a residential installation. This equipment generates uses and can radiate radio frequency energy and, if not installed and used in accordance with the instructions, may cause harmful interference to radio communications. However, there is no guarantee that interference will not occur in a particular installation. If this equipment does cause harmful interference to radio or television reception, which can be determined by turning the equipment off and on, the user is encouraged to try to correct the interference by one or more of the following measures:

- Reorient or relocate the receiving antenna.
- Increase the separation between the equipment and receiver.
- Connect the equipment into an outlet on a circuit different from that to which the receiver is connected.
- Consult the dealer or an experienced radio/TV technician for help.

FCC CAUTION

Any changes or modifications not expressly approved by Leviton Manufacturing Co., Inc., could void the user's authority to operate the equipment.

FCC SUPPLIER'S DECLARATION OF CONFORMITY:

Model DW6HD - Wi-Fi Dimmer is manufactured by Leviton Manufacturing Co., Inc. 201 N. Service Road, Melville, NY 11747. www.leviton.com This device complies with part 15 of the FCC Rules. Operation is subject to the following two conditions: (1) This device may not cause harmful interference, and (2) this device must accept any interference received, including interference that may cause undesired operation.

IC STATEMENT

This device complies with Industry Canada license-exempt RSS standard(s). Operation is subject to the following two conditions: (1) this device may not cause interference, and (2) this device must accept any interference, including interference that may cause undesired operation of the device.

RF EXPOSURE AND CO-LOCATION:

To comply with FCC OET Bulletin 65 and ISED RF exposure limits for general population and uncontrolled exposure, this device shall be installed and operated with a minimum distance of 7.9 inches (20 cm) between the radiator and your body. Also, must not be co-located or operated in conjunction with any other antenna or transmitter.

Copyright and Trademark Information

Decora Smart is a trademark of and Decora is a registered trademark of Leviton Manufacturing Co., Inc. Google Play, Android, App Store, Apple iOS and Google Assistant are the trademarks of their respective owners and any use of such marks by Leviton is under license. Alexa, and related logos are trademarks of Amazon.com, Inc. or its affiliates. Wi-Fi CERTIFIED logo is a trademark of the Wi-Fi Alliance. Use herein of other third party trademarks, service marks, trade names, brand names and/or product names are for informational purposes only, are/may be the trademarks of their respective owners; such use is not meant to imply affiliation, sponsorship, or endorsement. No part of this document may be reproduced, transmitted or transcribed without the express written permission of Leviton Manufacturing Co., Inc.

Copyright 2020 Leviton Mfg. Co., Inc.

If you need help...



CALL

1-800-824-3005 (USA)

1-800-405-5320 (Canada)



ONLINE

leviton.com/decorasmart



CHAT

www.leviton.com



EMAIL

dssupport@leviton.com

Leviton Manufacturing Co., Inc.
201 North Service Road, Melville, NY 11747
Telephone: 1-800-824-3005

Visit Leviton's website at <http://www.leviton.com>
© 2020 Leviton Manufacturing Co., Inc. All rights reserved.

Specifications subject to change at any time without notice.

WEB VERSION