

M11293 1

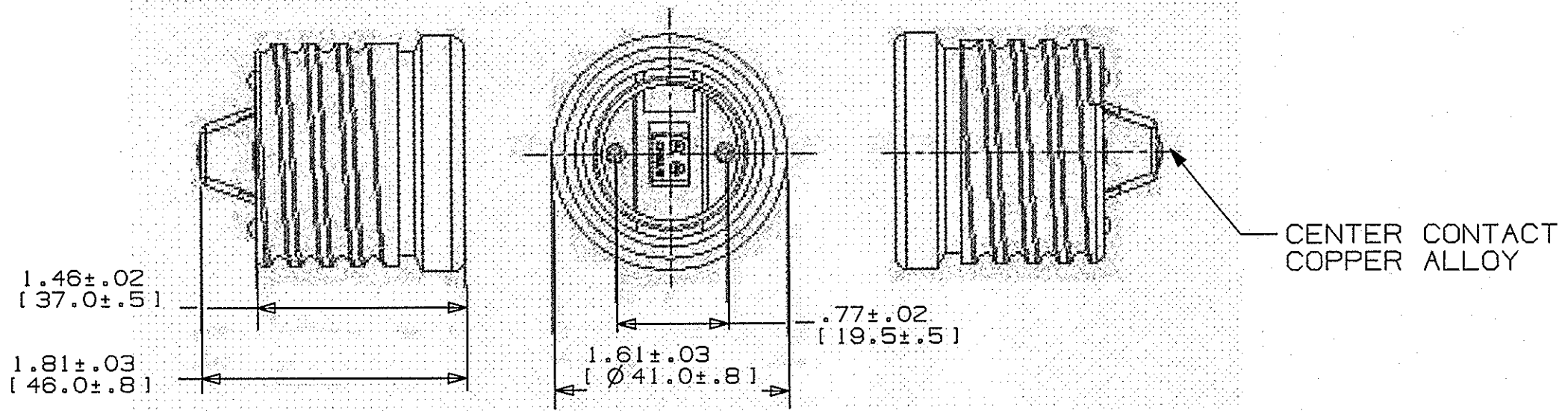

CENTER CONTACT
COPPER ALLOY

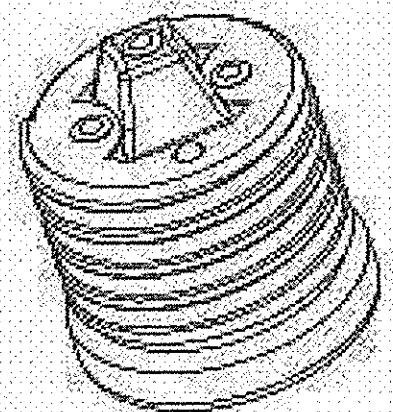

NOTES:

ADAPTER CONVERTS MOGUL BASE TO MEDIUM BASE.

- DIMENSIONS ARE INCHES [mm].
- INNER SCREW SHELL COMPLIES TO MEDIUM BASE LAMPHOLDER ANSI-C81.10 STD2-11-1 AND IEC E26. OUTER SCREW SHELL COMPLIES TO MOGUL SCREW BASE E39.
- UL, cUL LISTED.
- RATED 660W MAX., 250V MAX.
- PACKAGING: PRODUCT PLACED IN BOX.

LIST OF PARTS

DESCRIPTION	MATERIAL	FINISH
BASE	PORCELAIN	WHITE
SCREW SHELL	ALUM	

DIMENSION SHEET FOR CAT. NO. **RL154** REPAIRABLE NON-REPAIRABLE **B** M11293 1

1	12/01/09 RELEASE TO PRODUCTION PER DCN 16198	CAC	
SYM	REVISIONS	APP	DATE

THE DESIGN AND DIMENSIONS OF THE PRODUCT SHOWN ON THIS DRAWING ARE SUBJECT TO CHANGE WITHOUT NOTICE

TITLE
ADAPTER INCANDESCENT SOCKET MOGUL TO MEDIUM BASE PORCELAIN

TOLERANCES UNLESS OTHERWISE SPECIFIED FRACTIONS ± 1/64 DECIMALS ± .005 ANGLES ± 2°	WIRING DEVICE-KELLEMS HUBBELL INCORPORATED BRIDGEPORT, CT	
	DR. BY DLI	APP. BY CAC
	TR. BY	SCALE NONE
	CHK'D BY	DATE 04/01/09