

CATALOG NO	COVER CATALOG NO	ACCOMMODATES		FIG	DIMENSIONS						INSTALLATION TOOLING (# CRIMPS)					DIELESS (# CRIMPS)	WIRE STRIP LENGTH							
		AL: CLASS B CU: CLASS B, C	COPPER FLEX		B	LL	L	O.D.	O.D.P	P	COLOR CODE	DIE INDEX	35, 750 SERIES	46 SERIES	MD6									
AYP6	AYP6C	#6 AWG	#8 AWG CLASS I, DLO	1					0.23 [6]															
AYP4	AYP6C	#4 AWG	#6 AWG CLASS I, DLO	1				1.85 [47]																
AYP2	AYP6C	#2 AWG	#4 AWG CLASS I, DLO	1	1.00 [25]	2.03 [52]		0.60 [15]						TAN	296	S		W241 (2)						
AYP1	AYP6C	#1 AWG	#2 AWG CLASS I, DLO	1				2.01 [51]																
AYP1/0	AYP6C	1/0 AWG	#1 AWG CLASS I, DLO	1					0.26 [7]															
AYP1/0	AYP6C	1/0 AWG	#1 AWG CLASS I, DLO	1					0.29 [7]															
AYPO2/0	AYPO26C	2/0 AWG	1/0 AWG CLASS I, DLO	2				2.70 [69]																
AYPO3/0	AYPO26C	3/0 AWG	2/0 AWG CLASS I, DLO	2	1.11 [28]	2.44 [62]		.86 [22]						WHITE	298	U28ART (2)		W660 (4)						
AYPO4/0	AYPO26C	4/0 AWG	3/0 AWG CLASS I, DLO	2				2.80 [71]																
AYP250	AYP250C	250 KCMIL	4/0 AWG, CLASS I,K,M, DLO	1				2.63 [67]																
AYPO250	AYPO250C			2						2.98 [76]														
AYPO300	AYPO250C	300 KCMIL	250 KCMIL CLASS I, 262 DLO	2				2.88 [65]	3.08 [78]	1.10 [28]	0.53 [14]			BROWN	299	U31ART (2)						644 (1) 444 (1) 81KFT (2)		
AYP350	AYP250C	350 KCMIL	313 KCMIL DLO	1				2.75 [70]																
AYPO350	AYPO250C			2	1.07 [27]					3.08 [78]														
AYPO400	AYPO400C	400 KCMIL	--	2				3.43 [87]																
AYP500	AYP400C	500 KCMIL	350 KCMIL CLASS I, 373 DLO	1		3.18 [81]		3.08 [78]		1.31 [33]		0.68 [17]		PINK	300	U34ART (2)								
AYPO500	AYPO400C			2						3.43 [87]														
AYPO600	AYPO900C	600 KCMIL	444 KCMIL DLO	2				4.02 [102]																
AYP750	AYPO900C	750 KCMIL 900 KCMIL AL CMPT	535 KCMIL DLO	1	1.59 [40]	4.06 [103]		3.79 [96]		1.46 [37]		0.81 [21]	1.76 [45]	YELLOW	936 HEX	U39ART (3)						644 (1) 444 (1) 81KFT (3)		
AYPO750	AYPO900C			2					4.16 [106]															
AYPO900	AYPO900C	900 KCMIL	--	2	2.17 [55]	4.12 [105]		4.27 [108]	1.50 [38]	0.91 [23]	1.82 [46]			GREY	303	U42ART (4)						644 (2) 444 (2)		
AYPO1000	AYPO8001000	1000 KCMIL	777 KCMIL DLO	2	1.59 [40]	4.09 [104]		4.17 [106]	1.84 [47]	.81 [21]	1.76 [45]			--	--	--						644MBH (1) 444 (1)		

REV	DATE	DESCRIPTION	ECO	BY	C'H.K.
D	11/08/2021	MU UPDATION	210816011303	SS	YR

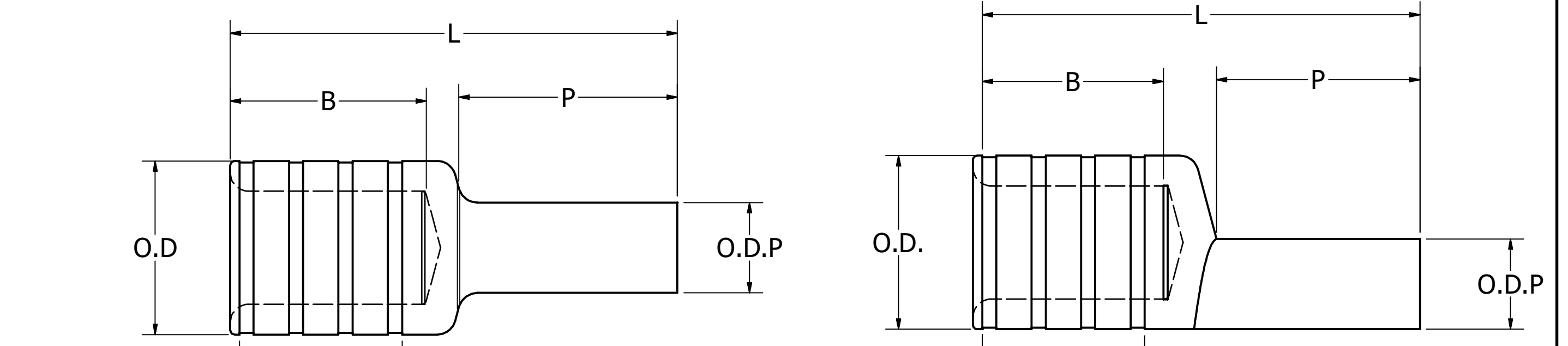

**Figure -1**

**Figure -2**

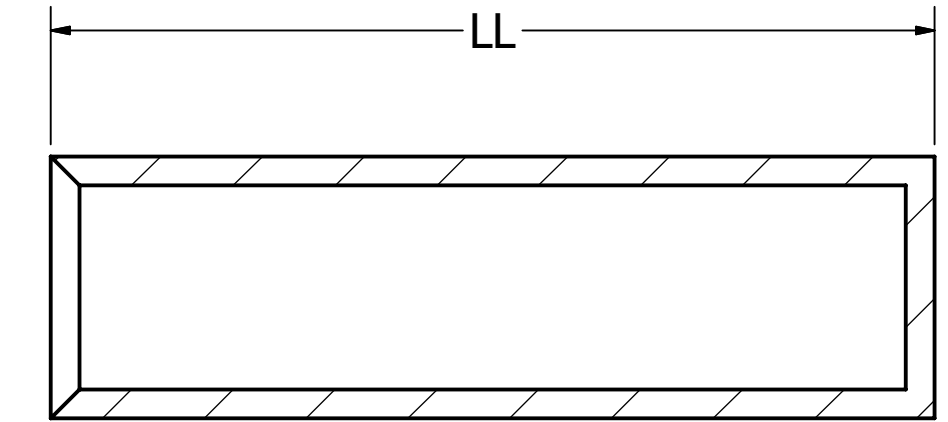

INSULATION COVER

- NOTES:
- TIN PLATED ALUMINUM COMPRESSION PIN ADAPTER.
  - CONNECTION: COMPRESSION CONNECTIONS ARE MADE IRREVERSIBLE AND MAINTENANCE FREE.
  - APPLICABLE STANDARDS: CONNECTORS ARE ONLY UL LISTED AND CSA CERTIFIED WHEN INSTALLED WITH THE BURNDY ENGINEERED SYSTEM AND SELECT OTHER CRIMP TOOL MANUFACTURERS IN ACCORDANCE WITH ONE OR MORE UL CATEGORIES. UL LISTED AND CSA CERTIFIED WIRE-CONNECTOR ADAPTERS. TESTED IN ACCORDANCE TO UL 486A-486B / CSA C22.2 NO.65
  - TEMPERATURE AND VOLTAGE RATING:
    - A. UP TO 35KV WITHOUT COVER. CONNECTORS ARE MARKED AL9CU TO DENOTE ALUMIUM(AL) OR COPPER (CU) WIRE UP TO 90°C.
    - B. ONE COVER SUPPLIED WITH THE CONNECTOR.
    - C. RATED 600 VOLT UP TO 90°C.
    - D. MADE FROM THE FOLLOWING MATERIALS: EPDM RUBBER, SANTOPRENE, OR PVC.
  - WIRE ACCOMMODATE TYPES (SEE TABLE): DUAL RATED TO ACCOMMODATE ALUMINUM AND COPPER WIRE.
    - A. ALUMINUM WIRE (AL): CLASS B (CONCENTRIC, COMPRESSED, COMPACT)
    - B. COPPER WIRE (CU): CLASS B (CONCENTRIC, COMPRESSED, COMPACT) OR CLASS C.
    - C. COPPER FLEX (CU): SEE TABLE FOR APPLICABLE WIRE CLASSES.
  - FEATURES:
    - A. SOLID PIN DESIGN ELIMINATES "HOW TIGHT IS TIGHT" TORQUE REQUIREMENT PROBLEM AND ELIMINATES OVER TORQUING ON STRANDED PIN ADAPTERS THAT COULD DAMAGE THE PIN AND CONNECTION.
    - B. SOLID PIN IS RATED FOR THE FULL AMPACITY OF THE INCOMING CONDUCTOR.
    - C. INLINE AND OFFSET PIN DESIGNS ARE AVAILABLE. OFFSET PIN DESIGN PROVIDES ADDED FLEXIBILITY IN LIMITED SPACE APPLICATIONS AS THE CONNECTORS CAN BE ROTATED.
    - D. BARREL TYPICAL ROLL MARKINGS (AS SPACE PERMITS): CRIMP ZONE IS INDICATED BY KNURL BANDS, BURNDY CORPORATE NAME OR LOGO, UL LOG (IF APPLICABLE), CSA LOGO (IF APPLICABLE), WIRE SIZE, DIE COLOR CODE, INDEX NUMBER.
    - E. BARREL DESIGN: BARREL END AT THE WIRE HAS AN INTERNAL FLARE, ALLOWING FOR SMOOTH WIRE INSERTION.
    - F. PRE-FILLED WITH PENETROX™A13, WHICH IS AN OXIDE INHIBITOR.
    - G. COLOR-CODED END CAPS TO MATCH THE DIE COLOR CODE. THIS ALSO PREVENTS PARTICLES FROM ENTERING THE BARREL.
  - INSTALLATION TOOLING AND DIES ARE CONSTANTLY BEING UPDATED. FOR THE LATEST INSTALLATION TOOLING INFORMATION, REFER TO THE MASTER CATALOG ON THE BURNDY WEBSITE.
  - DIMENSIONS IN BRACKETS [ ] ARE IN MILLIMETERS ROUNDED OFF TO THE NEAREST MILLIMETER, UNLESS OTHER SPECIFIED AND ARE FOR REFERENCE ONLY.
  - FOR PROPER INSTALLATION INSTRUCTIONS, SEE PRODUCT INSTALLATION GUIDE ON THE LAST SHEET.
  - NOT UL LISTED OR CSA CERTIFIED WITH THESE DIES.

TO ORDER BURNDY® PRODUCTS CALL		HYLINK™	
UNITED STATES			
1-800-346-4175 (LONDONDERRY, NH)			
CANADA:			
1-800-361-6975 (QUEBEC)			
1-800-387-6487 (ALL OTHER PROVINCES)			
FOR PRODUCT INFO: <a href="http://www.burndy.com">http://www.burndy.com</a>			
ITEM NO: SEE TABLE		DRAWING NO	
CAT. NO: SEE TABLE		REV	
DRAWN BY: ESK	08/24/1972		D
CHECKER: SFP	08/25/1972		
DSN APRVL: D.C.W.	12-12-1972		
MFG APRVL: --			
QA APRVL: D VARIO	07-25-1995	PROJECT #: --	
MKT APRVL: P WERTHMAN	04-17-1995	SIZE	
PROJ FAM: 50103891		D	50103891
PROJ #: --			SHEET 1 OF 3
DOCUMENT TYPE: SALES			
REL LEVEL: Released			

Catalog Number	Wire Accommodates		Wire Strip Length	Color Code and Die Index Number	Hydraulic Tools - Dies Required			Hydraulic Tools - Dieless			
	AL: Class B CU: Class B,C	Copper Flex			750, 35 Series	45 Series <i>Use PT6515 with U Dies</i>	46 Series <i>Use PUADP1 with U Dies</i>	81K, 4PC Series	644 Series	644MBH	444S Series
AYP6	6 AWG	8 AWG CLASS I, DLO	1-1/16"	Tan 296	U25ART (1)	U25ART (1)	U25ART (1)	1 CRIMP	1 CRIMP	1 CRIMP	1 CRIMP
AYP4	4 AWG	6 AWG CLASS I, DLO	1-1/16"	Tan 296	U25ART (1)	U25ART (1)	U25ART (1)	1 CRIMP	1 CRIMP	1 CRIMP	1 CRIMP
AYP2	2 AWG	4 AWG CLASS I, DLO	1-1/16"	Tan 296	U25ART (1)	U25ART (1)	U25ART (1)	1 CRIMP	1 CRIMP	1 CRIMP	1 CRIMP
AYP1	1 AWG	2 AWG CLASS I, DLO	1-1/16"	Tan 296	U25ART (1)	U25ART (1)	U25ART (1)	1 CRIMP	1 CRIMP	1 CRIMP	1 CRIMP
AYP1/0	1/0 AWG	1 AWG CLASS I, DLO	1-1/16"	Tan 296	U25ART (1)	U25ART (1)	U25ART (1)	1 CRIMP	1 CRIMP	1 CRIMP	1 CRIMP
AYPO2/0	2/0 AWG	1/0 AWG CLASS I, DLO	1-1/8"	White 298	U28ART (2) OVERLAPPING	U28ART (2) OVERLAPPING	U28ART (2) OVERLAPPING	2 CRIMPS	1 CRIMP	1 CRIMP	1 CRIMP
AYPO3/0	3/0 AWG	2/0 AWG CLASS I, DLO	1-1/8"	White 298	U28ART (2) OVERLAPPING	U28ART (2) OVERLAPPING	U28ART (2) OVERLAPPING	2 CRIMPS	1 CRIMP	1 CRIMP	1 CRIMP
AYPO4/0	4/0 AWG	3/0 AWG CLASS I, DLO	1-1/8"	White 298	U28ART (2) OVERLAPPING	U28ART (2) OVERLAPPING	U28ART (2) OVERLAPPING	2 CRIMPS	1 CRIMP	1 CRIMP	1 CRIMP
AYP250	250 kcmil	4/0 AWG CLASS I,K,M,DLO	1-1/8"	Brown 299	U31ART (2) OVERLAPPING	U31ART (2) OVERLAPPING	U31ART (2) OVERLAPPING	2 CRIMPS	1 CRIMP	1 CRIMP	1 CRIMP
AYPO250	250 kcmil	4/0 AWG CLASS I,K,M,DLO	1-1/8"	Brown 299	U31ART (2) OVERLAPPING	U31ART (2) OVERLAPPING	U31ART (2) OVERLAPPING	2 CRIMPS	1 CRIMP	1 CRIMP	1 CRIMP
AYPO300	300 kcmil	250 kcmil CLASS I, 262 DLO	1-1/8"	Brown 299	U31ART (2) OVERLAPPING	U31ART (2) OVERLAPPING	U31ART (2) OVERLAPPING	2 CRIMPS	1 CRIMP	1 CRIMP	1 CRIMP
AYP350	350 kcmil	313 kcmil DLO	1-1/8"	Brown 299	U31ART (2) OVERLAPPING	U31ART (2) OVERLAPPING	U31ART (2) OVERLAPPING	2 CRIMPS	1 CRIMP	1 CRIMP	1 CRIMP
AYPO350	350 kcmil	313 kcmil DLO	1-1/8"	Brown 299	U31ART (2) OVERLAPPING	U31ART (2) OVERLAPPING	U31ART (2) OVERLAPPING	2 CRIMPS	1 CRIMP	1 CRIMP	1 CRIMP
AYPO400	400 kcmil	--	1-1/8"	Pink 300	U34ART (2)	U34ART (2)	U34ART (2)	2 CRIMPS	1 CRIMP	1 CRIMP	1 CRIMP
AYP500	500 kcmil	350 kcmil CLASS I, 373 DLO	1-1/8"	Pink 300	U34ART (2)	U34ART (2)	U34ART (2)	2 CRIMPS	1 CRIMP	1 CRIMP	1 CRIMP
AYPO500	500 kcmil	350 kcmil CLASS I, 373 DLO	1-1/8"	Pink 300	U34ART (2)	U34ART (2)	U34ART (2)	2 CRIMPS	1 CRIMP	1 CRIMP	1 CRIMP
AYPO600	600 kcmil	444 kcmil DLO	1-3/4"	Yellow 936	U39ART (3)	U39ART (3)	U39ART (3)	3 CRIMPS	1 C RIMP	1 C RIMP	1 CRIMP
AYP750	750 kcmil	535 kcmil DLO	1-3/4"	Yellow 936	U39ART (3)	U39ART (3)	U39ART (3)	3 CRIMPS	1 C RIMP	1 C RIMP	1 CRIMP
	900 kcmil AL CMPT				--	--	--	1 C RIMP	1 C RIMP	1 CRIMP	
AYPO750	750 kcmil	535 kcmil DLO	1-3/4"	Yellow 936	U39ART (3)	U39ART (3)	U39ART (3)	3 CRIMPS	1 C RIMP	1 C RIMP	1 CRIMP
	900 kcmil AL CMPT				--	--	--	1 C RIMP	1 C RIMP	1 CRIMP	
AYPO900	900 kcmil	--	1-3/4"	Grey 303	U42ART (4)	--	--	2 CRIMPS	1 CRIMP	2 CRIMPS	
AYPO1000	1000 kcmil	777 kcmil DLO	1-3/4"	--	--	--	--	--	1 CRIMP	1 CRIMP	

TO ORDER BURNDY® PRODUCTS CALL		HYLINK™					
UNITED STATES 1-800-346-4175 (LONDONDERRY, NH)		ITEM NO: SEE TABLE					
CANADA: 1-800-361-6975 (QUEBEC) 1-800-387-6487 (ALL OTHER PROVINCES)		CAT. NO: SEE TABLE					
FOR PRODUCT INFO: <a href="http://www.burndy.com">http://www.burndy.com</a>		DRAWN BY: ESK 08/24/1972					
		CHECKER: SFP 08/25/1972					
		DSN APRVL: D.C.W. 12-12-1972					
		MFG APRVL: --					
		QA APRVL: D VARIO 07-25-1995					
		MKT APRVL: P WERTHMAN 04-17-1995					
		PROD FAM: 50103891					
REV	DATE	DESCRIPTION	ECO	BY	C'H'K.	DRAWING NO	REV
D	11/08/2021	MU UPDATION	210816011303	SS	YR	50103891	D
						PROJECT #: --	SIZE
						DOCUMENT TYPE: SALES	D
						REL LEVEL: Released	SHEET 2 OF 3

## Installation Instructions:

Installation instructions help the installer understand proper wire preparation, proper insertion requirements, crimp zone location, individual crimp location, crimp order and crimp direction, to ensure safe and reliable wire connections. In order to obtain a UL Listing BURNDY certifies its products using the BURNDY Engineered System and select other crimp tool manufacturers in accordance with one or more UL categories.

**Installation Steps:** \*For simplicity, the images show an inline pin, however, connectors are available in offset pins.

1. Select the appropriate connector based on:

- Wire Material
- Wire Construction
- Wire Size

2. Strip the insulation to the appropriate wire strip length, based on the table's Wire Strip Length recommendation for the selected connector.

3. Wire brush the bare conductor to remove any oxides. DO NOT wire brush plated connectors.

4. Insert the conductor into the barrel for the full length. The connector barrel is filled with PENETROX™ A13, so be aware of the following:

Oxide inhibitor may discharge from the barrel when wire is fully inserted.

Oxide inhibitor may cause resistance that could feel like the wire is fully inserted. Ensure you insert the wire with enough force to penetrate the oxide inhibitor barrier until you reach the full wire insertion distance.

5. Apply the proper number of crimps based on the installation tooling requirements. Use the illustrations as a guide on crimp placement and direction for the proper number of crimps.

6. Remove excess PENETROX™ A13 that may discharge during installation.

REV	DATE	DESCRIPTION	ECO	BY	C'H'K.
D	11/08/2021	MU UPDATION	210816011303	SS	YR

CATALOG NUMBER DESIGNATIONS					
AYP6	AYP4	AYP2	AYP1	AYP1/0	AYP2/0
AYPO3/0	AYPO4/0	AYP250	AYPO250	AYPO300	AYP350

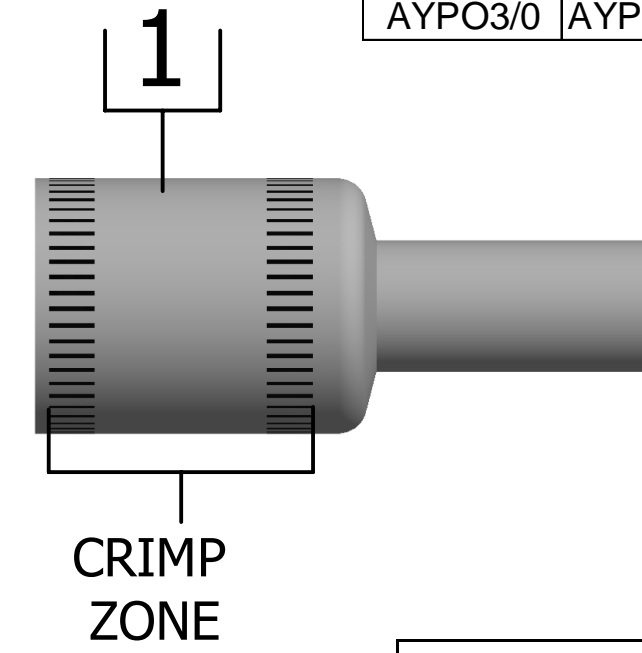

CRIMP ZONE

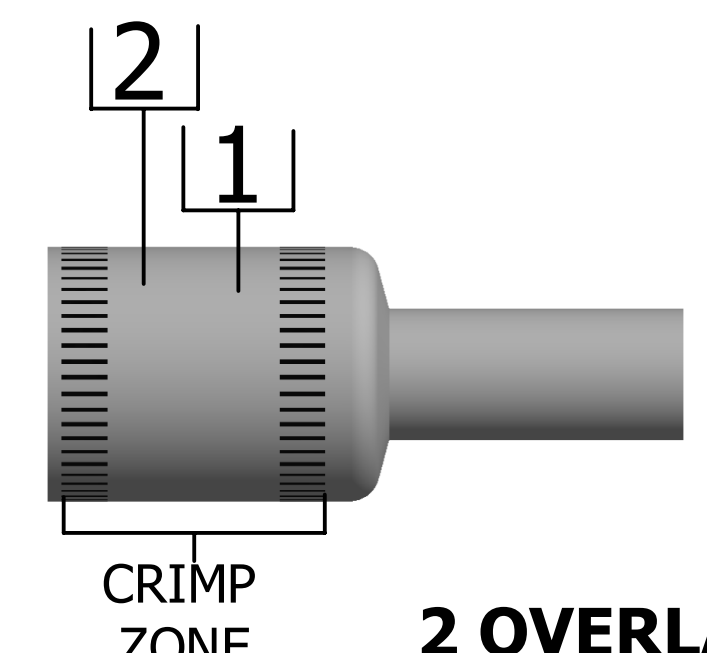

CRIMP ZONE

**2 OVERLAPPING**

CATALOG NUMBER DESIGNATIONS		
AYPO400	AYP500	AYPO500

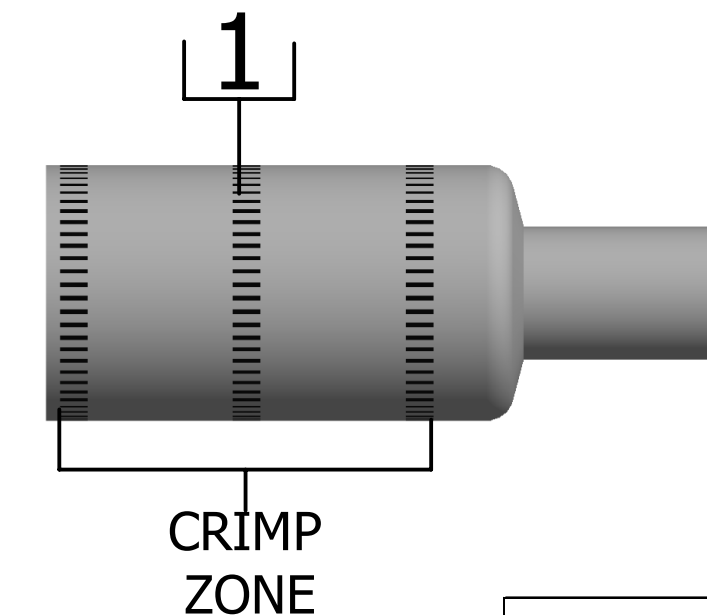

CRIMP ZONE

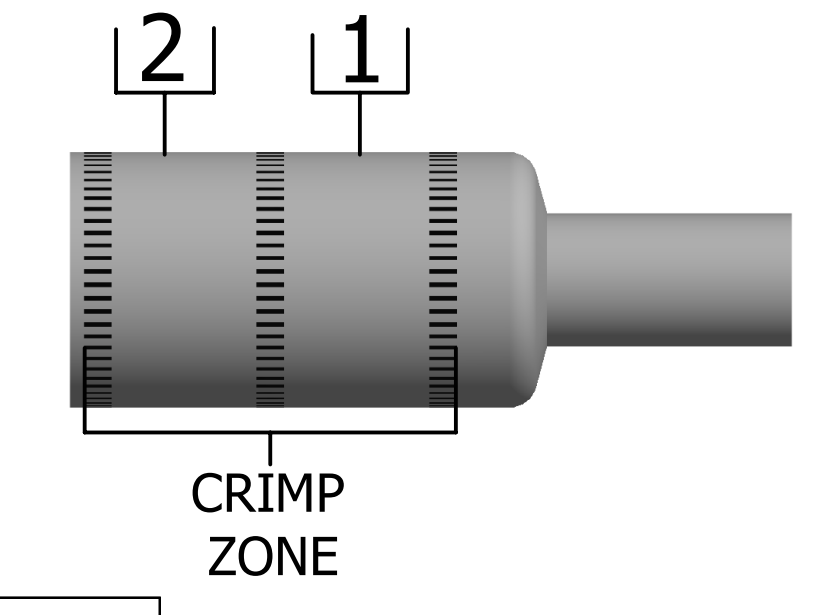

CRIMP ZONE

CATALOG NUMBER DESIGNATIONS			
AYPO600	AYP750	AYPO750	AYPO1000

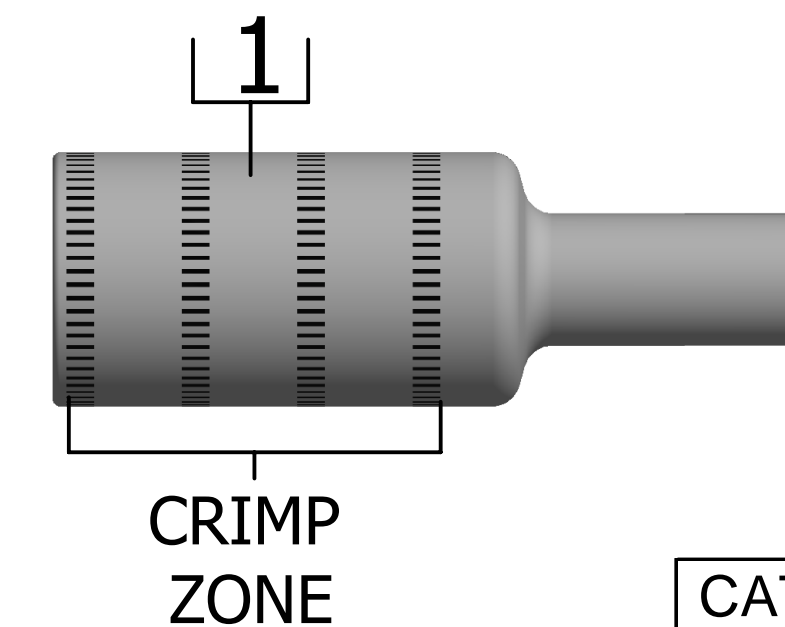

CRIMP ZONE

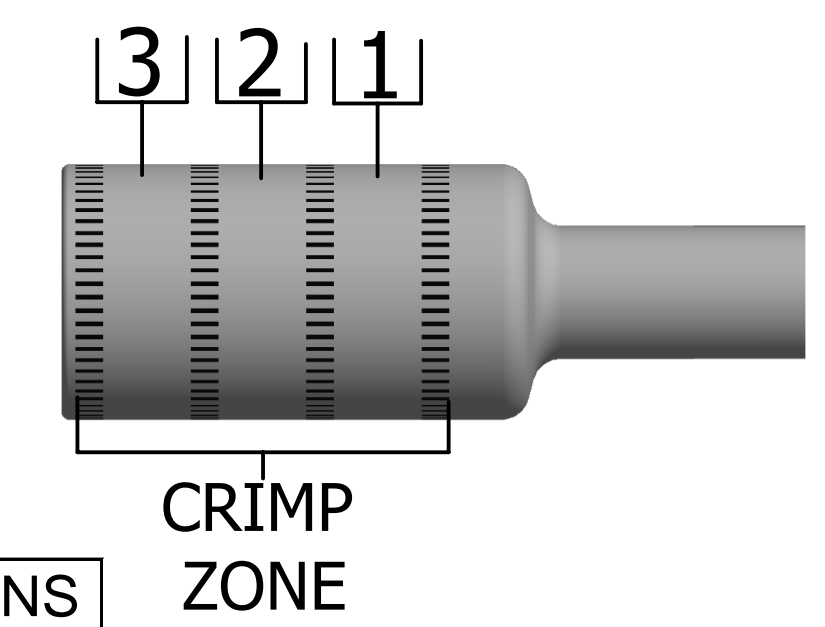

CRIMP ZONE

CATALOG NUMBER DESIGNATIONS	
AYP900	AYP0900

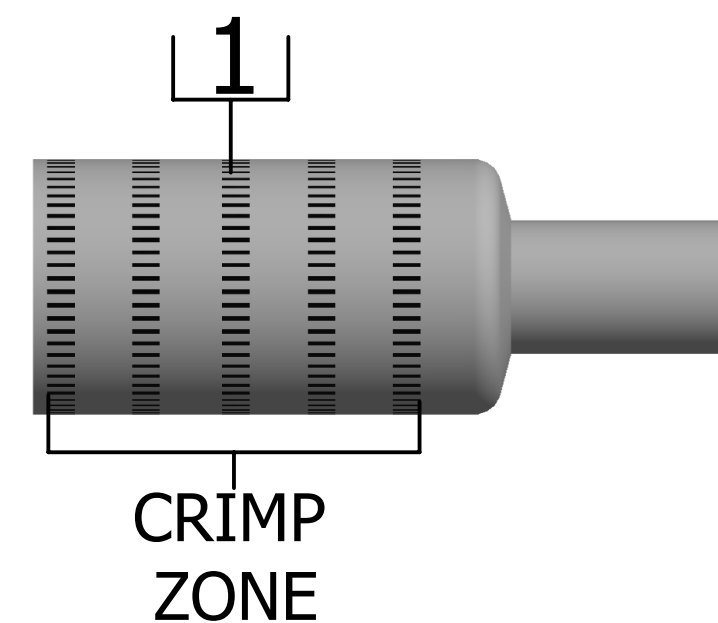

CRIMP ZONE

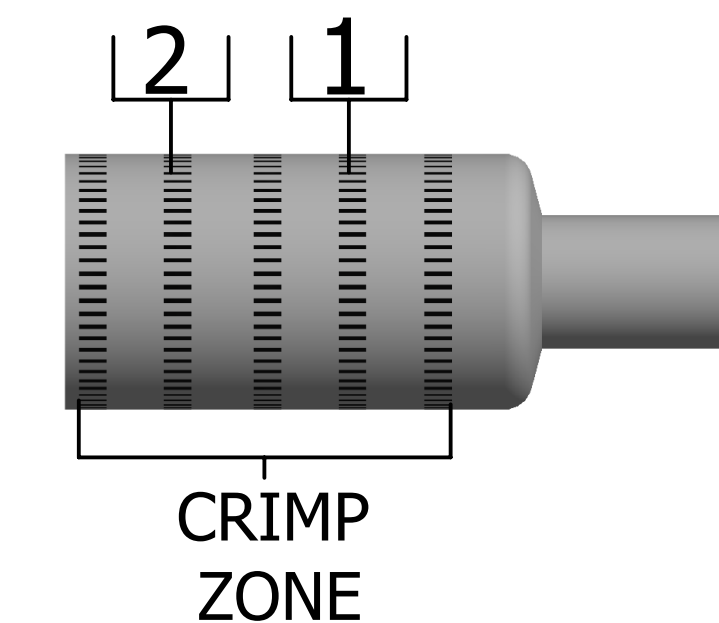

CRIMP ZONE

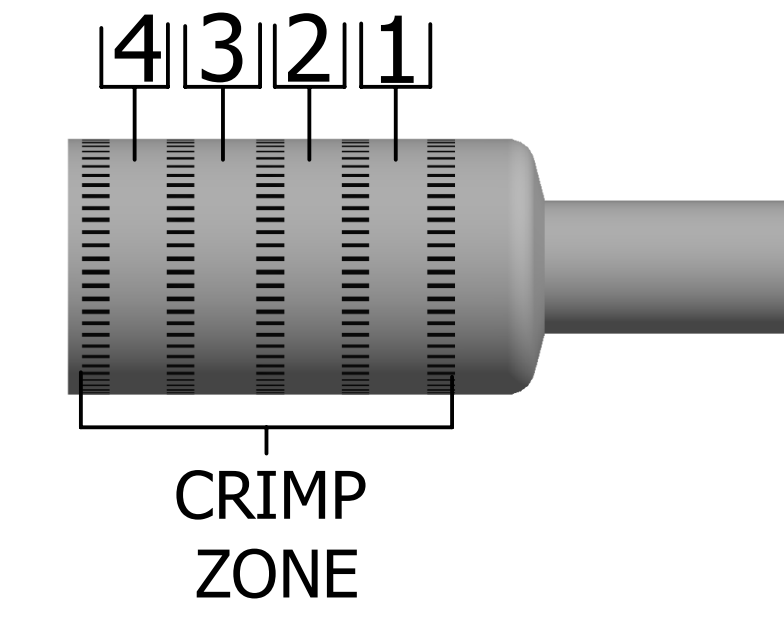

CRIMP ZONE

TO ORDER BURNDY® PRODUCTS CALL		HYLINK	
UNITED STATES 1-800-346-4175 (LONDONDERRY, NH)		ITEM NO: SEE TABLE	
CANADA: 1-800-361-6975 (QUEBEC) 1-800-387-6487 (ALL OTHER PROVINCES)		CAT. NO: SEE TABLE	
FOR PRODUCT INFO: <a href="http://www.burndy.com">http://www.burndy.com</a>		DRAWN BY: ESK	08/24/1972
		CHECKER: SFP	08/25/1972
		DSN APRVL: D.C.W.	12-12-1972
		MFG APRVL: --	
		QA APRVL: D VARIO	07-25-1995
		MKT APRVL: P WERTHMAN	04-17-1995
		PROD FAM: 50103891	
		PROJECT #: --	SIZE
		DOCUMENT TYPE: SALES	D
		REL LEVEL: Released	
		DRAWING NO	REV
		50103891	D
		SHEET 3 OF 3	

