

FITTINGS

MC2X SERIES

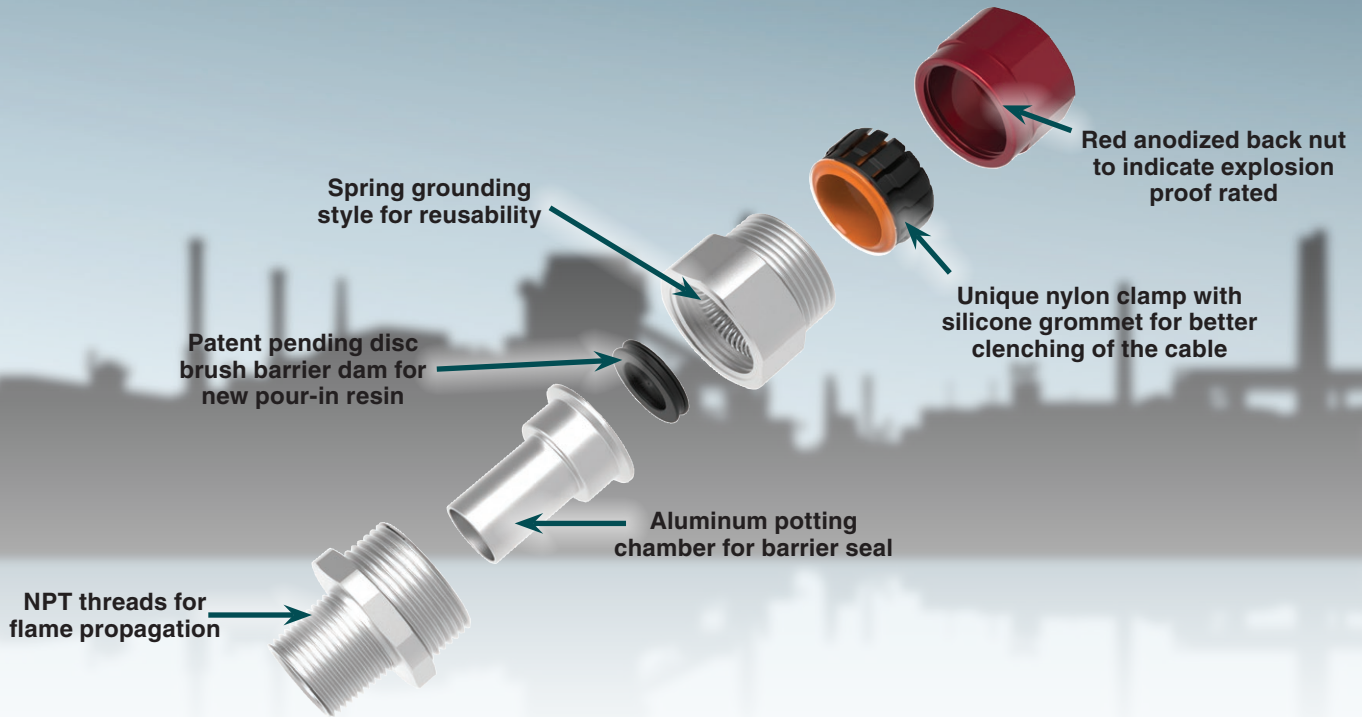

CONSTRUCTION DETAILS



WHEN AN INTERNAL EXPLOSION OCCURS...

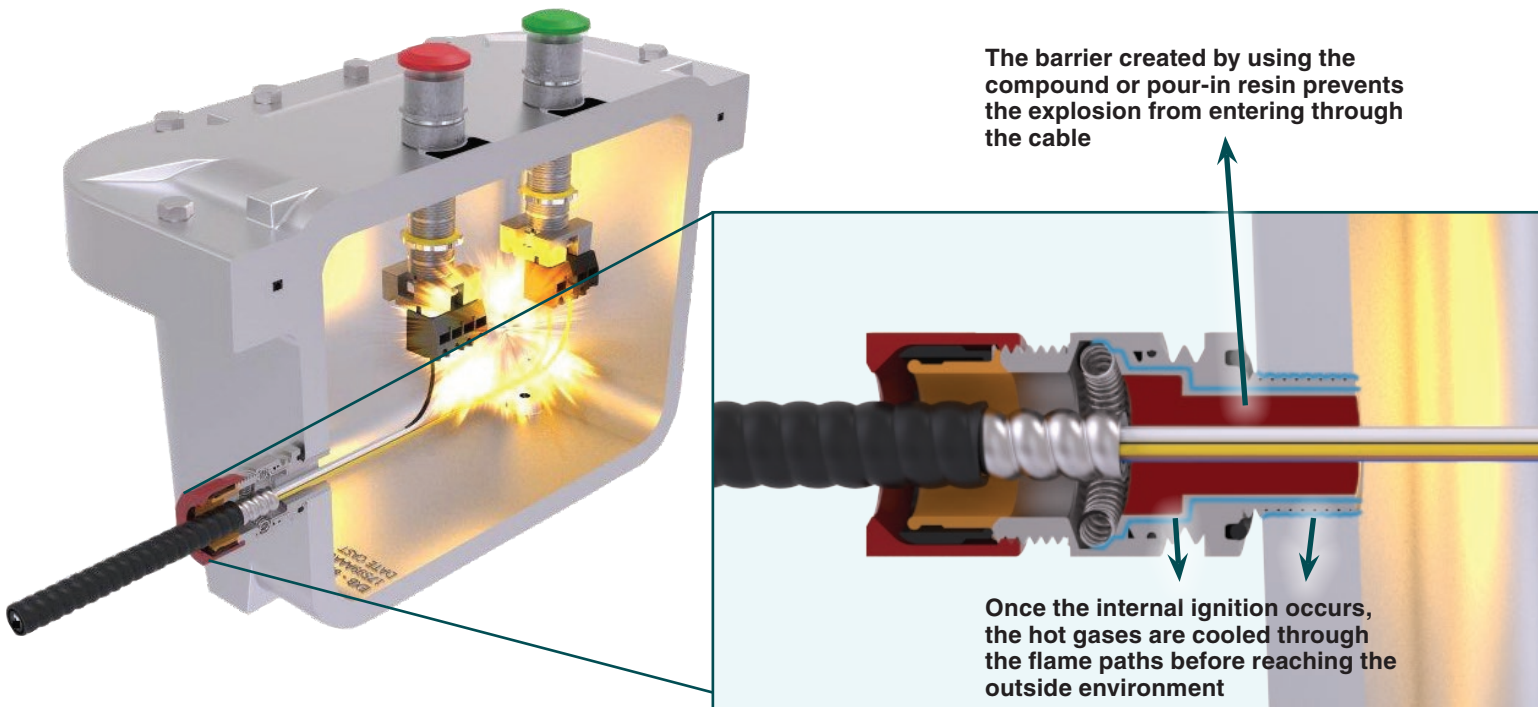



MC2X SERIES

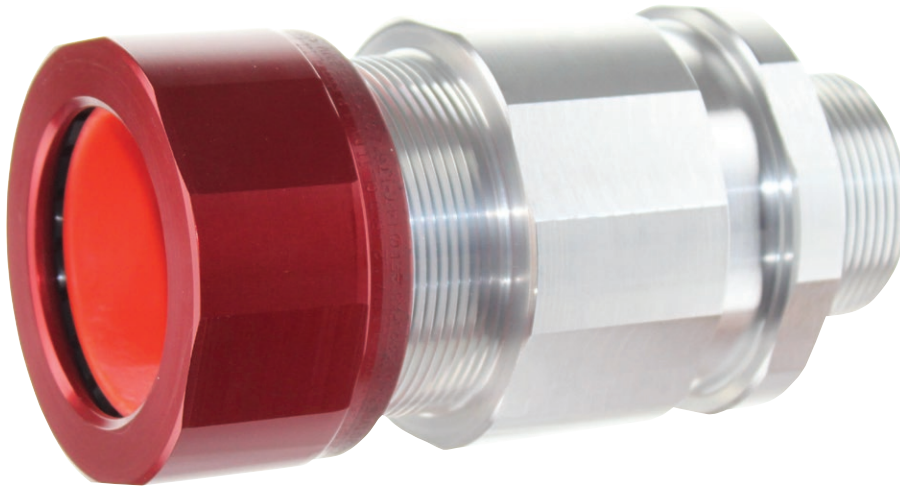

Class I, Div. 1 & 2, Groups A, B, C, D
Class II, Div. 1 & 2, Groups E, F, G
Class III

Class I, Zone 1, Groups IIC, Zone 20
Type 3, 4, 4X, 6, IP66, IPX8 6ft/1hr

 -50°C to 60°C

FEATURES-SPECIFICATIONS

Features

- Used exclusively as a barrier gland for armored and unarmored cable
- New patent pending disc brush dam allows for Hawke EXpress & CELOX resin as a barrier solution
- Uses a stainless-steel grounding spring for reusability
- Red anodized backnut to indicate it is for hazardous explosive areas
- Enhanced middle nut design to allow for better ingress protection and non-exposed threads
- Hand putty comes standard for barrier solution
- Liquid resin barrier solution is sold separately. For more information, see feature page about the resin.

Materials

- Body – Copper-free aluminum
- O-ring – silicone
- Sealing Clamp – nylon
- Sealing Grommet – silicone
- Disc brush – steel channel/nylon fibers
- Disc Grommet – neoprene
- Spring – stainless-steel

FITTINGS

MC2X SERIES

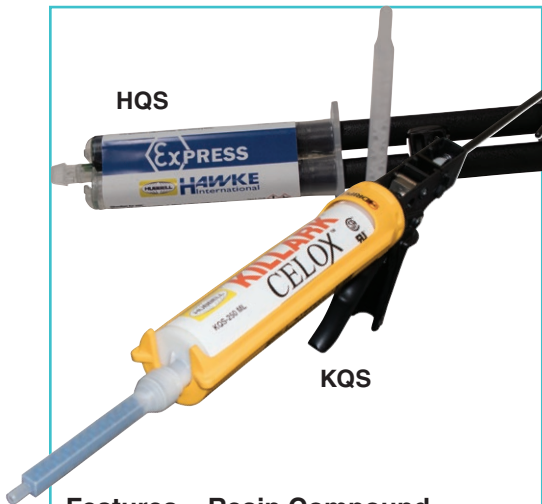

Features – Resin Compound

- Two-part epoxy resin that is self-mixed through a static nozzle
- Easy to use syringe and caulk style dispensers that eliminates any hand mixing and prepping
- Eliminates excess waste as each tube is reusable and comes with additional nozzles
- Fast curing formula that allows for same day installation and energization of equipment
- Various resin sizes available for multiple gland installs



SEALING METHOD	
CATALOG NUMBER	SIZE PACKAGE
HQS-014 ML	14ml (.47oz)
HQS-024 ML	24ml (81oz)
HQS-050 ML	50ml (1.70oz)
KQS-250 ML	250ml (8.45oz)

SUITABLE ARMORED & UNARMORED CABLE TYPES	
AC-	AC90, ACWU90, AC90-HL, ACWU90-HL, ACG90, ACGWU90
MC-	MCC, MCI, MCI-A, MC-HL
RA-	RA90, RA90-HL
TECK-	TECK90, TECK90-HL
TRAY-	TC, TC-ER, TC-ER-HL, PLTC, PLTC-ER, ITC, ITC-ER, MV, TYPE P

CATALOG NUMBER	ENTRY THREAD SIZE (NPT)	CABLE ACCEPTANCE DETAILS						MAX LENGTH 'D'	NPT LENGTH 'E'	HEXAGON DIMENSIONS	
		MAX NUMBER OF CORES	THROUGH DIAMETER 'A'	ARMOR DIAMETER 'B'		DIAMETER 'C'				ACROSS FLATS	ACROSS CORNERS
				MIN.	MAX.	MIN.	MAX.				
MC2X1B	1/2"	6	0.39" (9.9)	0.43" (10.9)	0.55" (14.0)	0.51" (13.0)	0.63" (16.0)	2.6" (66)	0.83" (21.1)	1.06" (26.9)	1.12" (28.4)
MC2X1C	1/2"	10	0.48" (12.2)	0.52" (13.2)	0.74" (18.8)	0.60" (15.2)	0.79" (20)	2.9" (73.6)	0.83" (21.1)	1.42" (36)	1.50" (38.1)
MC2X2	3/4"	21	0.71" (18.1)	0.65" (16.5)	0.95" (24.1)	0.73" (18.5)	1.00" (25.4)	3.1" (78.7)	0.84" (21.3)	1.61" (41)	1.69" (42.9)
MC2X3	1"	42	0.96" (26.4)	0.89" (22.6)	1.23" (31.2)	0.97" (24.6)	1.31" (33.3)	3.2" (81.3)	1.03" (26.2)	1.97" (50)	2.13" (254.1)
MC2X4	1-1/4"	73	1.16" (29.5)	1.15" (29.5)	1.48" (37.6)	1.23" (31.2)	1.56" (39.6)	3.6" (91.4)	1.05" (26.7)	2.36" (60)	2.50" (63.5)
MC2X5	1-1/2"	80	1.35" (34.3)	1.39" (35.3)	1.62" (41.1)	1.47" (37.3)	1.78" (45.2)	4.5" (114.3)	1.07" (27.2)	2.95" (75)	3.06" (77.8)
MC2X6	2"	80	1.62" (41.1)	1.39" (35.3)	1.89" (48.0)	1.47" (37.3)	2.04" (51.8)	4.5" (114.3)	1.10" (27.9)	2.95" (75)	3.06" (77.8)
MC2X7	2-1/2"	100	2.09" (53.1)	1.85" (47.0)	2.36" (59.9)	1.93" (49.0)	2.51" (63.8)	4.7" (119.4)	1.62" (41.1)	3.54" (90)	3.65" (92.8)
MC2X8	3"	120	2.52" (64.0)	2.19" (55.6)	2.81" (71.4)	2.27" (57.7)	3.01" (76.5)	4.8" (121.9)	1.68" (42.7)	4.06" (103)	4.22" (107.2)
MC2X9	3-1/2"	120	3.01" (76.5)	2.69" (68.3)	3.28" (83.3)	2.77" (70.4)	3.46" (87.9)	4.8" (121.9)	1.73" (43.9)	4.53" (115)	4.69" (119.2)
MC2X0	4"	120	3.50" (88.9)	3.28" (83.3)	3.82" (97.0)	3.46" (87.9)	4.07" (103.4)	5.1" (129.5)	1.78" (45.2)	5.12" (130)	5.33" (135.3)

Cable armor diameter and cable jacket diameter refer to the dimensions across the crest.