

IMPORTANT: Read all instructions before installing fixtures. Retain for future reference. Suitable for continuous row mounting.

SAFETY: For your safety, this fixture must be wired in accordance to local electrical codes and ordinances. All work should be done by a qualified electrician.

WARNING: Make certain power is OFF from the electrical panel before starting installation or attempting any maintenance. Indoor installation only.

ELECTRICAL CONNECTIONS:

MAXIMUM OF FOUR 12 AWG THROUGH BRANCH CIRCUIT CONDUCTOR SUITABLE FOR 90°C PERMITTED IN BOX (2 WIRES IN AND 2 WIRES OUT).

MAXIMUM OF SIX 14 AWG THROUGH BRANCH CIRCUIT CONDUCTOR SUITABLE FOR 90°C PERMITTED IN BOX (3 WIRES IN AND 3 WIRES OUT).

1. Make sure that the power from the main panel is switched off before starting any installation or maintenance of electrical fixtures.
2. Remove the cover on the junction box.
3. Bring in a power supply line through one of the knockouts located closest to the input module [Fig. 1]. Wire connector required (supplied by others).
4. Connect the green (or bare copper) wire to the ground screw (located in the middle of the junction box [Fig. 2]).
5. Connect the white wire to the Neutral (N) port of the input module [Fig. 2].
6. Connect the black wire to the Live (L) port of the input module [Fig. 2].
7. Replace the junction box cover back in place.
8. Use the selector tabs on the side of the driver/junction box to select wattage (preset at highest wattage) and color temperature (preset at 3500 K) [Fig. 3].
9. Secure driver to structure using the attached mounting plate.

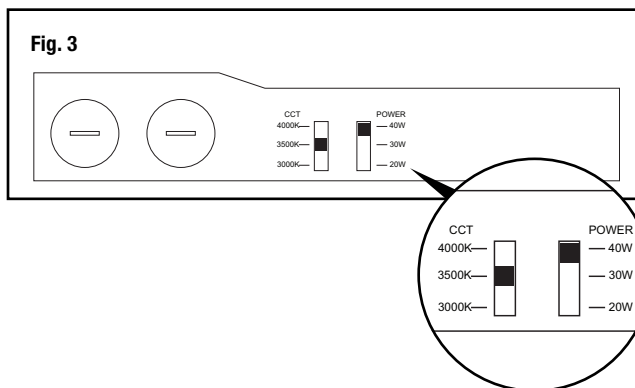
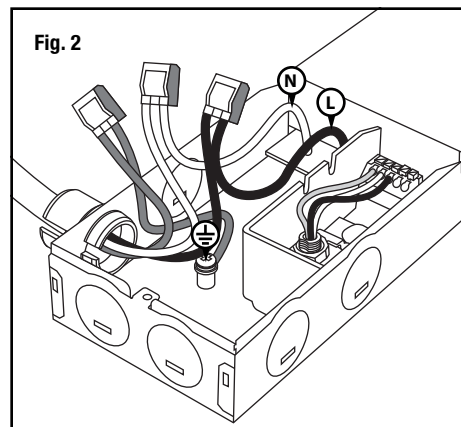
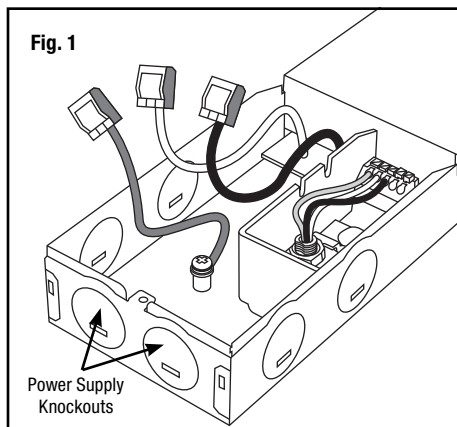

INSTALLATION INSTRUCTIONS:

1. Hold the LED panel 45° in relation to the T-bar direction (light side should be facing downwards).
2. Push panel through the T-bar opening [Fig. 4].
3. Adjust the LED panel so that the outer edge is sitting flush in the T-bars.
4. Rotate support clips 180°. Make sure that the locking clip is secured to the groove on the fixture [Fig. 5].
5. Bend the support clips 90° upwards, then bend 90° outwards until the tips of the support clips are positioned above the T-bars [Fig. 5].
6. Use support cables (supplied by others) to secure the fixture to the structure (use the hole at the top of the support clips) [Fig. 6].
7. Connect the EDGE panel to the driver using the DC 2.1 twist-and-lock connector [Fig. 7].
8. Place ceiling tile on top of the EDGE panel. Make sure to cut 1.5" off of one of the corners to allow the low voltage connection wires to pass through [Fig. 8].
9. Turn the power back on from the main panel.

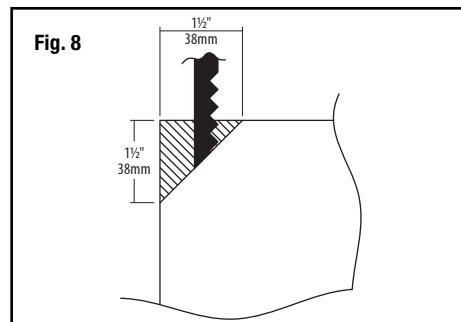
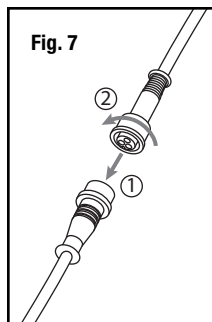
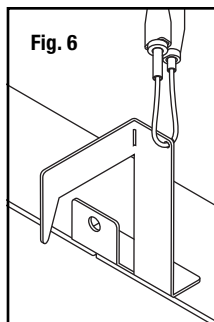
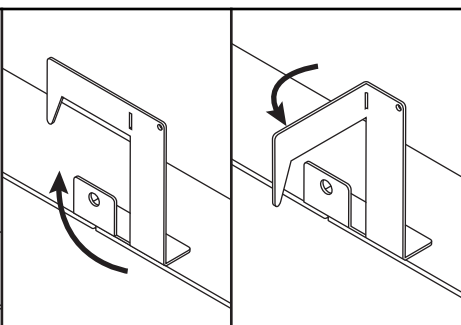
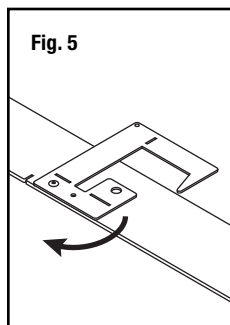
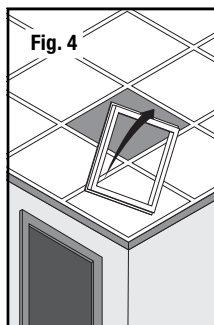

Scan QR code
for instructional
video

Scannez le code
QR pour la vidéo
d'instructions