

INSTRUCTIONS FOR

CHANCE KELLY BAR ADAPTERS

WARNING

Read and understand this instruction sheet completely before installing an anchor. These instructions are intended to illustrate the use of Kelly Bar Adapters. Anchor installing tools covered in this instruction sheet must be used by competent personnel familiar with and following good work and safety practices. Should additional information and details be desired or if specific situations arise which are not covered adequately herein, the user should refer to CHANCE directly. In some cases, CHANCE may make specific recommendations concerning installation torque and installation depth for a particular application.

Various anchor tools such as a Locking Dog Assembly or Torque Indicator may be attached to the Kelly Bar Adapter via the bolt circle on the flange of the Kelly Bar Adapter. See instructions included with those other tools for more specific installation instructions.

To select the appropriate Kelly Bar Adapter for your equipment, first measure your Kelly bar across the flats to determine the matching Kelly Bar Adapter size. Then determine the maximum torque output of your equipment's digger motor. Refer to the table on page 2 and choose the Kelly Bar Adapter of the correct size with a torque rating equal to or greater than the maximum output of the digger motor.

The Kelly Bar Adapters have the Kelly bar size cast onto the outside of the casting. Verify that the Kelly Bar Adapter you have matches the size of your Kelly bar. Then check the end of the Kelly bar for wear. If the Kelly bar is worn, replace it. A minimum of three inches of hex or square engagement is required between the Kelly bar and the Kelly Bar Adapter or the tooling and the bent arm pin may wear out quickly and become damaged.

Once the correct Kelly Bar Adapter is chosen and the Kelly bar is checked for wear, slide the Kelly bar into the socket of the Kelly Bar Adapter and pin the Kelly Bar Adapter in place with the bent arm pin provided. Install the coil lock through the hole in the end of the bent arm pin. The coil lock **must** be used to keep the bent arm pin in place. Other retention methods, including a bolt and nut, and "klik" retainer pins, have been tested and shown to be inadequate. The bent arm pin and coil lock must be checked periodically and replaced with original equipment as necessary to ensure proper and safe operation.

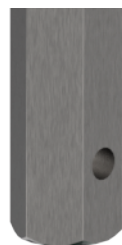

Side View
of Kelly Bar

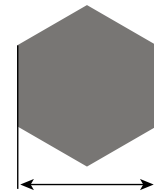

Top View
of Kelly Bar

Measure Kelly Bar Across the Flats

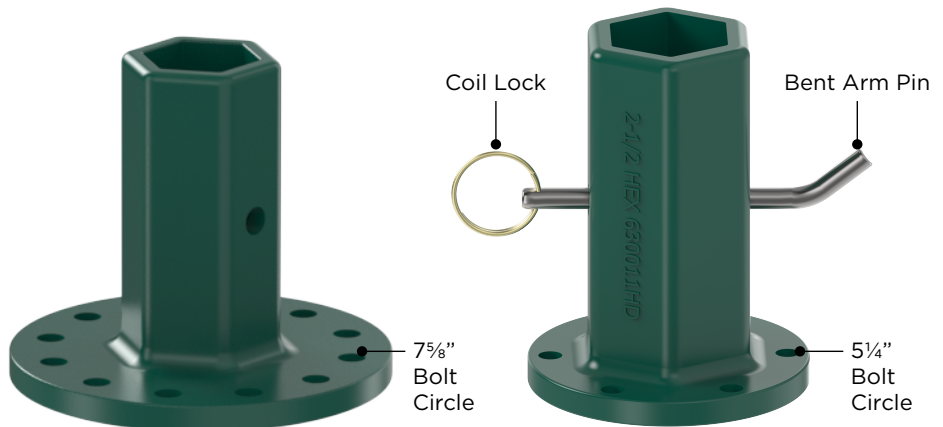

TOUGH ONE™ Drive Tools
(7 5/8" 12 bolt hole circle)

Standard Drive Tools
(5 1/4" 6 bolt hole circle)



CHANCE

⚠ WARNING

Loose or broken parts may be thrown at high speed.
Can cause property damage, severe injury, or death.
Stay away from drive train during installation.

⚠ WARNING

Inadequate maintenance, incorrect tool, or improper use of tools and hardware may lead to unexpected fracture.
Can cause property damage, severe injury, or death.
Frequently inspect tools, Kelly bar, and hardware for damage, correct quantity, correct size, correct type, and bolt tightness. Replace as necessary with the same grade and size as the originals.



Catalog No.	Kelly Bar Size	Torque Rating (ft-lb)	Bolt Circle Diameter	Replacement Pin and Coil Lock
630013	2" Hex	10,000	5 1/4"	C3031223
630011HD	2-1/2" Hex	10,000	5 1/4"	C3031223
630012HD	2-5/8" Hex	10,000	5 1/4"	C3031223
C3030936	2-1/2" Hex	12,000	7 5/8"	C3031223
C3030937	2-5/8" Hex	15,000	7 5/8"	C3031223
C3030940	3" Hex	25,000	7 5/8"	C3031222
C3030955	2-1/2" Square	17,000	7 5/8"	C3031227
C3030958	3" Square	20,000	7 5/8"	C3031227
C3031571	3-1/2" Square	30,000	7 5/8"	C3031227

⚠ WARNING

Bending or overtorquing the tool string is hazardous.
Can cause property damage, severe injury, or death.
Do not allow visible bending or torque greater than the rating of the tooling.

⚠ WARNING

Anchor installation can puncture underground utility service.
Can cause property damage, severe injury, or death.
Locate and avoid all underground utility services when installing an anchor.

Always use tools that are the appropriate size and rating for your particular application. For instructions on how to use the Locking Dog Assembly, Drive-End Wrench assembly, or other drive tools, see the instruction sheets included with each tool.

These instructions do not claim to cover all details or variations in equipment nor to provide for all possible conditions to be met with concerning installation, operation, or maintenance of this equipment. If further information is desired or if particular problems are encountered which are not sufficiently covered in this guide, contact Hubbell.

NOTE: Because Hubbell has a policy of continuous product improvement, we reserve the right to change design and specifications without notice.

