

THIS COPY IS PROVIDED ON A RESTRICTED BASIS AND IS NOT TO BE USED IN ANY WAY DETRIMENTAL TO THE INTERESTS OF PANDUIT CORP.

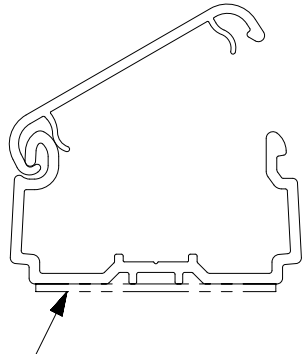

ADHESIVE BACKING
LDPH10_OPEN POSITION

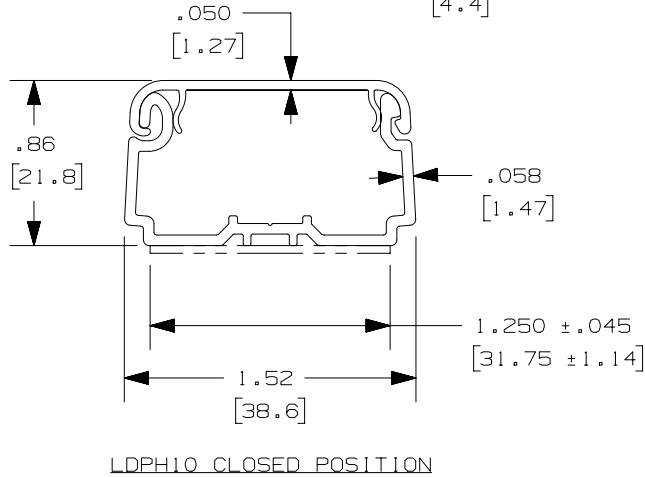

PANDUIT PART NO.	LENGTH	WEIGHT
LDPH10**6-A	72.00±.18 (1828.8±4.6)	.13 LBS/FT (.57 g/mm)
LDPH10**8-A	96.00±.18 (2438.4±4.6)	
LDPH10**10-A	120.00±.18 (3048.0±4.6)	

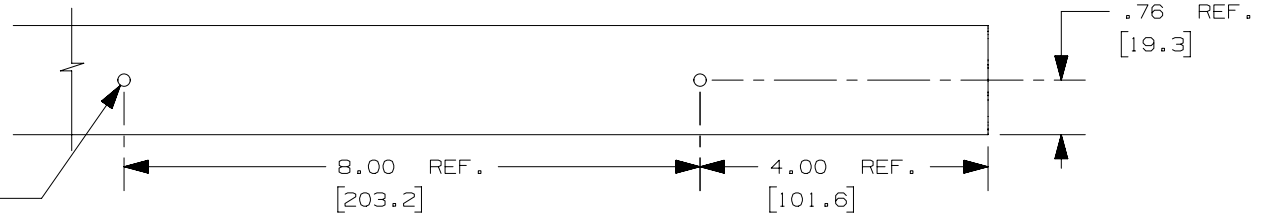

NOTES:

- VISIT OUR ON-LINE CATALOG AT WWW.PANDUIT.COM FOR A LIST OF ADDITIONAL PART NUMBER SUFFIXES TO INDICATE COLOR AND/OR PACKAGE QUANTITY.
- PART IS DESIGNED TO SUPPORT MAXIMUM WEIGHT ON A CLEAN, DRY, SMOOTH SURFACE. THE SURFACE MUST BE PROPERLY PREPARED IN ACCORDANCE WITH PANDUIT RECOMMENDATIONS.
- PANDUIT RECOMMENDATIONS:
 - IT IS RECOMMENDED THAT PANDUIT ADHESIVE TAPE BE APPLIED ON SURFACES WHOSE TEMPERATURE IS APPROXIMATELY 70°F (21°C) OR HIGHER FOR THE INITIAL BOND.
 - THE OPTIMUM RECOMMENDED DWELL TIME PRIOR TO LOADING FOR RUBBER ADHESIVE IS TWO HOURS.
 - PANDUIT TAPE SHOULD BE APPLIED TO A CLEAN, DRY, GREASE-FREE SURFACE WITH SUFFICIENT PRESSURE TO ASSURE GOOD ADHESIVE CONTACT. AVOID ADHESIVE CONTAMINATION WITH FOREIGN MATERIAL BY CLEANING WITH AN ISOPROPY ALCOHOL OR A DEGREASER.
- PRESSURE SENSITIVE FOAM .040 [1.0] THICK WITH PROTECTIVE LINER.
- TO APPLY PART:
 - REMOVE PROTECTIVE LINER.
 - PLACE PART IN DESIRED LOCATION.
 - APPLY PRESSURE TO FLAT SURFACE OF PART.
- NO WARRANTY, EXPRESSED OR IMPLIED, IS MADE BY PANDUIT WITH RESPECT TO ADHESIVE BOND PERFORMANCE. THE CONDITIONS UNDER WHICH THESE MOUNTS MAY BE APPLIED AND/OR THE SURFACE TO WHICH THEY ARE APPLIED ARE BEYOND PANDUIT'S CONTROL.
- DIMENSIONS IN METRIC ARE IN [].

PART NUMBER		LDPH10		
TITLE		HINGED LDPH10 RACEWAY		
CUSTOMER DRAWING				
ITEM REVISION NAME		D38737BQ/05		
DATASET FILE NAME		D38737BQ_DC_LDPH10/05B		
THIRD ANGLE PROJECTION				
MATERIAL		PVC		
DRAWING NUMBER		38737-16		
DRAWN BY	DATE	CHK	SCALE	SIZE
JBN	09-22-04	BKR	NONE	A
SHEET 1 OF 1				

REV	DATE	BY	CHK	APR	DESCRIPTION	ECN
05B	5-16-22	BJN	BSN	TAM	REMOVED -2A P/N FROM TABLE	M09000QE
05A	6-28-21	BJN	BSN	BETL	UPDATED NOTES	38737-16

A-SIZE CUSTOMER

2

1

2

1