

Project:
Type:
Date:
Product Code:
Approval:

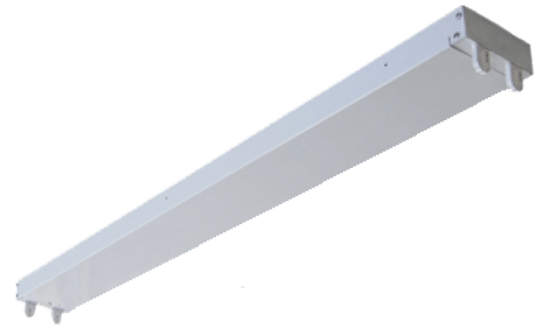

Durability, and cost-effective with LED tube technology.

BTSP - SPECIFICATIONS MAY CHANGE WITHOUT NOTICE

Contractor-grade, surface and suspended mount strip fixture with LED tubes. It is ideal for indoor use, where energy-efficiency, performance and ease of maintenance is essential. Its rugged design and energy-efficiency make it ideally suited for task lighting or general illumination applications.

FEATURES

- 2', 3', 4' and 8' lengths available
- Available with 1, 2, 3, 4, 6 or 8 lamp configurations
- Optional wireguard allows added application flexibility
- Can be row mounted
- Available in 2700K, 4000K and 5000K

OPTIONS

- 2', 3', 4' and 8' lengths available
- 1, 2, 3, 4, 6 or 8 lamps available
- Continuous row-mounting available
- 347V options available
- Wireguard with various finishes (consult factory)
- Available in 2700K, 4000K and 5000K

APPLICATIONS

- Coves
- Display cabinets
- Manufacturing
- Task lighting

APPROVALS

- ETL listed product

OPTICS

Pre-painted body in high-reflectance white. Optional wireguard is available.

ELECTRICAL

All components have met all regulatory approvals. Fixture is available in 120 - 277VAC and 347V options. LED tube retention through rotary lamp holders.

MOUNTING

Holes provided for convenient surface mounting or S-hook chain-mounting. Can be row-mounted using a suspended or surface-mount configuration.

CONSTRUCTION

Pre-painted, high reflectance white body is precision bent for added strength and rigidity. End caps are fastened by screws allowing the flexibility of repositioning to act as joiners for raceway wiring. Shallow fixture design provides a clean appearance for many environments.



PRODUCT DIMENSIONS

End View

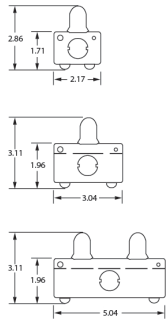

Side View

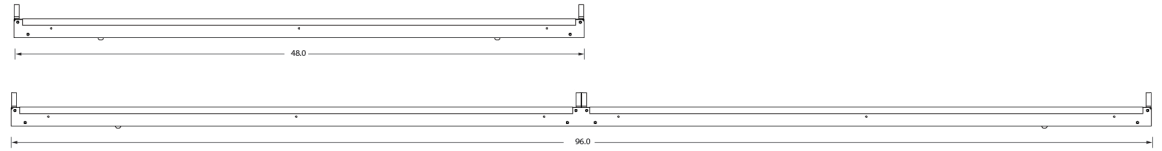

PRODUCT KEY

Fixture Type	Fixture Size	Fixture Length	Number of Lamps	Lamp Watts	Lamp Colour	Driver Type	Ballast Voltage	Options
BTSP				W				
	M (2W)	2'	1	2' Tubes	7W	LTI (Int Driver)	UNV	
	N (3W)	3'	2		9W		840	
	Blank (5W)	4'	3	4' Tubes	15W			
		8'	4		18W			
			6					
			8					

OPTIONS

<p>Battery Back-Up (Needs to be specified)</p> <p>Sensors W12 - Motion Sensor - 10C</p> <p>Wireguard G1 - Wireguard Heavy Duty, Painted White</p>	<p>Wire</p> <p>W3XX - Flexible Whip - 16/3 600V White (XX - Length)</p> <p>W4XX - Flexible Whip - 16/3 600V Black (XX Length)</p> <p>W5XX - Power Cord (Twist Lock - Specify Nema Code)</p> <p>W6XX - Power Cord (3-Wire 120V Plug, 14/3)(XX - Length)</p> <p>W8XX - Power Cord (3-Wire 120V 5-15P, 16/3)</p> <p>Hangers</p> <p>M1 - Speedy Hanger (V-Bracket)</p> <p>M3 - Aircraft Cable "Y-Toggle", with cable gripper (5, 10 and 15')</p>
--	--

