

Full Voltage Non-Reversing NEMA 4X Non-Metallic

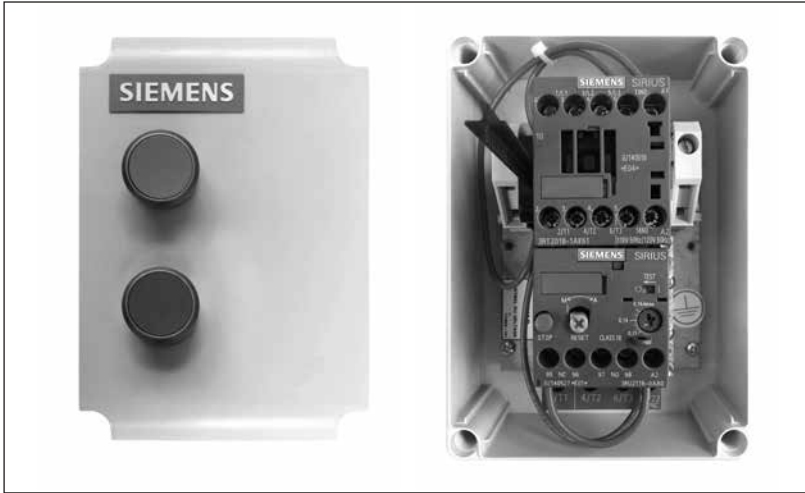

Selection

Selection



Features

- High quality and reliability
- Up to 10HP at 600V rating
- 1 NO auxiliary contact
- Class 10 bimetal overload relays including:
 - Manual reset
 - Phase Loss Protection
 - Separate Trip or Alarm contact
- NEMA 4X polycarbonate enclosure with conduit entry knockouts
- Offered in 120V AC separate control
- Wiring kit for single phase conversion included

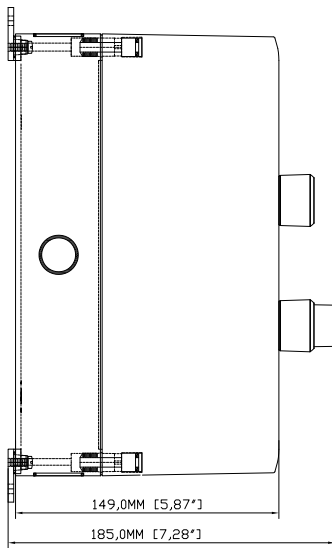

SIDE VIEW OF ENCLOSURE

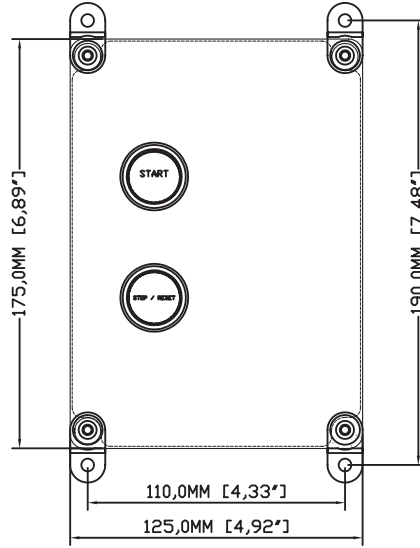

TOP OF ENCLOSURE

Enclosed Amps	CSA Maximum HP Rating							Pilot Devices	Coil Voltage	Contactor Reference Number	Aux. Contacts supplied as standard per contactor		Enclosure Plastic CSA type 4X
	1 phase		3-phase								NO	NC	
	120V	240V	208V	240V	480V	600V						Order No.	
11	0.5	1.5	3	3	7.5	10	Mechanical	24V [Ⓞ]	17	1	0	3RE3110-00A17-1AB0	
11	0.5	1.5	3	3	7.5	10	Star/Stop	120V				3RE3110-00A17-1AK6	
11	0.5	1.5	3	3	7.5	10	Pushbutton	240V [Ⓞ]				3RE3110-00A17-1AP6	



HP	Power Line Voltage	FLC*	Contactor	"Bimetallic O/L (Class 10)"	O/L Range	"WHEN PROTECTED BY OVER CURRENT PROTECTION" Fuse type CC, RK1, RK5, K5, J	"KAIC Rating"
1/10	120V/1PH	3	3RT2017/18	3RU2116-1EB0	2.8 - 4.0 A	15	5 Kaic
1/8	120V/1PH	3.8	3RT2017/18	3RU2116-1FB0	3.5 - 5.0 A	20	5 Kaic
1/6	120V/1PH	4.4	3RT2017/18	3RU2116-1FB0	3.5 - 5.0 A	20	5 Kaic
1/4	120V/1PH	5.8	3RT2017/18	3RU2116-1GB0	4.5 - 6.3 A	25	5 Kaic
1/3	120V/1PH	7.2	3RT2017/18	3RU2116-1HB0	5.5 - 8.0 A	30	5 Kaic
1/2	120V/1PH	9.8	3RT2017/18	3RU2116-1KB0	9.0 - 12.5 A	45 / 50 J	5 Kaic
1/4	208V/3PH	1.1	3RT2017/18	3RU2116-0KB0	0.9 - 1.25 A	3	1 Kaic
1/3	208V/3PH	1.33	3RT2017/18	3RU2116-1AB0	1.1 - 1.6 A	6	1 Kaic
1/2	208V/3PH	2.42	3RT2017/18	3RU2116-1CB0	1.8 - 2.5 A	10	5 Kaic
3/4	208V/3PH	3.52	3RT2017/18	3RU2116-1EB0	2.8 - 4.0 A	15	5 Kaic
1	208V/3PH	4.62	3RT2017/18	3RU2116-1GB0	4.5 - 6.3 A	25	5 Kaic
1 1/2	208V/3PH	6.6	3RT2017/18	3RU2116-1HB0	5.5 - 8.0 A	30	5 Kaic
2	208V/3PH	7.48	3RT2017/18	3RU2116-1JB0	7.0 - 10 A	40	5 Kaic
3	208V/3PH	10.56	3RT2017/18	3RU2116-1KB0	9.0 - 12.5 A	45 / 50 J	5 Kaic
1/10	240V/1PH	1.5	3RT2017/18	3RU2116-1AB0	1.1 - 1.6 A	6	1 Kaic
1/8	240V/1PH	1.9	3RT2017/18	3RU2116-1CB0	1.8 - 2.5 A	10	5 Kaic
1/6	240V/1PH	2.2	3RT2017/18	3RU2116-1CB0	1.8 - 2.5 A	10	5 Kaic
1/4	240V/1PH	2.9	3RT2017/18	3RU2116-1DB0	2.2 - 3.2 A	10	5 Kaic
1/3	240V/1PH	3.6	3RT2017/18	3RU2116-1EB0	2.8 - 4.0 A	15	5 Kaic
1/2	240V/1PH	4.9	3RT2017/18	3RU2116-1GB0	4.5 - 6.3 A	25	5 Kaic
3/4	240V/1PH	6.9	3RT2017/18	3RU2116-1HB0	5.5 - 8.0 A	30	5 Kaic
1	240V/1PH	8	3RT2017/18	3RU2116-1JB0	7.0 - 10 A	40	5 Kaic
1 1/2	240V/1PH	10	3RT2017/18	3RU2116-1KB0	9.0 - 12.5 A	45 / 50 J	5 Kaic
1/4	240V/3PH	0.96	3RT2017/18	3RU2116-0KB0	0.9 - 1.25 A	3	1 Kaic
1/3	240V/3PH	1.16	3RT2017/18	3RU2116-1AB0	1.1 - 1.6 A	6	1 Kaic
1/2	240V/3PH	2.2	3RT2017/18	3RU2116-1CB0	1.8 - 2.5 A	10	5 Kaic
3/4	240V/3PH	3.2	3RT2017/18	3RU2116-1EB0	2.8 - 4.0 A	15	5 Kaic
1	240V/3PH	4.2	3RT2017/18	3RU2116-1FB0	3.5 - 5.0 A	20	5 Kaic
1 1/2	240V/3PH	6	3RT2017/18	3RU2116-1HB0	5.5 - 8.0 A	30	5 Kaic
2	240V/3PH	6.8	3RT2017/18	3RU2116-1HB0	5.5 - 8.0 A	30	5 Kaic
3	240V/3PH	9.6	3RT2017/18	3RU2116-1KB0	9.0 - 12.5 A	45 / 50 J	5 Kaic
1/4	480V/3PH	0.48	3RT2017/18	3RU2116-0GB0	0.45 - 0.63 A	3	1 Kaic
1/3	480V/3PH	0.58	3RT2017/18	3RU2116-0HB0	0.55 - 0.8 A	3	1 Kaic
1/2	480V/3PH	1	3RT2017/18	3RU2116-0JB0	0.7 - 1.0 A	3	1 Kaic
3/4	480V/3PH	1.4	3RT2017/18	3RU2116-1AB0	1.1 - 1.6 A	6	1 Kaic
1	480V/3PH	1.8	3RT2017/18	3RU2116-1CB0	1.8 - 2.5 A	10	5 Kaic
1 1/2	480V/3PH	2.6	3RT2017/18	3RU2116-1DB0	2.2 - 3.2 A	10	5 Kaic
2	480V/3PH	3.4	3RT2017/18	3RU2116-1EB0	2.8 - 4.0 A	15	5 Kaic
3	480V/3PH	4.8	3RT2017/18	3RU2116-1FB0	3.5 - 5.0 A	20	5 Kaic
5	480V/3PH	7.6	3RT2017/18	3RU2116-1JB0	7.0 - 10 A	40	5 Kaic
7 1/2	480V/3PH	11	3RT2017/18	3RU2116-1KB0	9.0 - 12.5 A	45 / 50 J	5 Kaic
1/4	600V/3PH	0.38	3RT2017/18	3RU2116-0FB0	0.35 - 0.5 A	1	1 Kaic
1/3	600V/3PH	0.47	3RT2017/18	3RU2116-0GB0	0.45 - 0.63 A	3	1 Kaic
1/2	600V/3PH	0.9	3RT2017/18	3RU2116-0JB0	0.7 - 1.0 A	3	1 Kaic
3/4	600V/3PH	1.3	3RT2017/18	3RU2116-1AB0	1.1 - 1.6 A	6	1 Kaic
1	600V/3PH	1.7	3RT2017/18	3RU2116-1BB0	1.4 - 2.0 A	6	5 Kaic
1 1/2	600V/3PH	2.4	3RT2017/18	3RU2116-1CB0	1.8 - 2.5 A	10	5 Kaic
2	600V/3PH	2.7	3RT2017/18	3RU2116-1DB0	2.2 - 3.2 A	10	5 Kaic
3	600V/3PH	3.9	3RT2017/18	3RU2116-1EB0	2.8 - 4.0 A	15	5 Kaic
5	600V/3PH	6.1	3RT2017/18	3RU2116-1HB0	5.5 - 8.0 A	30	5 Kaic
7 1/2	600V/3PH	9	3RT2017/18	3RU2116-1JB0	7.0 - 10 A	40	5 Kaic
10	600V/3PH	11	3RT2017/18	3RU2116-1KB0	9.0 - 12.5 A	45 / 50 J	5 Kaic

Note:

FLC: as per CSA 22.2 No.14-13 table 18A.

For all the 3RU2116 Overloads, the contactor can be use are 3RT2017, 3RT2018, 11 Amps max. in the enclosure