

M-Series ARO Interchange Pneumatic Couplings

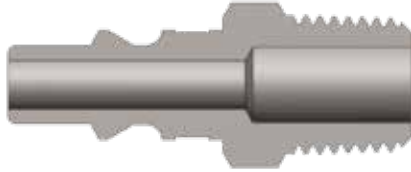

Body Size	M-Series Manual ARO Interchange Coupler (Male Threads)											
	Part Detail			Old Part #	Length		Maximum OD		Hex Inch	Weight Lb	Package Qty	
	Part Number	Threads	Material		Inch	mm	Inch	mm			Bag	Box
1/4"	2MM2-B	1/4" - 18 NPT	brass	DC37	2.13	54.0	0.87	22.0	3/4"	0.19	10	100
1/4"	2MM3-B	3/8" - 18 NPT	brass	DC3703	2.13	54.0	0.87	22.0	13/16"	0.20	10	100



Body Size	M-Series ARO Interchange Nipple (Male Threads)											
	Part Detail			Old Part #	Length		Maximum OD		Hex Inch	Weight Lb	Package Qty	
	Part Number	Threads	Material		Inch	mm	Inch	mm			Bag	Box
1/4"	M2M1	1/8" - 27 NPTF	steel	--	1.48	37.6	0.58	14.7	1/2"	0.04	10	100
1/4"	M2M2	1/4" - 18 NPTF	steel	DCP37	1.60	40.6	0.65	16.5	9/16"	0.05	10	100
1/4"	M2M2-B	1/4" - 18 NPTF	brass	--	1.60	40.6	0.65	16.5	9/16"	0.05	10	100
1/4"	M2M3	3/8" - 18 NPTF	steel	DCP3703	1.80	45.7	0.79	20.1	11/16"	0.06	10	100
3/8"	M3M3	3/8" - 18 NPTF	steel	DCP35	1.91	48.5	0.79	20.1	11/16"	0.10	10	50

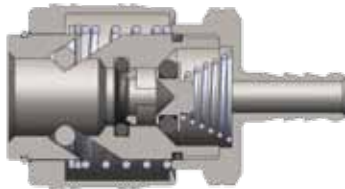

Body Size	M-Series Automatic ARO Interchange Coupler (Standard Hose Barb)											
	Part Detail			Length		Maximum OD		Hex Inch	Weight Lb	Package Qty		
	Part Number	Hose ID	Material	Inch	mm	Inch	mm			Bag	Box	
1/4"	2MS2-PL	1/4"	steel	1.91	48.6	1.06	27.0	13/16"	0.28	10	100	
1/4"	2MS2.5-PL	5/16"	steel	2.33	59.1	1.06	27.0	13/16"	0.28	10	100	
1/4"	2MS3-PL	3/8"	steel	2.50	63.6	1.06	27.0	13/16"	0.30	10	100	
3/8"	3MS3-PL	3/8"	steel	2.60	66.0	1.26	32.0	1-1/16"	0.43	10	50	

1/4" Ball Swivel Plugs

Features:

- threaded portion is brass
- plug and nut portion is nickel-plated hardened steel
- rated **250 PSI**

Male NPT Ball Swivel x ARO Plug

Size	Part #	Opt Qty
1/4"	DCP37SWIV	10

