

Full Voltage Non-Reversing NEMA 4X Non-Metallic

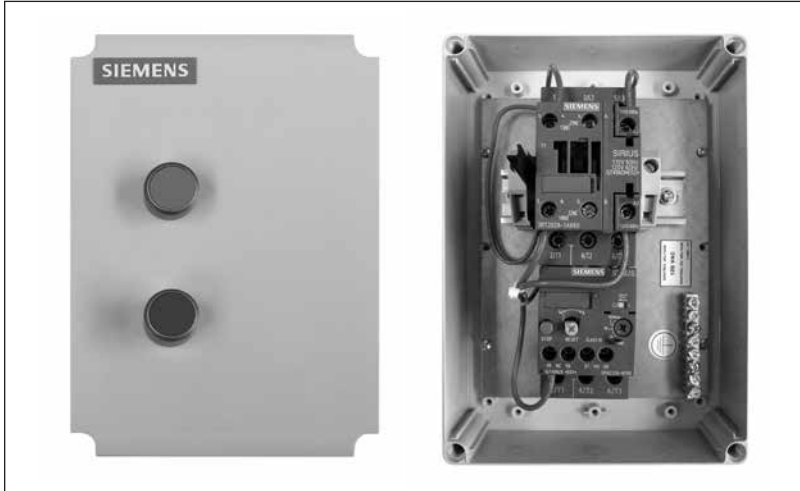

Non-Combination - Up to 10HP - 600V

Selection



Features

- High quality and reliability
- Up to 20HP at 600V rating
- 1 NO + 1NC auxiliary contact
- Class 10 bimetal overload relays including:
 - Manual reset
 - Phase Loss Protection
 - Separate Trip and/or Alarm contact
- NEMA 4X polycarbonate enclosure with conduit entry knockouts
- Offered in 120V AC separate control
- Wiring kit for single phase conversion included

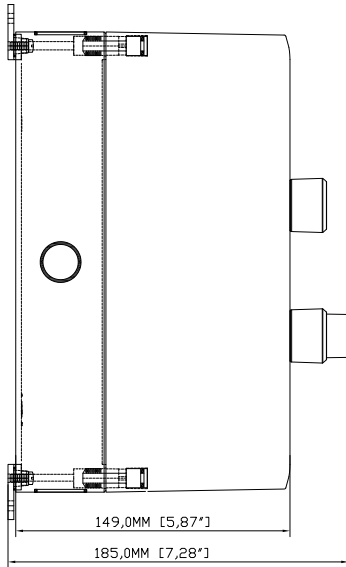

SIDE VIEW OF ENCLOSURE

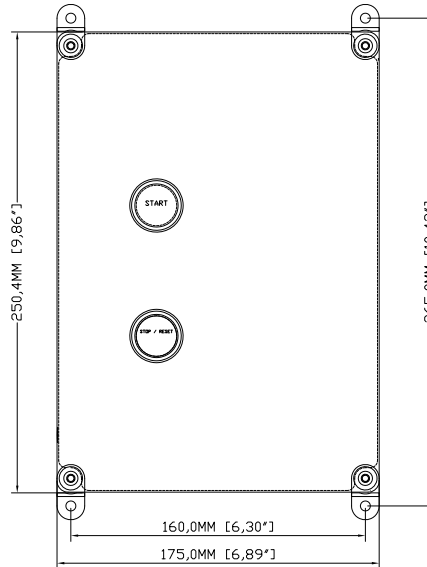

TOP OF ENCLOSURE

Enclosed Amps	CSA Maximum HP Rating							Pilot Devices	Coil Voltage	Contactor Reference Number	Aux. Contacts supplied as standard per contactor		Enclosure Plastic CSA type 4X
	1 phase		3-phase								NO	NC	
	120V	240V	208V	240V	480V	600V	Order No.						
22	1.5	3	5	7.5	15	20	Mechanical	24V [Ⓞ]	27	1	1	3RE3120-00A27-0AB0	
22	1.5	3	5	7.5	15	20	Star/Stop	120V				3RE3120-00A27-0AK6	
22	1.5	3	5	7.5	15	20	Pushbutton	240V [Ⓞ]				3RE3120-00A27-0AP6	

HP	Power Line Voltage / Phase	FLC*	Contactor	Bimetallic O/L (Class / Classe 10)	O/L Range / Amp	"WHEN PROTECTED BY OVER CURRENT PROTECTION Fuse Type"	KAIC Rating
1/10	120V/1PH (Monophase)	3	3RT2027/28	3RU2126-1EB0	2.8 - 4.0 A	15	5 Kaic
1/8	120V/1PH (Monophase)	3.8	3RT2027/28	3RU2126-1FB0	3.5 - 5.0 A	20	5 Kaic
1/6	120V/1PH (Monophase)	4.4	3RT2027/28	3RU2126-1FB0	3.5 - 5.0 A	20	5 Kaic
1/4	120V/1PH (Monophase)	5.8	3RT2027/28	3RU2126-1GB0	4.5 - 6.3 A	25	5 Kaic
1/3	120V/1PH (Monophase)	7.2	3RT2027/28	3RU2126-1HB0	5.5 - 8.0 A	30	5 Kaic
1/2	120V/1PH (Monophase)	9.8	3RT2027/28	3RU2126-1KB0	9.0 - 12.5 A	45 / 50J	5 Kaic
3/4	120V/1PH (Monophase)	13.8	3RT2027/28	3RU2126-4AB0	11 - 16 A	60	5 Kaic
1	120V/1PH (Monophase)	16	3RT2027/28	3RU2126-4BB0	14 - 20 A	60	5 Kaic
1 1/2	120V/1PH (Monophase)	20	3RT2027/28	3RU2126-4CB0	17 - 22 A	80	5 Kaic
1/2	208V/3PH (Triphase)	2.42	3RT2027/28	3RU2126-1CB0	1.8 - 2.5 A	10	5 Kaic
3/4	208V/3PH (Triphase)	3.52	3RT2027/28	3RU2126-1EB0	2.8 - 4.0 A	15	5 Kaic
1	208V/3PH (Triphase)	4.62	3RT2027/28	3RU2126-1GB0	4.5 - 6.3 A	25	5 Kaic
1 1/2	208V/3PH (Triphase)	6.6	3RT2027/28	3RU2126-1HB0	5.5 - 8.0 A	30	5 Kaic
2	208V/3PH (Triphase)	7.48	3RT2027/28	3RU2126-1JB0	7.0 - 10 A	40	5 Kaic
3	208V/3PH (Triphase)	10.56	3RT2027/28	3RU2126-1KB0	9.0 - 12.5 A	45 / 50J	5 Kaic
5	208V/3PH (Triphase)	16.72	3RT2027/28	3RU2126-4BB0	14 - 20 A	80	5 Kaic
1/8	240V/1PH (Monophase)	1.9	3RT2027/28	3RU2126-1CB0	1.8 - 2.5 A	10	5 Kaic
1/6	240V/1PH (Monophase)	2.2	3RT2027/28	3RU2126-1CB0	1.8 - 2.5 A	10	5 Kaic
1/4	240V/1PH (Monophase)	2.9	3RT2027/28	3RU2126-1DB0	2.2 - 3.2 A	10	5 Kaic
1/3	240V/1PH (Monophase)	3.6	3RT2027/28	3RU2126-1EB0	2.8 - 4.0 A	15	5 Kaic
1/2	240V/1PH (Monophase)	4.9	3RT2027/28	3RU2126-1GB0	4.5 - 6.3 A	25	5 Kaic
3/4	240V/1PH (Monophase)	6.9	3RT2027/28	3RU2126-1HB0	5.5 - 8.0 A	30	5 Kaic
1	240V/1PH (Monophase)	8	3RT2027/28	3RU2126-1JB0	7.0 - 10 A	40	5 Kaic
1 1/2	240V/1PH (Monophase)	10	3RT2027/28	3RU2126-1KB0	9.0 - 12.5 A	45 / 50J	5 Kaic
2	240V/1PH (Monophase)	12	3RT2027/28	3RU2126-1KB0	9.0 - 12.5 A	45 / 50J	5 Kaic
3	240V/1PH (Monophase)	17	3RT2027/28	3RU2126-4BB0	14 - 20 A	80	5 Kaic
1/2	240V/3PH (Triphase)	2.2	3RT2027/28	3RU2126-1CB0	1.8 - 2.5 A	10	5 Kaic
3/4	240V/3PH (Triphase)	3.2	3RT2027/28	3RU2126-1EB0	2.8 - 4.0 A	15	5 Kaic
1	240V/3PH (Triphase)	4.2	3RT2027/28	3RU2126-1FB0	3.5 - 5.0 A	20	5 Kaic
1 1/2	240V/3PH (Triphase)	6	3RT2027/28	3RU2126-1HB0	5.5 - 8.0 A	30	5 Kaic
2	240V/3PH (Triphase)	6.8	3RT2027/28	3RU2126-1HB0	5.5 - 8.0 A	30	5 Kaic
3	240V/3PH (Triphase)	9.6	3RT2027/28	3RU2126-1KB0	9.0 - 12.5 A	45 / 50J	5 Kaic
5	240V/3PH (Triphase)	15.2	3RT2027/28	3RU2126-4BB0	14 - 20 A	60	5 Kaic
7 1/2	240V/3PH (Triphase)	22	3RT2027/28	3RU2126-4DB0	22 - 25 A	90 / 100J	5 Kaic
1	480V/3PH (Triphase)	1.8	3RT2027/28	3RU2126-1CB0	1.8 - 2.5 A	10	5 Kaic
1 1/2	480V/3PH (Triphase)	2.6	3RT2027/28	3RU2126-1DB0	2.2 - 3.2 A	10	5 Kaic
2	480V/3PH (Triphase)	3.4	3RT2027/28	3RU2126-1EB0	2.8 - 4.0 A	15	5 Kaic
3	480V/3PH (Triphase)	4.8	3RT2027/28	3RU2126-1FB0	3.5 - 5.0 A	20	5 Kaic
5	480V/3PH (Triphase)	7.6	3RT2027/28	3RU2126-1JB0	7.0 - 10 A	40	5 Kaic
7 1/2	480V/3PH (Triphase)	11	3RT2027/28	3RU2126-1KB0	9.0 - 12.5 A	45 / 50J	5 Kaic
10	480V/3PH (Triphase)	14	3RT2027/28	3RU2126-4AB0	11 - 16 A	60	5 Kaic
15	480V/3PH (Triphase)	21	3RT2027/28	3RU2126-4CB0	17 - 22 A	80	5 Kaic
1 1/2	600V/3PH (Triphase)	2.4	3RT2027/28	3RU2126-1CB0	1.8 - 2.5 A	10	5 Kaic
2	600V/3PH (Triphase)	2.7	3RT2027/28	3RU2126-1DB0	2.2 - 3.2 A	10	5 Kaic
3	600V/3PH (Triphase)	3.9	3RT2027/28	3RU2126-1EB0	2.8 - 4.0 A	15	5 Kaic
5	600V/3PH (Triphase)	6.1	3RT2027/28	3RU2126-1HB0	5.5 - 8.0 A	30	5 Kaic
7 1/2	600V/3PH (Triphase)	9	3RT2027/28	3RU2126-1JB0	7.0 - 10 A	40	5 Kaic
10	600V/3PH (Triphase)	11	3RT2027/28	3RU2126-1KB0	9.0 - 12.5 A	45 / 50J	5 Kaic
15	600V/3PH (Triphase)	17	3RT2027/28	3RU2126-4BB0	14 - 20 A	80	5 Kaic
20	600V/3PH (Triphase)	22	3RT2027/28	3RU2126-4DB0	22 - 25 A	90 / 100J	5 Kaic

Note:

FLC: as per CSA 22.2 No.14-13 table 18A.

For all the 3RU2126 Overloads the contactor can use are 3RT2027, 3RT2028, 22 Amps max. in the enclosure.