

## TWO HOLE HYLUG™ CODE CONDUCTOR LONG BARREL (Continued)

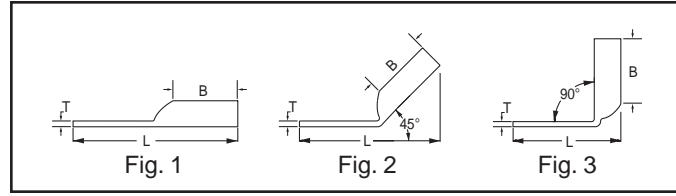

C-52

Catalog Number	Fig #	Conductor		Stud Hole Size	Stud Hole Spacing	Tongue Width	Figure Dimensions			▲ Installation Tooling					Wire Strip Length									
		AWG	*** MM <sup>2</sup>				(B)	(T)	(L)	Dieless (# of crimps)	Mechanical MD6, OUR840, MD7-34R	Hydraulic BCT500HS, Y500CTHS	Y35, Y39, Y750, Y46*, PAT750	Color Code		Die Index								
YA5C2N	1	5 AWG	-	1/2"	1-3/4"	.83"	1.12"	.12"	4.43"	MY29-3 (2) MY29-1 (2) MRC840 (2) Y644M (1)	W5CRT (2) W5CVT (2) X5CRT (2)	X5CRT (2) X5CVT (2) W5CRT (2)	U5CRT (2)	Blue	7	1-3/16"								
YA5C2N-45	2																							
YA5C2N-90	3																							
YA4C2N	1	4 AWG	-	1/2"	1-3/4"	.81"	1.12"	.12"	4.45"	Y1MR (4) Y2MR (4) MY29-3 (2) MY29-11 (2) MRC840 (2) Y644M (1)	W4CVT (2) W4CRT (2) X4CRT (2)	W4CVT (2) W4CRT (2) X4CRT (2)	U4CRT (2) U6CABT (2)	Gray	8	1-3/16"								
YA4C2N-45	2																							
YA4C2N-90	3																							
YA4C2TC14	1			1/4"	5/8"	.50"	1.12"	.09"	2.70"								2.51"	2.83"	2.64"	1.66"	3.26"	3.03"	2.09"	
YA4C2TC14-45	2																							
YA4C2TC14-90	3			1/4"	3/4"	.50"	1.12"	.09"	2.64"								1.66"	3.26"	3.03"	2.09"				
YA4C2TC14E2	1																							
YA4C2TC14E2-45	2			1/4"	3/4"	.50"	1.12"	.09"	2.64"								1.66"	3.26"	3.03"	2.09"				
YA4C2TC14E2-90	3																							
YA4C2TC38	1			3/8"	1"	.56"	1.12"	.08"	3.03"								2.09"							
YA4C2TC38-45	2																							
YA4C2TC38-90	3	3/8"	1"	.56"	1.12"	.08"	3.03"	2.09"																
YA4C2TC38E2	1																							
YA4C2TC38E2-45	2	3/8"	3/4"	.58"	1.25"	.08"	2.91"	1.86"																
YA4C2TC38E2-90	3																							
YA3C2N	1	#3 STR	25	1/2"	1-3/4"	.81"	1.25"	.12"	4.62"	Y1MR (4) Y2MR (4) MY29-3 (2) MY29-11 (2) MRC840 (2) Y644M (1)	W3CRT (2)	W3CRT (2)	U3CRT (2)	White	9	1-5/16"								
YA3C2N-45	2																							
YA3C2N-90	3																							
YA3C2TC14	1			1/4"	5/8"	.55"	1.25"	.09"	2.87"								2.62"	1.55"	2.99"	2.75"	1.68"	3.43"	3.16"	2.11"
YA3C2TC14-45	2																							
YA3C2TC14-90	3			1/4"	3/4"	.55"	1.25"	.09"	2.75"								1.68"	3.43"	3.16"	2.11"				
YA3C2TC14E2	1																							
YA3C2TC14E2-45	2			1/4"	3/4"	.55"	1.25"	.09"	2.75"								1.68"	3.43"	3.16"	2.11"				
YA3C2TC14E2-90	3																							
YA3C2TC38	1			3/8"	1"	.58"	1.25"	.08"	3.43"								3.16"	2.11"						
YA3C2TC38-45	2																							
YA3C2TC38-90	3	3/8"	3/4"	.58"	1.25"	.08"	3.43"	3.16"	2.11"															
YA3C2TC38E2	1																							
YA3C2TC38E2-45	2	3/8"	3/4"	.58"	1.25"	.08"	2.91"	1.86"																
YA3C2TC38E2-90	3																							
YA2C2N	1	#2 AWG	35	1/2"	1-3/4"	.81"	1.25"	.12"	4.64"	Y1MR (4) Y2MR (4) MY29-3 (2) MY29-11 (2) MRC840 (2) Y644M (1)	W2CVT (2) W2CRT (2) X2CRT (2)	W2CVT (2) W2CRT (2) X2CRT (2)	U2CRT (2)	Brown	10	1-5/16"								
YA2C2N-45	2																							
YA2C2N-90	3																							
YA2C2TC14	1			1/4"	5/8"	.60"	1.25"	.11"	2.86"								2.66"	1.58"	2.98"	2.78"	1.71"	3.17"	2.97"	1.90"
YA2C2TC14-45	2																							
YA2C2TC14-90	3			1/4"	3/4"	.60"	1.25"	.11"	2.86"								2.66"	1.58"	2.98"	2.78"	1.71"	3.17"	2.97"	1.90"
YA2C2TC14E2	1																							
YA2C2TC14E2-45	2			1/4"	3/4"	.60"	1.25"	.11"	2.86"								2.66"	1.58"	2.98"	2.78"	1.71"	3.17"	2.97"	1.90"
YA2C2TC14E2-90	3																							
YA2C2TC38E2	1			3/8"	3/4"	.60"	1.25"	.11"	3.17"								2.97"	1.90"	3.05"	2.84"	1.77"	4.17"	3.97"	
YA2C2TC38E2-45	2																							
YA2C2TC38E2-90	3			3/8"	3/4"	.60"	1.25"	.11"	3.17"								2.97"	1.90"	3.05"	2.84"	1.77"	4.17"	3.97"	
YA2C2TC516E2	1																							
YA2C2TC516E2-45	2			5/16"	3/4"	.60"	1.25"	.11"	2.84"								1.77"	4.17"	3.97"					
YA2C2TC516E2-90	3																							
YA2C2NTC38	1			3/8"	1-3/4"	.60"	1.25"	.11"	4.17"								3.97"							
YA2C2NTC38-45	2																							
YA2C2NTC38-90	3																							

▲ See tooling section of this catalog for complete tool and die listings.

\* Use PUADP-1 adaptor with "U" -dies in Y46 HYPRESS™.

\*\* P-RT die sets for use in Y46 HYPRESS™ only, PUADP-1 adaptor not required.

\*\*\* The MM<sup>2</sup> conductor sizes listed are the recommendations for Class 2 conductor.

" Available undrilled. Add suffix "U" to catalog number (example: YA25U).

◆ For applications greater than 2000 Volts consult cable manufacturer for voltage stress relief instructions.

## TWO HOLE HYLUG™ CODE CONDUCTOR LONG BARREL (Continued)

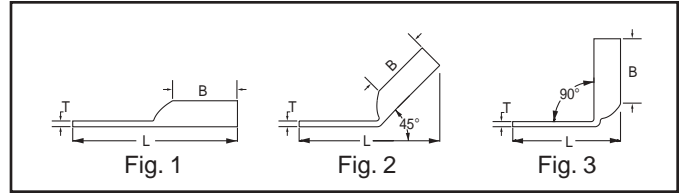
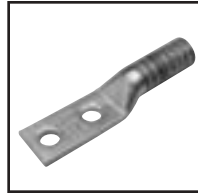

Catalog Number	Fig #	Conductor		Stud Hole Size	Stud Hole Spacing	Tongue Width	Figure Dimensions			▲ Installation Tooling						Wire Strip Length	
		AWG	MM <sup>2</sup>				(B)	(T)	(L)	Dieless (# of crimps)	Mechanical MD6, OUR840, MD7-34R	Hydraulic		Color Code	Die Index		
												BCT500HS, Y500CTHS	Y35, Y39, Y750, Y46*, PAT750				
YA2C2TC38	1	#2 AWG	35	3/8"	1"	.60"	1.25"	.11"	3.42"	Y1MR (4) Y2MR (4) MY29-3 (2) MY29-11 (2) MRC840 (2) Y644M (1)	W2CVT (2) W2CRT (2) X2CRT (2)	W2CVT (2) W2CRT (2) X2CRT (2)	U2CRT (2)	Brown	10	1-5/16"	
YA2C2TC38-45	2																3.22"
YA2C2TC38-90	3																2.14"
YA2C2TC38E6	1			3.30"													
YA2C2TC38E6-45	2			3.10"													
YA2C2TC38E6-90	3			2.02"													
YA2C2TC516E2	1			3.05"													
YA2C2TC516E2-45	2			2.84"													
YA2C2TC516E2-90	3			1.77"													
YA1C2N	1	1 AWG	50	1/2"	1-3/4"	.81"	1.38"	.12"	4.82"	Y1MR (4) MY29-3 (2) MY29-11 (2) MRC840 (2) Y644M (1)	W1CVT (2) W1CRT-1 (2) X1CRT-1 (2)	W1CVT (2) W1CRT-1 (2) X1CRT-1 (2)	U1CRT-1 (2) U4CABT (2)	Green	11	1-1/2"	
YA1C2N-45	2																4.58"
YA1C2N-90	3																3.36"
YA1C2TC14	1			3.03"													
YA1C2TC14-45	2			2.76"													
YA1C2TC14-90	3			1.60"													
YA1C2TC14E2	1			3.15"													
YA1C2TC14E2-45	2			2.88"													
YA1C2TC14E2-90	3			1.73"													
YA1C2TC38	1			3.59"													
YA1C2TC38-45	2			3.32"													
YA1C2TC38-90	3			2.16"													
YA252N	1			1/0 AWG	-	1/2"	1-3/4"	.81"	1.38"								.11"
YA252N-45	2	4.56"															
YA252N-90	3	3.38"															
YA252TC14	1	3.05"															
YA252TC14-45	2	2.82"															
YA252TC14-90	3	1.64"															
YA252TC14E2	1	3.18"															
YA252TC14E2-45	2	2.94"															
YA252TC14E2-90	3	1.76"															
YA252TC38	1	3.62"															
YA252TC38-45	2	3.38"															
YA252TC38-90	3	2.20"															
YA252TC516	1	3.49"															
YA252TC516-45	2	3.26"															
YA252TC516-90	3	2.08"															
YA252NTC38	1	4.37"															
YA252NTC38-45	2	4.13"															
YA252NTC38-90	3	2.95"															
YA262N	1	2/0 AWG	70			1/2"	1-3/4"	.83"	1.50"	.12"	4.97"	W26VT (4) W26RT (4) X26RT (4)	W26VT (4) W26RT (4) X26RT (4)	U26RT (2)	Black	13	1-9/16"
YA262N-45	2			4.69"													
YA262N-90	3			3.41"													
YA262TC14	1			3.22"													
YA262TC14-45	2			2.94"													
YA262TC14-90	3			1.66"													
YA262TC14E2	1			3.34"													
YA262TC14E2-45	2			3.06"													
YA262TC14E2-90	3			1.79"													

▲ See tooling section of this catalog for complete tool and die listings.  
 \* Use PUADP-1 adaptor with "U" -dies in Y46 HYPRESS™.  
 \*\* P-RT die sets for use in Y46 HYPRESS™ only, PUADP-1 adaptor not required.

\*\*\* The MM<sup>2</sup> conductor sizes listed are the recommendations for Class 2 conductor.  
 \* Available undrilled. Add suffix "U" to catalog number (example: YA25U).  
 ♦ For applications greater than 2000 Volts consult cable manufacturer for voltage stress relief instructions.