

4 in. Square boxes

Conduit knockouts

—
01 **BC52151-K**
Concentric knockouts.

—
02 **C152151-KSB**
Concentric knockouts with side bracket.

—
03 **BC52151-KSSX**
Concentric knockouts. “Wraparound” bracket for 2 1/2 in. and 3 5/8 in. steel studs. With integral support bracket. Mud / tile ring must be used.

—
04 **BC53151-K**
Concentric knockouts.



—
01



—
02



—
03



—
04



Cat. No.	Volume (Cu. in.)	Bracket	Features				Knockouts	
			Raised Ground Screw	1/2 in. sides	1/2 in. bottom	3/4 in. sides	3/4 in. bottom	
1 1/2 in. deep								
BC52151-K	21.0	—	yes	10	4	6	2	2
C152151-KSB	21.0	“SB”	yes	8	4	4	2	2
BC52151-KSSX	21.0	“SSX”	yes	7	4	3	2	2
BC53151-K	21.0	—	—	10	—	6	—	—

4 in. Square boxes

Conduit knockouts

01 BC52171-HV-KIT

02 BC52171-KSSXHVKIT

03 CI52171-1-SSX-1
"Wraparound" bracket for 2 1/2 in. and 3 5/8 in. steel studs. With integral support bracket. Brackets are positioned so the front of the box will be flush with 1/2" drywall.

04 CI52171-1
1 in. knockout

05 BC52171-K
Concentric knockouts. 1 in. knockout

06 CI52171-KSB
Concentric knockouts with side bracket.

07 BC52171-KSSX
Concentric knockouts. "Wraparound" bracket for 2 1/2 in. and 3 5/8 in. steel studs. With integral support bracket. Mud / Tile ring must be used.

08 CI52171-KSSX-1
Concentric knockouts. "Wraparound" bracket for 2 1/2 in. and 3 5/8 in. steel studs. With integral support bracket. Brackets are positioned so the front of the box will be flush with 1/2" drywall.

09 BC53171-K
Concentric knockouts.



01



02



03



04



05



06



07



08



09



Cat. No.	Volume (Cu. in.)	Features			Knockouts				
		Bracket	Raised Ground Screw		1/2 in. sides	1/2 in. bottom	3/4 in. sides	3/4 in. bottom	1 in. sides
2 1/8 in. deep									
BC52171-HV-KIT*	33.6	-	yes		6	-	2	-	-
BC52171-KSSXHVKIT*	33.6	"SSX"	yes		6	-	2	-	-
CI52171-1	30.0	-	yes		-	4	-	2	4
CI52171-1-SSX	21.0	"SSX"	yes		-	4	-	2	2
CI52171-1-SSX-1	21.0	"SSX"	yes		-	4	-	2	2
BC52171-K	30.0	-	yes		10	4	6	2	-
CI52171-KSB	30.0	"SB"	yes		8	4	4	2	-
BC52171-KSSX	30.0	"SSX"	yes		7	4	3	2	-
CI52171-KSSX-1	30.0	"SSX"	yes		7	4	3	2	-
BC52171-K	30.0	-	-		10	-	6	-	-

* Must be purchased as a kit. The tile ring cover alone as well as the box alone are not available.

4 in. Square boxes

Mud / plaster ring covers



BC52-C-1



BC52-C-6



52C31/2-25



BC52-C-0



CI52-C-10 to CI-52-C-62



BC52-C-0-B

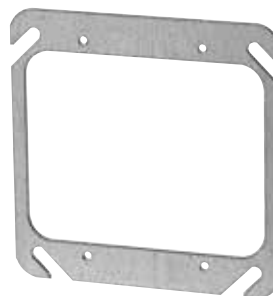

BC52-C-00



BC52-C-17



Cat. No.	Description
Flat covers	
BC52-C-1	Blank
BC52-C-6	1/2 in. conduit knockout
Plaster ring cover	
52C31/2-25*	Raised 1/2 in. (3.5 cu. in.) Tapped ears on 2 3/4 in. centers
Single device covers	
BC52-C-0	Flat
BC52-C-0-B	Flat blank cover
CI52-C-10	Raised 1/8 in. (1.0 cu. in.)
BC52-C-13	Raised 1/2 in. (3.6 cu. in.)
CI52-C-14	Raised 3/4 in. (5.7 cu. in.)
CI52-C-14-5/8	Raised 5/8 in. (4.3 cu. in.)
CI52-C-15	Raised 7/8 in. (6.8 cu. in.)
CI52-C-16	Raised 1 1/4 in. (9.5 cu. in.)
CI52-C-62	Raised 1/4 in. (1.8 cu. in.)
Two device covers	
BC52-C-00	Flat
BC52-C-17	Raised 1/2 in. (6.2 cu. in.)
52 C 18*	Raised 3/4 in. (9.0 cu. in.)
52C185/8-25*	Raised 5/8 in. (7.3 cu. in.)

* UL Listed and CSA certified