



MR16 Open

EYE's Open MR16 lamps offer consistent white colour and brightness with a special long lasting dichroic coating to keep the fixture cool, perfect for many applications.

Features

- Crisp white light
- Long life
- Long lasting dichroic coating
- Precise optical design

Applications

- Retail stores
- Offices
- Landscapes
- Display cases
- Residential
- Track and recessed lighting

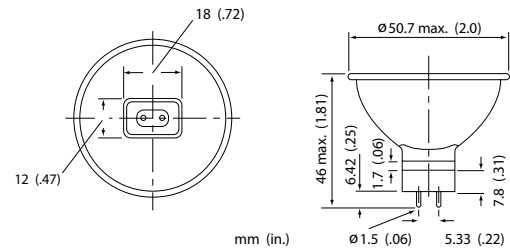

Order code	Description	ANSI code	Watts (W)	Base	Volts (V)	Colour temp. (K)	Beam angle (°)	CBCP*	Average life (hrs)	MOL** (in.) (mm)	Pack/Case Qty
------------	-------------	-----------	-----------	------	-----------	------------------	----------------	-------	--------------------	------------------	---------------

MR16 Open

15327	20MR16/SP ESX EYE	ESX	20	GU5.3	12	2 950	12	4 300	4 000	1.81 46	12/120
30354	20MR16/NFL BBF EYE	BBF	20	GU5.3	12	2 950	23	950	4 000	1.81 46	12/120
15328	20MR16/FL BAB EYE	BAB	20	GU5.3	12	2 950	36	525	4 000	1.81 46	12/120
30359	35MR16/SP FRB EYE	FRB	35	GU5.3	12	3 050	12	8 000	5 000	1.81 46	12/120
30362	35MR16/NFL FRA EYE	FRA	35	GU5.3	12	3 050	23	2 500	5 000	1.81 46	12/120
30363	35MR16/FL FMW EYE	FMW	35	GU5.3	12	3 050	36	1 200	5 000	1.81 46	12/120
30372	42MR16/FL EYP EYE	EYP	42	GU5.3	12	3 050	36	1 200	5 000	1.81 46	12/120
15329	50MR16/SP EXT EYE	EXT	50	GU5.3	12	3 050	12	10 500	5 000	1.81 46	12/120
15330	50MR16/NFL EXZ EYE	EXZ	50	GU5.3	12	3 050	24	3 400	5 000	1.81 46	12/120
15331	50MR16/MFL ENL EYE	ENL	50	GU5.3	12	3 050	32	2 450	5 000	1.81 46	12/120
15333	50MR16/FL EXN EYE	EXN	50	GU5.3	12	3 050	36	1 750	5 000	1.81 46	12/120
15334	50MR16/SP EPZ EYE	EPZ	50	GU5.3	12	3 150	12	12 500	1 000	1.81 46	12/120
30379	50MR16/WFL FNV EYE	FNV	50	GU5.3	12	3 050	55	750	5 000	1.81 46	12/120

* Center Beam Candle Power
** Conversions may vary slightly



MR16 Open



Photometrics

MR16 Open

20 watts

Beam angle: 12°

Ø (in.)	H(ft)	(fc)
8 7/32	3' 3 3/8"	399
16 7/16	6' 6 3/4"	100
24 13/16	9' 10 1/8"	45

15327

Beam angle: 23°

Ø (in.)	H(ft)	(fc)
9 1/16	3' 3 3/8"	88
16 7/16	6' 6 3/4"	22
24 13/16	9' 10 1/8"	10

30354

Beam angle: 36°

Ø (in.)	H(ft)	(fc)
25 3/16	3' 3 3/8"	47
50 25/32	6' 6 3/4"	11
76 3/8	9' 10 1/8"	5

15328

35 watts

Beam angle: 12°

Ø (in.)	H(ft)	(fc)
8 7/32	3' 3 3/8"	720
16 7/16	6' 6 3/4"	180
24 13/16	9' 10 1/8"	79

30359

Beam angle: 23°

Ø (in.)	H(ft)	(fc)
15 3/4	3' 3 3/8"	225
31 7/8	6' 6 3/4"	56
48 1/2	9' 10 1/8"	24

30362

Beam angle: 36°

Ø (in.)	H(ft)	(fc)
25 3/16	3' 3 3/8"	108
50 25/32	6' 6 3/4"	27
76 3/8	9' 10 1/8"	12

30363

42 watts

Beam angle: 36°

Ø (in.)	H(ft)	(fc)
25 3/16	3' 3 3/8"	108
50 25/32	6' 6 3/4"	27
76 3/8	9' 10 1/8"	12

30372

50 watts

Beam angle: 12°

Ø (in.)	H(ft)	(fc)
8 7/32	3' 3 3/8"	836
16 7/16	6' 6 3/4"	21
24 13/16	9' 10 1/8"	9

15334

Beam angle: 12°

Ø (in.)	H(ft)	(fc)
8 7/32	3' 3 3/8"	945
16 7/16	6' 6 3/4"	237
24 13/16	9' 10 1/8"	105

15329

Beam angle: 24°

Ø (in.)	H(ft)	(fc)
16 7/16	3' 3 3/8"	306
33 19/32	6' 6 3/4"	77
50	9' 10 1/8"	33

15330

Beam angle: 32°

Ø (in.)	H(ft)	(fc)
22 7/16	3' 3 3/8"	228
44 3/8	6' 6 3/4"	57
67 5/16	9' 10 1/8"	25

15331

Beam angle: 36°

Ø (in.)	H(ft)	(fc)
25 3/16	3' 3 3/8"	158
50 25/32	6' 6 3/4"	39
76 3/8	9' 10 1/8"	17

15333

Beam angle: 55°

Ø (in.)	H(ft)	(fc)
40 15/16	3' 3 3/8"	68
81 7/8	6' 6 3/4"	16
122 27/32	9' 10 1/8"	7

30379