

IPEX CONDUIT/DUCT SPACERS

PRODUCT INFORMATION BULLETIN

CONDUIT/DUCT SPACERS

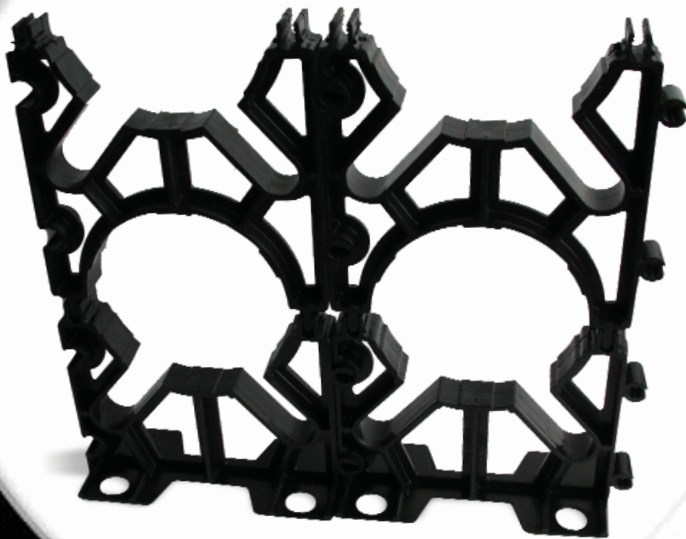

IPEX offers a wide range of conduit/duct spacers to suit all your underground needs. Our spacers offer consistent operation, stability and relieve direct stress for duct materials that have to be encased in concrete.

Recommended Distance: 6' - 7'

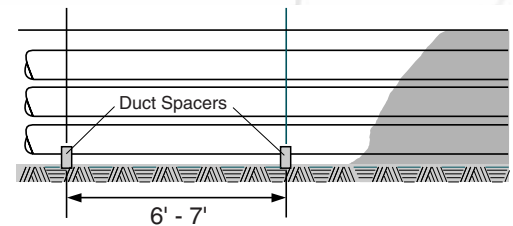

FEATURES:

- Integral holes offering base spacer fastening & stabilization
- Molded rebar slots allowing quick & efficient installation of full length rebar

Interlocking Spacer Assembly Dimensions

Dimension (in.)	A (in.)	A1(in.)	B (in.)	B1 (in.)
2 x 1-1/2	1-1/2	3	3-15/16	4-7/32
2 x 2	2	3	4-7/16	4-7/32
2 x 3	3	3	5-7/16	4-7/32
3 x 2	2	3	5-5/8	4-25/32
4 x 2	2	3-1/16	6-5/8	5-3/8
4 x 3	3	3-1/16	7-5/8	5-3/8
5 x 2	2-3/16	3-3/16	7-13/16	6
5 x 3	3-3/16	3-3/16	8-7/8	6
6 x 3	3	3	9-3/4	6-3/8

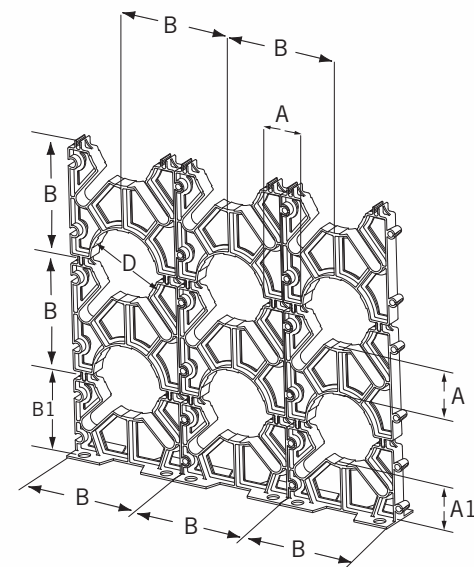

Products manufactured by IPEX Electrical Inc.

Canadian Customers call IPEX Electrical Inc.

Toll Free: (866) 473-9462
www.ipexelectrical.com

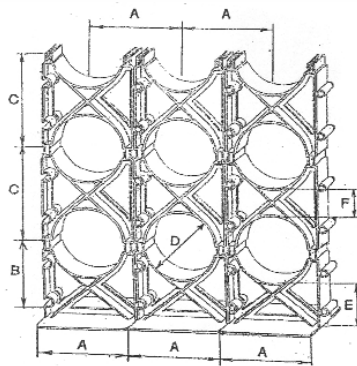

Conduit/Duct Spacers*

Dimension (in.)	A	B	E	F
3 x 1-1/2	5.130	4.615	3,000	1.50
3 x 3	6.630	4.615	3,000	3.00
4 x 1	5.630	4.060	1,750	1.00
4 x 1-1/2	6.130	5.315	3,000	1.50
5 x 1-1/2	7.325	6.900	3,000	1.50
6 x 1-1/2	8.230	6.375	3,000	1.50

* Do not have rebar slots or base holes

Intermediate Vertical-Lok Spacers

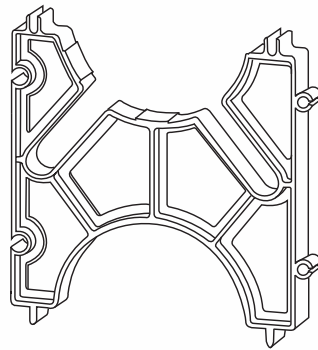

Dimension (in.)	Part Number	Product Code	Standard Package
2 x 1-1/2	IS3530	029550	200
2 x 2	IS3535	029551	200
2 x 3	IS3545	029552	150
* 3 x 1-1/2	IS4530	029553	250
3 x 2	IS4530	029554	100
* 3 x 3	IS4530	029555	160
* 4 x 1	IS5530	029556	250
* 4 x 1-1/2	IS5530	029557	180
4 x 2	IS5530	029558	100
4 x 3	IS5530	029559	60
* 5 x 1-1/2	IS6030	029560	140
5 x 2	IS6035	029561	60
5 x 3	IS6045	029562	60
* 6 x 1-1/2	IS6530	029563	100
6 x 2	IS6535	029564	100
6 x 3	IS6545	029565	40

Base Vertical-Lok Spacers

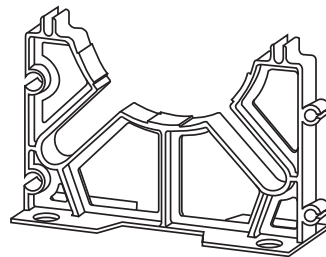

Dimension (in.)	Part Number	Product Code	Standard Package
2 x 1-1/2	BS3530	029566	150
2 x 2	BS3535	029567	150
2 x 3	BS3545	029568	100
* 3 x 1-1/2	BS4530	029569	250
3 x 2	BS4530	029570	100
* 3 x 3	BS4530	029571	190
* 4 x 1	BS5530	029572	250
* 4 x 1-1/2	BS5530	029573	180
4 x 2	BS5530	029574	80
4 x 3	BS5530	029575	60
* 5 x 1-1/2	BS6030	029576	140
5 x 2	BS6035	029577	60
5 x 3	BS6045	029578	50
* 6 x 1-1/2	BS6530	029579	100
6 x 2	BS6535	029580	100
6 x 3	BS6545	029581	40

* Do not have rebar slots or base holes

Canadian Customers call IPEX Electrical Inc.

Toll Free: (866) 473-9462

www.ipexelectrical.com