

WMFB1SRKS1N Series Single-Gang Floor Box Assembly

WMFB1SRKS1N

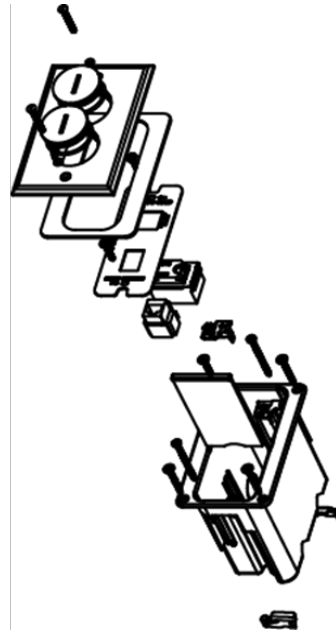

features & benefits

Includes single-gang box, divider, one 15A, 125V receptacle, one opening for communication device, and nickel cover with two screw plugs. For hole cut dimensions, see installation instructions sheet. Box Dimensions: 2 1/8" W x 3 3/4" L x 3 7/8" D [54mm W x 95mm L x 98mm D] Device Plate: 3 1/8" W x 4 15/16" L [79mm W x 125mm L].

specifications

Buy American Act Compliance

Country of Origin: CHINA
Buy American Act Status: No