

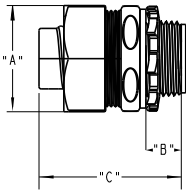

Liquidtight conduit

Malleable iron fittings

- Heavy-duty malleable iron
- Zinc electroplated for corrosion resistance
- Tapered threaded hub complete with flange gasket and steel locknut
- Temperature range: -25 °C to 90 °C

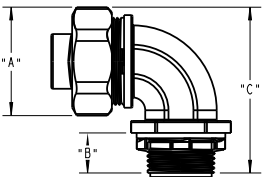

Cat. no.	Trade size (in.)	KO size (in.)	Dimensions (in.)				
			A	B	C		
Straight liquidtight fittings (steel)							
 CI6103 (-IT) / CI6116 (-IT) IT: with insulated throat		CI6103	$\frac{3}{8}$	$\frac{1}{2}$	$1\frac{1}{16}$	$\frac{9}{16}$	$1\frac{3}{8}$
		CI6104	$\frac{1}{2}$	$\frac{1}{2}$	$1\frac{3}{16}$	$\frac{9}{16}$	$1\frac{3}{4}$
		CI6106	$\frac{3}{4}$	$\frac{3}{4}$	$1\frac{7}{16}$	$\frac{9}{16}$	$1\frac{5}{8}$
		CI6108	1	1	$1\frac{11}{16}$	$\frac{11}{16}$	$2\frac{3}{16}$
		CI6110	$1\frac{1}{4}$	$1\frac{1}{4}$	$2\frac{1}{8}$	$\frac{11}{16}$	$2\frac{3}{8}$
		CI6112	$1\frac{1}{2}$	$1\frac{1}{2}$	$2\frac{3}{8}$	$\frac{11}{16}$	$2\frac{9}{16}$
CI6116	2	2	$2\frac{15}{16}$	$\frac{13}{16}$	$2\frac{3}{4}$		
Straight liquidtight fittings – insulated throat (malleable iron)							
CI6103-IT	$\frac{3}{8}$	$\frac{1}{2}$	$1\frac{1}{16}$	$\frac{9}{16}$	$1\frac{3}{8}$		
CI6104-IT	$\frac{1}{2}$	$\frac{1}{2}$	$1\frac{3}{16}$	$\frac{9}{16}$	$1\frac{3}{4}$		
CI6106-IT	$\frac{3}{4}$	$\frac{3}{4}$	$1\frac{7}{16}$	$\frac{9}{16}$	$1\frac{5}{8}$		
CI6108-IT	1	1	$1\frac{11}{16}$	$\frac{11}{16}$	$2\frac{3}{16}$		
CI6110-IT	$1\frac{1}{4}$	$1\frac{1}{4}$	$2\frac{1}{8}$	$\frac{11}{16}$	$2\frac{3}{8}$		
CI6112IT	$1\frac{1}{2}$	$1\frac{1}{2}$	$2\frac{3}{8}$	$\frac{11}{16}$	$2\frac{9}{16}$		
CI6116-IT	2	2	$2\frac{15}{16}$	$\frac{13}{16}$	$2\frac{3}{4}$		
90° liquidtight fittings (malleable iron)							
 CI6303 (-IT) / CI6316 (-IT) IT: with insulated throat		CI6303	$\frac{3}{8}$	$\frac{1}{2}$	$1\frac{1}{16}$	$\frac{9}{16}$	2
		CI6304	$\frac{1}{2}$	$\frac{1}{2}$	$1\frac{3}{16}$	$\frac{9}{16}$	$2\frac{1}{16}$
		CI6306	$\frac{3}{4}$	$\frac{3}{4}$	$1\frac{7}{16}$	$\frac{9}{16}$	$2\frac{1}{2}$
		CI6308	1	1	$1\frac{11}{16}$	$\frac{11}{16}$	$2\frac{15}{16}$
		CI6310	$1\frac{1}{4}$	$1\frac{1}{4}$	$2\frac{1}{8}$	$\frac{11}{16}$	$3\frac{3}{16}$
		CI6312	$1\frac{1}{2}$	$1\frac{1}{2}$	$2\frac{3}{8}$	$\frac{11}{16}$	$3\frac{1}{2}$
CI6316	2	2	$2\frac{15}{16}$	$\frac{13}{16}$	$4\frac{5}{16}$		
90° liquidtight fittings – insulated throat (malleable iron)							
CI6303-IT	$\frac{3}{8}$	$\frac{1}{2}$	$1\frac{1}{16}$	$\frac{9}{16}$	2		
CI6304-IT	$\frac{1}{2}$	$\frac{1}{2}$	$1\frac{3}{16}$	$\frac{9}{16}$	$2\frac{1}{16}$		
CI6306-IT	$\frac{3}{4}$	$\frac{3}{4}$	$1\frac{7}{16}$	$\frac{9}{16}$	$2\frac{1}{2}$		
CI6308-IT	1	1	$1\frac{11}{16}$	$\frac{11}{16}$	$2\frac{15}{16}$		
CI6310-IT	$1\frac{1}{4}$	$1\frac{1}{4}$	$2\frac{1}{8}$	$\frac{11}{16}$	$3\frac{3}{16}$		
CI6312IT	$1\frac{1}{2}$	$1\frac{1}{2}$	$2\frac{3}{8}$	$\frac{11}{16}$	$3\frac{1}{2}$		
CI6316-IT	2	2	$2\frac{15}{16}$	$\frac{13}{16}$	$4\frac{5}{16}$		

Liquidtight conduit

Zinc alloy fittings



CI6603 (-IT) / CI6632 (-IT)
IT: with insulated throat

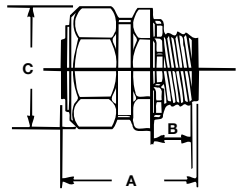

Cat. no.	Trade size (in.)	KO size (in.)	Dimensions (in.)		
			A	B	C
Straight liquidtight fittings (zinc alloy)					
CI6603	3/8	1/2	1.58	0.53	1.18
CI6604	1/2	1/2	1.52	0.53	1.29
CI6606	3/4	3/4	1.69	0.53	1.57
CI6608	1	1	2.06	0.58	1.81
CI6610	1 1/4	1 1/4	2.06	0.61	2.18
CI6612	1 1/2	1 1/2	2.09	0.63	2.51
CI6616	2	2	2.15	0.63	3.03
CI6620	2 1/2	2 1/2	3.54	1.02	3.68
CI6624	3	3	4.05	1.07	4.38
CI6632	4	4	4.99	1.15	5.54

Straight liquidtight fittings – insulated throat (zinc alloy)

CI6603-IT	3/8	1/2	1.66	0.63	1.18
CI6604-IT	1/2	1/2	1.62	0.63	1.29
CI6606-IT	3/4	3/4	1.79	0.63	1.57
CI6608-IT	1	1	2.16	0.68	1.81
CI6610-IT	1 1/4	1 1/4	2.16	0.71	2.18
CI6612-IT	1 1/2	1 1/2	2.19	0.73	2.51
CI6616-IT	2	2	2.25	0.73	3.03
CI6620-IT	2 1/2	2 1/2	3.64	1.12	3.68
CI6624-IT	3	3	4.15	1.17	4.38
CI6632-IT	4	4	5.09	1.25	5.54



CI6703 (-IT) / CI6716 (-IT)
IT: with insulated throat

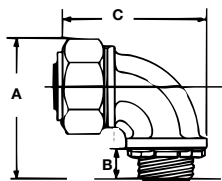

90° liquidtight fittings (zinc alloy)

CI6703	3/8	1/2	2.11	0.53	2.53
CI6704	1/2	1/2	2.24	0.53	2.46
CI6706	3/4	3/4	2.47	0.55	2.79
CI6708	1	1	3.46	0.58	3.86
CI6710	1 1/4	1 1/4	3.37	0.67	3.99
CI6712	1 1/2	1 1/2	4.28	0.61	5.04
CI6716	2	2	4.21	0.71	5.06
LT-297	2 1/2	2 1/2	4.32	0.88	3.65
LT-298	3	3	4.81	0.88	4.32
LT-2910	4	4	5.32	0.88	5.32

90° liquidtight fittings – insulated throat (zinc alloy)

CI6703-IT	3/8	1/2	2.27	0.63	2.53
CI6704-IT	1/2	1/2	2.24	0.63	2.46
CI6706-IT	3/4	3/4	2.54	0.65	2.79
CI6708-IT	1	1	3.25	0.68	3.86
CI6710-IT	1 1/4	1 1/4	3.50	0.77	3.99
CI6712-IT	1 1/2	1 1/2	4.30	0.71	5.04
CI6716-IT	2	2	5.16	0.81	5.06

Tapered threaded hub complete with zinc die cast locknut