

Pin terminals



- Provide an easy and effective way to terminate stranded wire into European/metric style terminal blocks
- Designed to prevent shorting, wire strand loss and/or wire pullout resulting from improper termination of stranded wire
- Designed to meet emerging global standards that require wire-to-metric style terminal block installations be terminated with a “pin” style terminal
- Available in vinyl-insulated, nylon-insulated and non-insulated styles
- All styles offered in 22 AWG to 10 AWG and compatible with existing Sta-Kon tooling



Cat. no.	Pkg. qty.	Wire range (AWG)	D (Dia.) (in.)	L (in.)	Rec. tool	Stock thick. (in.)
Non-insulated						
A47PT	1,000	22–18	0.075	0.63	ERG4002	0.02
B47PT	1,000	16–14	0.075	0.63	ERG4002	0.03
C55PT	500	12–10	0.106	0.76	ERG4002	0.04
Vinyl						
18RA-47PT	100	22–18	0.075	0.85	ERG4001	0.02
RA47PT	1,000	22–18	0.075	0.85	ERG4001	0.02
14RB-47PT	100	16–14	0.075	0.87	ERG4001	0.03
RB47PT	1,000	16–14	0.075	0.87	ERG4001	0.03
10RC-55PT	50	12–10	0.106	1.04	ERG4001	0.04
RC55PT	500	12–10	0.106	1.04	ERG4001	0.04
Nylon						
RA18-47PT	100	22–18	0.075	0.85	ERG4001	0.02
RA147PT	1,000	22–18	0.075	0.85	ERG4001	0.02
RB14-47PT	100	16–14	0.075	0.87	ERG4001	0.03
RB147PT	1,000	16–14	0.075	0.87	ERG4001	0.03
RC10-55PT	50	12–10	0.106	1.04	ERG4001	0.04
RC155PT	500	12–10	0.106	1.04	ERG4001	0.04

Diagrams

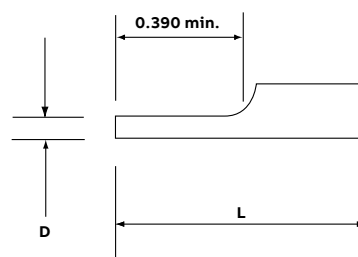

01 Non-insulated pin terminal

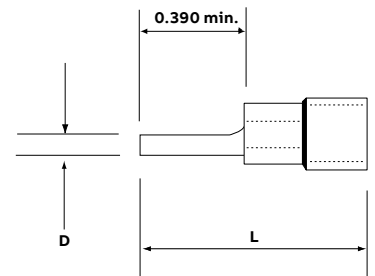

02 Insulated pin terminal