



High Output T12

F84T12 D HO ALTO 1LP

Philips T12 fluorescent lamps provide high performance in a wide range of sizes, shapes, and types.

Product data

| General Information | |
|-----------------------|--------------------|
| Cap-Base | R17D [R17d (RDC)] |
| Life 3-Hr Start [Hrs] | 12000 h |
| Features | ALTO® (ALTO) |

| Light Technical | |
|------------------------------------|----------|
| Color Code | 54 |
| Luminous Flux (Nom) | 6625 lm |
| Color Designation | Daylight |
| Design Mean Lumens | 6000 lm |
| Correlated Color Temperature (Nom) | 6500 K |
| Color Rendering Index (Nom) | 79 |

| Operating and Electrical | |
|--------------------------|-------|
| Power (Rated) (Nom) | 100 W |

| Mechanical and Housing | |
|------------------------|------------|
| Cap-Base Information | Green Base |

| | |
|-----------------------|----|
| Nominal Length (Inch) | 84 |
|-----------------------|----|

| Approval and Application | |
|----------------------------|--------|
| Mercury (Hg) Content (Nom) | 6.8 mg |

| Product Data | |
|---------------------------------|----------------------|
| Order product name | F84T12 D HO ALTO 1LP |
| EAN/UPC - Product | 046677234539 |
| Order code | 927894405401 |
| Numerator - Quantity Per Pack | 1 |
| Numerator - Packs per outer box | 15 |
| Material Nr. (12NC) | 927894405401 |
| Net Weight (Piece) | 0.001 kg |

High Output T12

Dimensional drawing

Product

F84T12 D HO ALTO 1LP

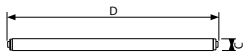

T12 Revised Double Contact

F84T12 100W/54 HO ALTO

