

Project:
Type:
Date:
Product Code:
Approval:



Flexibility and performance driven fluorescent lighting.

BRF8

8' strip conversion kit. It has been designed to convert existing 8 foot strip fixtures to T8 from T12 lighting. Its flexibility is ideally suited for existing fixtures that require improved energy-efficiency and performance.

FEATURES

- Universal style brackets
- 3 Sizes available: 3/4, 4/5, and 5/6 inches
 - 3/4 kit will cover a 3 to 4 inch wide existing fixture
 - 4/5 kit will cover a 4 to 5 inch wide existing fixture
 - 5/6 kit will cover a 5 to 6 inch wide existing fixture
- Pre-painted white steel ballast covers available
- Reflectors available in pre-painted high-reflectance white steel, white aluminum or specular aluminum
- Available with 2, 4, and 6 lamp cross sections
 - 2 lamp min. of 3" wide
 - 3 lamp min. of 4" wide

APPLICATIONS

- Existing fluorescent strip and industrial fixtures

APPROVALS

- CSA approved for Canada and USA

OPTICS

Conversion kit converts existing fixtures to 8' T8 lighting, increasing performance and reducing energy consumption.

MOUNTING

The kit has been designed to be retrofitted into existing fluorescent strip fixtures using self-tapping screws.

CONSTRUCTION

Universal brackets, reflectors, and ballast covers are available in a variety of widths to retrofit any sized fixture. This kit is available to convert existing strip or industrial fixtures to T8 lighting.

This product is fully customizable, please consult the factory for more information



Product Dimensions

Side View

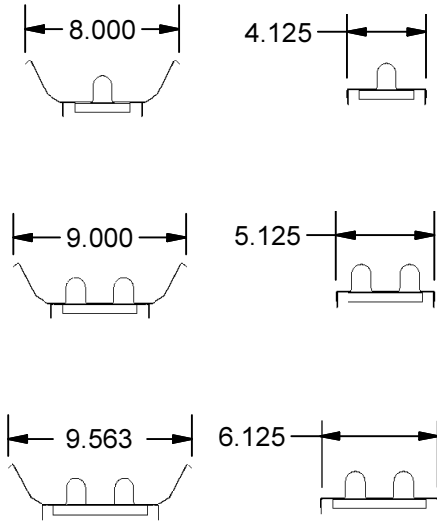

End View

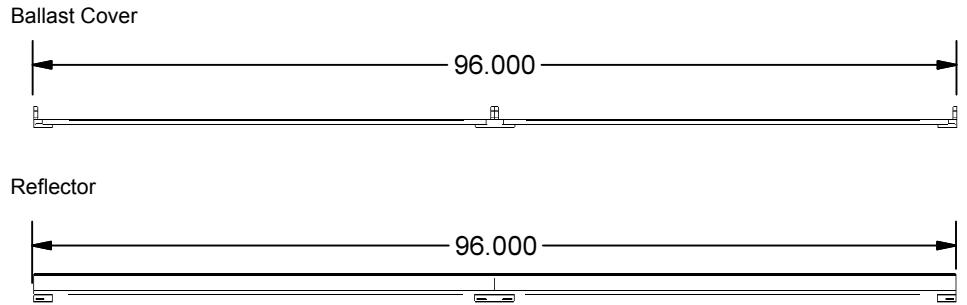

Universal Bracket Widths	Ballast Cover Width	Reflector Width
3/4	4.125	8.000
4/5	5.125	9.000
5/6	6.125	9.563

* All measurements are in inches

Product Key

Retrofit Type	Fixture Length	Fixture Width	Number of Lamps		Sockets	Options Covers	Leads
BRF	8'	-	-	BR, SC,	-	-	-
		3/4	2		SK	BC	LDS
		4/5	4		USK	R1	Blank
		5/6	6			R2	
						R3	
						Blank	

Options

Standard Parts	Covers	Leads
BR - Brackets	BC - Ballast Cover	LDS - Color Coded Leads #18 TEW
SC - Screws	R1 - White Steel Reflector	Solid Wire
	R2 - White Aluminum Reflector	Blank - No Leads
Sockets	R3 - Specular Aluminum Reflector	
SK - Shunted Sockets	Blank - Bracket Kit Only	
USK - Unshunted Sockets		

This product is fully customizable, please consult the factory for more information

