

# OVS

## Residential Wall Fan Heater



# OVRP

## Residential Ceiling Fan Heater

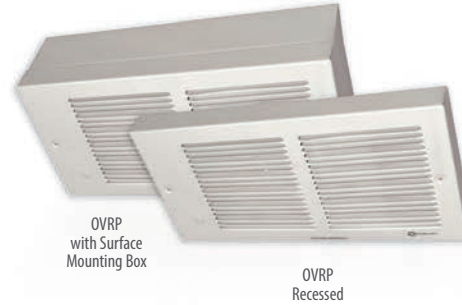

### Features

#### Color

- Standard: white, almond.
- Optional (upcharge applicable): metallic silver, bronze, metallic charcoal, aluminum, semi-gloss black, sand.
- Custom colors available upon request.

#### Finish

- Standard: epoxy/polyester powder paint.

#### Construction

- 20-gauge steel cabinet.
- 22-gauge steel front cover.
- High-limit temperature control with automatic reset.

#### Fan

- Quiet fan operating.
- 120V, 208V, 240/208V models: 500W to 1000W; 40 cfm fan and 1250W to 2000W; 80 cfm fan.
- 347V models : 80 cfm fan.
- Factory-lubricated motor.

#### Heating element

- 120V, 208V, 208/240V: durable tubular heating element with fins.
- Factory sealed element available.
- 347V: Iron-Chromium-Aluminum alloy.

#### Control

- If an electronic thermostat is used, it must be compatible with forced-air heaters.

#### Installation

- Quick installation with recess box mounting holes.
- Large wiring compartment.
- Surface mounting box available.
- Tight fit with V-shaped recess box.

#### Warranty

- 5-year warranty against defects.

#### Application

- Entrance way, kitchen, bathroom, family room, basement.

### OVS Features

#### Voltage

- 120V, 208V, 240/208V, 347V, 1-phase.

#### Control

- Built-in thermostat available with a control knob or tamperproof.

#### Installation

- Wall installation only.
- The air outlet should be installed at least 10 in. (25.4 cm) above floor.
- May be recessed in 2 in. X 3 in. stud partitions.

### OVRP Features

#### Voltage

- 120V, 240/208V, 347V, 1-phase.

#### Control

- Must be used with a compatible wall thermostat (not included).

#### Installation

- Ceiling installation only.
- The air outlet should be installed at least 10 in. (25.4 cm) from the wall.
- May be recessed in ceiling.

Mounting positions available. Pictures showing front panel. Directional vane air flow.

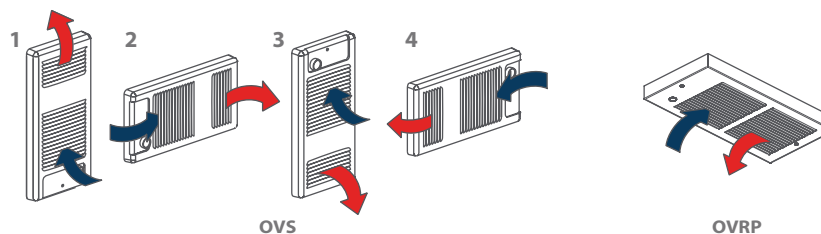

## OVS Models

Watts	Watts 240/208V	Product #						Weight		
		120V	Price	208V	240/208V	Price	347V	Price	lb	kg
500	500/375	OVS0502	194.00	-	OVS0500	190.00	-	-	9.0	4.1
750	750/563	OVS0752	194.00	-	OVS0750	190.00	-	-	9.0	4.1
1000	1000/750	OVS1002	206.00	-	OVS1000	201.00	OVS1007	250.00	9.0	4.1
1250	1250/938	OVS1252	224.00	-	OVS1250	201.00	-	-	9.0	4.1
1500	1500/1125	OVS1502	224.00	-	OVS1500	221.00	OVS1507	264.00	9.0	4.1
2000	2000/1500	-	-	OVS2008	OVS2000	245.00	OVS2007	277.00	9.0	4.1

## OVS Options

Product # Kit	Product # Factory installed*	Price	Description
KIT-OVS-BS	-	46.00	Surface mounting box
KIT-OVS-DIS <sup>1</sup>	DIS <sup>1</sup>	112.00	Disconnect switch, 20A at 277V max. (120V, 208V, 240/208V only)
-	ES <sup>2</sup>	21.00	Factory sealed element (120V, 208V, 240/208V only)
KIT-OVS-TB6	TB6	41.00	Single-pole bi-metal thermostat (347V factory installed only)
KIT-OVS-TB26 <sup>3</sup>	TB26 <sup>3</sup>	50.00	Double-pole bi-metal thermostat (347V factory installed only)
KIT-OVS-TB6-AV	TB6AV	47.00	Single-pole bi-metal tamperproof thermostat (347V factory installed only)
KIT-OVS-TB26-AV <sup>3</sup>	TB26AV <sup>3</sup>	50.00	Double-pole bi-metal tamperproof thermostat (347V factory installed only)

## OVRP Models

Watts	Watts 240/208V	Product #						Weight	
		120V	Price	240/208V	Price	347V	Price	lb	kg
500	500/375	OVRP0502	233.00	OVRP0500	227.00	-	-	9.0	4.1
750	750/563	OVRP0752	233.00	OVRP0750	227.00	-	-	9.0	4.1
1000	1000/750	OVRP1002	248.00	OVRP1000	240.00	OVRP1007	367.00	9.0	4.1
1250	1250/938	OVRP1252	272.00	OVRP1250	240.00	-	-	9.0	4.1
1500	1500/1125	OVRP1502	272.00	OVRP1500	265.00	OVRP1507	393.00	9.0	4.1
2000	2000/1500	-	-	-	-	OVRP2007	435.00	9.0	4.1

## OVRP Options

Product # Kit	Product # Factory installed*	Price	Description
KIT-OVR-BS	-	46.00	Surface mounting box
KIT-OVR-DIS <sup>1</sup>	DIS <sup>1</sup>	112.00	Disconnect switch, 20A at 277V max. (120V, 208V, 240/208V only)
-	ES <sup>2</sup>	21.00	Factory sealed element (120V, 208V, 240/208V only)

\* For factory installed options, add the option number to the product number. See the **Product Code** section inside the front cover.

<sup>1</sup> For the U.S. only: The nominal current of the unit must not exceed 80% of the capacity of the disconnect.

<sup>2</sup> The option "sealed element" increases the reliability of these in humid environments. It does not completely eliminate the leakage currents of metal sheathed heating elements.

<sup>3</sup> "Off" position.

Add "BL" for white, "AM" for almond.

Upcharge applicable for optional colors shown in the color chart section.

