

R100 Diecast Aluminum Enclosures - NEMA 4X



Corrosion Resistant Junction Boxes

Standards

- CSA-US Type 4
- **Complies with**
 - NEMA 4
 - IEC 60529, IP66

Construction

- Aluminum diecast G Al Si 12 / DIN 1725, Leg 230
- Captive stainless steel lid screws are standard.
- Neoprene oil and petrol resistant gasket standard.
- Temperature range -30°C to +100°C (-22°F to +212°F).
- Single-channel Fastening System. Trouble-free turning 90° to 90° with square enclosures by synchronous arrangement of channels.

Finish

- Textured polyester powder coat, beige RAL 7032.

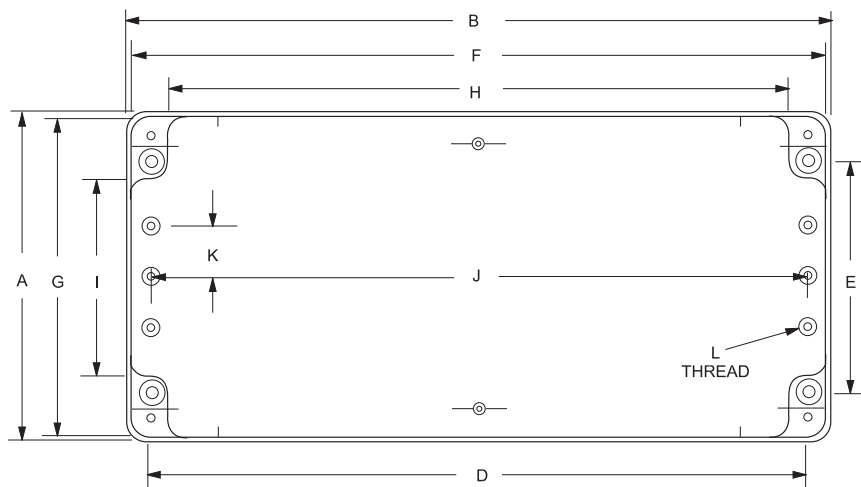
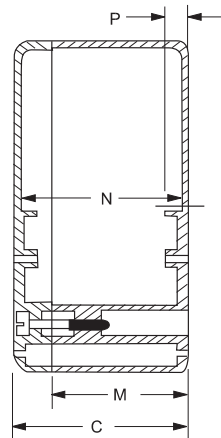

R100 Diecast Aluminum Enclosures - NEMA 4X

Part No.	Series	Units	Width		Length		Height		A	B	C	D	E	F	G	H	I	J	K	L	M	N	P	
			A	B	C	D	E	F																G
R100-060-000	AS-060	inch	2.56	1.97	1.57	1.50	2.09	1.67	2.26	1.28	1.48	1.34	0.96	M4	1.10	1.38	0.35							
		mm	65	50	40	38	53	43	58	33	38	34	25		28	35	9							
R100-062-000	AS-062	inch	2.56	2.56	1.57	2.09	2.09	2.26	2.26	1.48	1.48	1.93	0.55	M4	1.10	1.34	0.35							
		mm	65	65	40	53	53	58	58	38	38	49	14		28	34	9							
R100-064-000	AS-064	inch	2.56	3.94	1.57	3.46	2.09	3.64	2.26	2.85	1.48	3.31	0.55	M4	1.10	1.34	0.35							
		mm	65	100	40	88	53	93	58	73	38	84	14		28	34	9							
R100-066-000	AS-066	inch	2.56	5.91	1.57	5.43	2.09	5.61	2.26	4.82	1.48	5.28	0.55	M4	1.10	1.34	0.35							
		mm	65	150	40	138	53	143	58	123	38	134	14		28	34	9							
R100-080-000	AS-080	inch	3.15	3.15	2.36	2.64	2.64	2.78	2.78	1.93	1.93	2.28	0.77	M4	1.57	2.13	0.39							
		mm	80	80	60	67	67	71	71	49	49	58	20		40	54	10							
R100-082-000	AS-082	inch	3.15	4.72	2.36	4.21	2.64	4.35	2.78	3.54	1.93	3.86	0.77	M4	1.57	2.13	0.39							
		mm	80	120	60	107	67	111	71	90	49	98	20		40	54	10							
R100-084-000	AS-084	inch	3.15	6.30	2.36	5.79	2.64	5.93	2.78	5.43	1.93	5.43	0.77	M4	1.57	2.13	0.39							
		mm	80	160	60	147	67	151	71	138	49	138	20		40	54	10							
R100-100-000	AS-100	inch	3.94	3.94	3.15	3.43	3.43	3.54	3.54	2.74	2.74	3.07	1.16	M4	2.09	2.91	0.39							
		mm	100	100	80	87	87	90	90	70	70	78	30		53	74	10							
R100-102-000	AS-102	inch	3.94	5.91	3.15	5.39	3.43	5.51	3.54	4.70	2.74	5.04	1.16	M4	2.09	2.91	0.39							
		mm	100	150	80	137	87	140	90	120	70	128	30		53	74	10							
R100-104-000	AS-104	inch	3.94	7.87	3.15	7.36	3.43	7.48	3.54	6.67	2.74	7.01	1.16	M4	2.09	2.91	0.39							
		mm	100	200	80	187	87	190	90	170	70	178	30		53	74	10							
R100-120-000	AS-120	inch	4.72	4.72	3.94	4.02	4.02	4.29	4.29	3.15	3.15	3.62	1.26	M6	2.64	3.62	0.51							
		mm	120	120	100	102	102	109	109	80	80	92	32		67	92	13							
R100-122-000	AS-122	inch	4.72	7.09	3.94	6.38	4.02	6.65	4.29	5.51	3.15	5.98	1.26	M6	2.64	3.62	0.51							
		mm	120	180	100	162	102	169	109	140	80	152	32		67	92	13							
R100-124-000	AS-124	inch	4.72	9.45	3.94	8.74	4.02	9.02	4.29	7.87	3.15	8.35	1.26	M6	2.64	3.62	0.51							
		mm	120	240	100	222	102	229	109	200	80	212	32		67	92	13							
R100-160-000	AS-160	inch	6.30	6.30	3.94	5.59	5.59	5.87	5.87	4.74	4.76	5.20	2.05	M6	2.64	3.62	0.51							
		mm	160	160	100	142	142	149	149	121	121	132	52		67	92	13							
R100-162-000	AS-162	inch	6.30	9.45	3.94	8.74	5.59	9.02	5.87	7.87	4.72	8.39	2.05	M6	2.64	3.62	0.51							
		mm	160	240	100	222	142	229	149	200	120	213	52		67	92	13							
R100-164-000	AS-164	inch	6.30	12.60	3.94	11.89	5.59	12.17	5.87	11.02	4.72	11.50	2.05	M6	2.64	3.62	0.51							
		mm	160	320	100	302	142	309	149	280	120	292	52		67	92	13							
R100-166-000	AS-166	inch	6.30	18.90	3.94	18.19	5.59	18.43	5.83	17.28	4.69	17.80	2.05	M6	2.64	3.58	0.51							
		mm	160	480	100	462	142	468	148	439	119	452	52		67	91	13							
R100-200-000	AS-200	inch	7.87	7.87	4.72	7.09	7.09	7.40	7.40	6.08	6.10	6.61	2.64	M6	3.15	4.41	0.51							
		mm	200	200	120	180	180	188	188	155	155	168	67		80	112	13							
R100-202-000	AS-202	inch	7.87	11.81	4.72	11.02	7.09	11.34	7.40	10.02	6.10	10.55	2.64	M6	3.15	4.41	0.51							
		mm	200	300	120	280	180	288	188	255	155	268	67		80	112	13							
R100-204-000	AS-204	inch	7.87	15.75	4.72	14.96	7.09	15.28	7.40	13.96	6.10	14.49	2.64	M6	3.15	4.37	0.51							
		mm	200	400	120	380	180	388	188	355	155	368	67		80	111	13							
R100-240-000	AS-240	inch	9.45	9.45	4.72	8.66	8.66	8.98	8.98	7.66	7.68	8.19	3.43	M6	3.15	4.41	0.51							
		mm	240	240	120	220	220	228	228	195	195	208	87		80	112	13							
R100-242-000	AS-242	inch	9.45	14.17	4.72	13.39	8.66	13.70	8.98	12.38	7.68	12.91	3.43	M6	3.15	4.37	0.51							
		mm	240	360	120	340	220	348	228	315	195	328	87		80	111	13							
R100-244-000	AS-244	inch	9.45	18.90	4.72	18.11	8.66	18.43	8.98	17.11	7.68	17.64	3.43	M6	3.15	4.37	0.51							
		mm	240	480	120	460	220	468	228	435	195	448	87		80	111	13							
R100-320-000	AS-320	inch	12.60	12.60	4.72	11.81	11.81	12.13	12.13	10.81	10.83	11.34	5.00	M6	3.15	4.37	0.51							
		mm	320	320	120	300	300	308	308	275	275	288	127		80	111	13							
R100-322-000	AS-322	inch	12.60	18.90	4.72	18.11	11.81	18.43	12.13	17.11	10.83	17.64	5.00	M6	3.15	4.37	0.51							
		mm	320	480	120	460	300	468	308	435	275	448	127		80	111	13							
R100-324-000	AS-324	inch	12.60	25.20	4.72	24.41	11.81	24.72	12.13	23.41	10.83	23.94	5.00	M6	3.15	4.37	0.51							
		mm	320	640	120	620	300	628	308	595	275	608	127		80	111	13							

Inches are for reference only. Use metric for precise measurements.

Corrosion Resistant Junction Boxes