

Colour-Coded Compression Connectors

Type CTL — Copper Lugs, One-Hole Mount, Short Barrel

Copper Compression Connectors

- For use with copper conductors: AWG stranded, flexible cable, welding cable and portable cord
- Specially designed for industrial and building applications
- Made of high-conductivity seamless copper tubing
- Tin-plated for corrosion resistance
- Specially chamfered barrel for ease of installation
- Colour-coded for matching die identification
- Can be used for medium voltage application up to 35 kV provided proper insulation techniques are used
- CSA Certified and UL Listed for AWG conductors when installed with Blackburn®, Burndy, T&B® or Anderson tools, as specified by CSA
- Comply with Subpart 111.60-17 of Federal Register's Coast Guard Electrical Engineering Rules and Regulations

Short Barrel Connectors

- Short barrel connectors designed for regular duty applications
- Ideal for confined areas

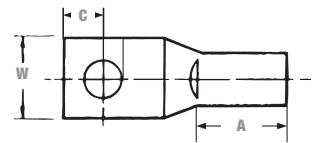
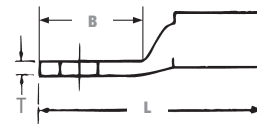

Cat. No.	Conductor Size (Cu)	Stud Size (in.)	Dimensions (in.)						Colour Code
			A	B	C	L	W	T	
CTL8-10	8 str.	10	13/32	1/2	7/32	1-5/32	3/8	1/16	Red
CTL8-14		1/4	13/32	19/32	1/4	1-3/16	7/16	1/16	
CTL8-516	6 str.	5/16	13/32	5/8	9/32	1-5/16	9/16	1/16	Blue
CTL6-10		10	7/16	17/32	7/32	1-7/32	7/16	1/16	
CTL6-14		1/4	7/16	17/32	7/32	1-7/32	7/16	1/16	
CTL6-516		5/16	7/16	21/32	9/32	1-13/32	19/32	1/16	
CTL6-38		3/8	7/16	21/32	9/32	1-13/32	19/32	1/16	
CTL6-10		10	1/2	19/32	1/4	1-3/8	17/32	3/32	
CTL4-14	4 str.	1/4	1/2	19/32	1/4	1-3/8	17/32	3/32	Grey
CTL4-516		5/16	1/2	21/32	5/16	1-13/32	19/32	1/16	
CTL4-38		3/8	1/2	21/32	5/16	1-13/32	19/32	1/16	
CTL2-14	2 + 3 str.	1/4	19/32	21/32	1/4	1-1/2	9/16	3/32	Brown
CTL2-516		5/16	19/32	7/8	3/8	1-23/32	9/16	3/32	
CTL2-38		3/8	19/32	29/32	3/8	1-3/4	9/16	3/32	
CTL2-12		1/2	19/32	1-1/16	1/2	1-29/32	3/4	1/16	
CTL1-14	1 str.	1/4	19/32	21/32	1/4	1-1/2	21/32	3/32	Green
CTL1-516		5/16	19/32	7/8	3/8	1-23/32	21/32	3/32	
CTL1-38		3/8	19/32	29/32	3/32	1-3/4	21/32	3/32	
CTL1-12		1/2	19/32	1-1/4	1/2	2-3/32	3/4	3/32	
CTL10-516	1/0 str.	5/16	11/16	7/8	3/8	1-13/16	3/4	1/8	Pink
CTL10-38		3/8	11/16	29/32	3/8	1-7/8	3/4	1/8	
CTL10-12	2/0 str.	1/2	11/16	1-1/4	1/2	2-3/16	3/4	1/8	Black
CTL20-38		3/8	13/16	29/32	3/8	2-1/32	13/16	1/8	
CTL20-12		1/2	13/16	1-1/4	1/2	2-11/32	13/16	1/8	
CTL30-38	3/0 str.	3/8	13/16	29/32	3/8	2-1/32	29/32	1/8	Orange
CTL30-12		1/2	13/16	1-1/4	1/2	2-11/32	29/32	1/8	

See Section E for more tool and die information.

Cat. No.	Conductor Size (Cu)	Stud Size (in.)	Dimensions (in.)						Colour Code
			A	B	C	L	W	T	
CTL40-38	4/0 str. or 3/0 weld	3/8	15/16	29/32	3/8	2-5/32	1-3/32	1/8	Purple
CTL40-12		1/2	15/16	1-1/4	1/2	2-1/2	1-1/32	1/8	
CTL250-12	250 kcmil or 4/0 weld	1/2	1-1/32	1-1/4	1/2	2-19/32	1-1/8	1/8	Yellow
CTL300-12	300 kcmil	1/2	1-1/32	1-1/4	1/2	2-25/32	1-3/16	5/32	White
CTL350-12	350 kcmil	1/2	1-1/32	1-1/4	1/2	2-25/32	1-11/32	5/32	Red
CTL400-12	400 kcmil	1/2	1-1/32	1-1/4	1/2	3-3/16	1-13/32	5/32	Blue
CTL400-58		5/8	1-1/32	1-9/16	5/8	3-1/2	1-13/32	5/32	
CTL500-12	500 kcmil	1/2	1-1/32	1-1/4	1/2	3-1/4	1-19/32	7/32	Brown
CTL500-58		5/8	1-1/32	1-9/16	5/8	3-9/16	1-19/32	7/32	
CTL600-58	600 kcmil	5/8	1-9/16	1-9/16	5/8	3-23/32	1-3/4	7/32	Green
CTL750-58	750 kcmil	5/8	1-1/2	1-9/16	5/8	3-25/32	1-29/32	1/4	Black
CTL1000-58	1000 kcmil	5/8	1-3/4	1-9/16	5/8	4-1/32	2-1/4	9/32	-

See Section E for more tool and die information.

Blackburn and T&B are registered trademarks of Thomas & Betts Corporation. All other trademarks are the property of their respective owners.