

Universal Device Mount Covers

Single Gang

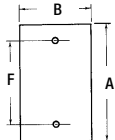

S340E



CCMB

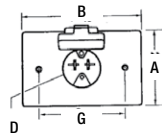

CCPO

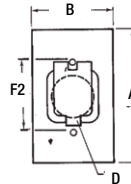

S321E / CCT-1 / SW20-2

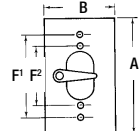

| Cat. No. | Description | A (in.) | B (in.) | F (in.) |
|---|---|---------|---------|---------|
| Single Gang Device Mount Covers (zinc) | | | | |
| S340E | Blank Cover (Stamped aluminum) – Silver | 4-9/16 | 2-13/16 | 3-9/32 |
| S340BRE | Blank Cover (Stamped aluminum) – Bronze | | | |
| S340WHE | Blank Cover (Stamped aluminum) – White | | | |



| Cat. No. | Description | A (in.) | B (in.) | D (in.) | F1 (in.) | F2 (in.) | G (in.) |
|---|---|---------|---------|---------|----------|----------|---------|
| Single Gang Device Mount Covers (zinc) | | | | | | | |
| CCMB | Motor Base Cover with 15A, 125V plug | 2-3/8 | 4-9/16 | 1-35/64 | - | - | 3-9/32 |
| CCPO | Power outlet cover for 30A and 50A receptacles Box Mount | 4-9/16 | 2-13/16 | 2-5/32 | 3-9/32 | 2-3/8 | - |
| S321E | For switch packed with spacers | | | | | | |
| CCT-1 | Switch cover with single pole switch 15A, 125V AC | | | | | | |
| CCT-1-20 | Switch cover with single pole 20A switch, 120V, 277V AC | | | | | | |
| SW20-2 | Switch cover with double pole 20A switch, 120V, 277V AC (all with spacers and screws) | | | | | | |

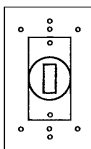

CCK

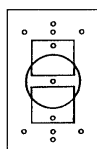

CCSK / S620E



| Cat. No. | Description |
|----------------------------|-----------------|
| Single Gang Gaskets | |
| CCK | Neoprene Gasket |
| CCSK | Neoprene Gasket |
| S620E | Neoprene Gasket |