

Nonmetallic Sheathed Cable

Connectors



Cat. No.	Trade Size (in.)	Clamping Range (in.)		Suggested Application NMD90 (loomex)
		Min.	Max.	
One Screw Fittings (Aluminum)				
CI2166	1/2	0.50	0.90	8/3-6/3
CI2167	3/4	0.71	1.10	6/3-4/3
Duplex Fittings (Zinc Alloy)				
One Screw CI2175	3/8	0.15	0.65	14/2-10/2; 14/3-10/3
Nonmetallic Fittings				
CI3360	1/2	0.30	0.60	14/2-10/2; 14/3-10/3 2 cables: 14/2-12/2
CI4004		0.21	0.42	14/2-10/2; 14/3-10/3 2 cables: 14/2-12/2
W100LX-D		0.21	0.42	14/2-10/2; 14/3-10/3 2 cables: 14/2-12/2
One Screw Fittings (Steel)				
CI4040	3/8	0.19	0.57	14/2-10/2; 14/3-10/3 2 cables: 14/2
CI9049		0.13	0.37	14/2-10/2; 14/3-12/3

CI2166 / CI2167



Zinc Die Cast Locknut

CI2175



Zinc Die Cast Locknut

CI3360

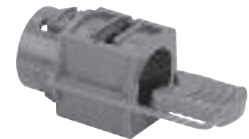

CI4004 / W100LX-D



CI4040



CI9049



All NMD90 fittings are also suitable for NMWU90 of equivalent diameters, in dry locations
NOTE: 3/8 in. trade size connectors require a 1/2 in. knockout

Technical improvements are constantly taking place in the electrical industry. Cable manufacturers are changing their products from time to time. Accordingly, it is strongly suggested that you verify the cable size with the cable manufacturer prior to selecting a fitting.

Armoured Cable / Flexible Conduit

Connectors



CI70



Zinc Die Cast Locknut

L-16



Zinc Die Cast Locknut

CI71 / CI73



Zinc Die Cast Locknut

CI2175



Zinc Die Cast Locknut

CI2210 / CI2236



Zinc Die Cast Locknut

CI2238 / CI2240 /

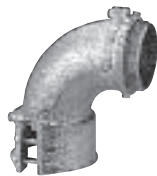

Zinc Die Cast Locknut

CI4090



Aluminum Locknut

Cat. No.	Trade Size (in.)	Clamping Range (in.)		Suggested Application AC90 (BX)	Flex. Conduit
		Min.	Max.		
One Screw Fittings (Zinc Alloy)					
L-16	3/8	0.12	0.63	14/2-10/2; 14/4-12/4	5/16-7/16
CI70	3/8	0.13	0.70	14/2-10/2; 14/3-10/3; 14/4-10/4	5/16-7/16
CI71	1/2	0.33	0.95	14/2-8/2; 14/3-8/3; 14/4-8/4	7/16-1/2
CI72	3/4	0.60	1.15	8/2-6/2; 8/3-3/3; 8/4-3/4	3/4
CI73	1	0.93	1.47	3/3-3/0/3; 3/4-1/4	1
Duplex Fitting (Zinc Alloy)					
CI2175	3/8	0.15	0.65	14/2-10/2; 14/3-10/3; 14/4-12/4	3/8
90° Fittings (Zinc Alloy)					
CI2210	3/8	0.40	0.63	14/2-10/2; 14/3-10/3 14/4-12/4	3/8
CI2211	1/2	0.65	0.97	8/2; 8/3; 10/4	1/2
CI2214	3/4	0.77	1.12	1/0/1-4/0/1; 6/2-4/2; 8/3-3/3; 8/4-6/4	3/4
CI2216	1	1.06	1.40	4/0/1-350/1; 2/2; 4/3-2/3; 6/4-4/4	1
CI2218	1-1/4	1.34	1.65	500/1-750/1; 1/3-3/0/3; 1/4-1/0/4	1-1/4
CI2234	1-1/2	1.70	2.15	600/1-1000/1; 2/0/3; 1/4-3/0/4	1-1/2
CI2236	2	1.51	2.47	600/1-1000/1; 2/0/3-400/3; 1/4-4/0/4	1-1/2 - 2
90° Fittings (Aluminum)					
CI2238	2-1/2	2.50	3.08	600/3-750/3	2-1/2
CI2240	3	2.95	3.55	1000/3	3
CI4090	4	4.17	4.62	—	4

Also suitable for ACWU90 (of equivalent diameters) in dry locations. A non-ferrous connector and locknut must be used to terminate a single conductor cable when nominal current exceeds 200 A

NOTE: 3/8 in. trade size fittings require a 1/2 in. knockout

Technical improvements are constantly taking place in the electrical industry. Cable manufacturers are changing their products from time to time. Accordingly, it is strongly suggested that you verify the cable size with the cable manufacturer prior to selecting a fitting.

Specification Guide

Cable Fittings



L-16

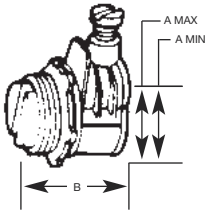

CI70 / CI72

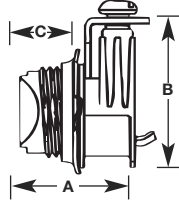

CI804 / CI816

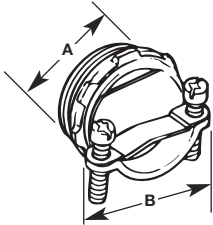

CI2060 / CI2061

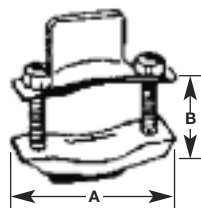

CI2104 / CI2116

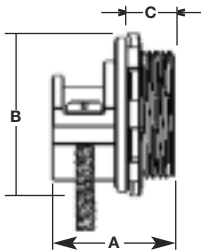

CI2163

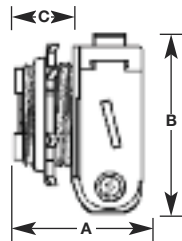

CI2166 / CI2172

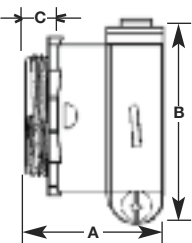

CI2173 / CI2174

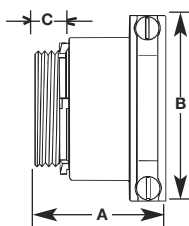

CI2175

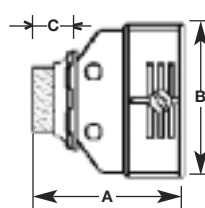

Cat. No.	Trade Size (in.)	Clamping Range (in.)		Dimensions (in.)		
		Min.	Max.	A	B	C
One Screw Connectors (Zinc Alloy)						
CI70	3/8	0.13	0.70	1	1-1/8	1/2
L-16	3/8	0.12	0.63	1	—	—
CI71	1/2	0.33	0.95	1-3/8	1-1/2	1/2
CI72	3/4	0.60	1.15	1-1/2	1-13/16	1/2
Two Screw Connectors (Zinc Alloy)						
CI804	3/8	0.18	0.64	7/8	1-1/16	—
CI806	3/4	0.41	0.82	1-3/8	1-3/16	
CI808	1	0.50	1.04	1-1/8	2	
CI810	1-1/4	0.56	1.06	1-5/16	2-3/16	
CI812	1-1/2	0.63	1.60	1-1/2	2-5/8	
CI816	2	0.86	2.06	1-9/16	3	
Two Screw Connectors (Steel)						
CI2060	3/8	0.11	0.60	1-1/2	5/8	—
CI2061	3/4	0.15	0.90	1-3/4	13/16	
Two Screw Connectors (Cast Aluminum Body and Clamp)						
CI2104	1/2	0.45	0.59	1-3/16	1-3/8	19/32
CI2106	3/4	0.55	0.78	1-3/8	1-11/16	5/8
CI2108	1	0.69	1.01	1-1/2	1-15/16	3/4
CI2110	1-1/4	0.84	1.33	1-1/2	2-3/8	9/16
CI2112	1-1/2	1.06	1.57	1-9/16	2-3/4	5/8
CI2116	2	1.38	2.06	1-3/4	3-1/4	3/4
One Screw Connector (Zinc Alloy)						
CI2163	3/8	0.35	0.61	1	1-5/16	7/16
One Screw Connectors (Aluminum)						
CI2166	1/2	0.50	0.90	1-9/16	1-11/16	7/16
CI2167	3/4	0.71	1.10	1-11/16	1-7/8	7/16
CI2169	1	1.16	1.50	2	2-1/2	1/2
CI2170	1-1/4	1.32	1.77	2-3/8	2-7/8	5/8
CI2171	1-1/2	1.77	2.05	2-1/2	3-1/4	5/8
CI2172	2	2.10	2.54	2-11/16	3-3/4	11/16
Two Screw Connectors (Aluminum)						
CI2173	2-1/2	2.05	3.07	3-1/8	4-9/16	3/4
CI2174	3	2.25	3.57	3-3/8	5-5/16	15/16
Duplex Connectors (Zinc Alloy)						
CI2175	3/8	0.15	0.65	9/16	5/8	3/8

Technical improvements are constantly taking place in the electrical industry. Cable manufacturers are changing their products from time to time. Accordingly, it is strongly suggested that you verify the cable size with the cable manufacturer prior to selecting a fitting.