

NEER Zinc Combination Couplings

For EMT.

EGC: Screw-In Compression

Application

- A combination coupling to provide a transition from EMT to flexible metal conduit.

Material/Finish

- Zinc die cast

Certifications and Compliances

- UL Standard: 514B
- UL Listed: E32539
- CSA Standard: C22.2 No. 18.3
- CSA Certified: 208044
- NEMA: FB-1

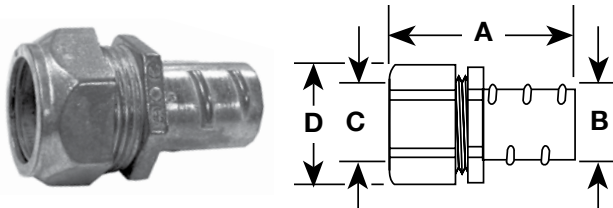

EGC-50

Trade Size (Inches) EMT to Flex.	Catalog Number	Dimensions in Inches/Millimeters			
		A	B	C	D
1/2 to 1/2	EGC-50	1.66/42.2	0.71/18.0	0.72/18.3	1.00/25.4
3/4 to 3/4	EGC-75	1.68/42.7	0.92/23.4	0.92/23.4	1.18/30.0

EFC: EMT to Set Screw

Application

- EFC-50
 - A combination coupling to provide a transition from EMT to 14/2 NM cable. Not for use with flexible metal conduit.
- EFC-75 and EFC-100
 - A combination coupling to provide a transition from EMT to flexible metal conduit.

Material/Finish

- Zinc die cast

Certifications and Compliances

- UL Standard: 514B
- UL Listed: E32539
- CSA Standard: C22.2 No. 18.3
- CSA Certified: 208044
- NEMA: FB-1

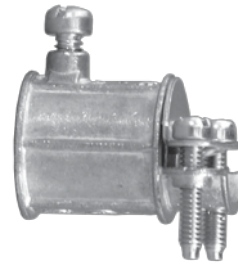

EFC-50

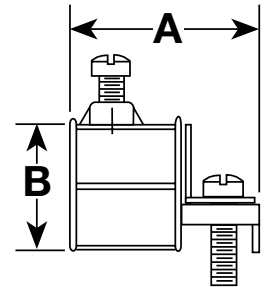

EFC-50

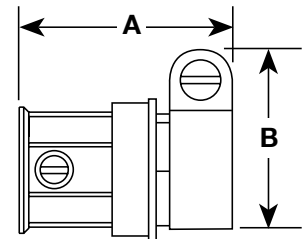

EFC-75 and EFC-100

Trade Size (Inches) EMT to Flex.	Catalog Number	Dimensions in Inches/Millimeters	
		A	B
1/2	EFC-50	1.33/33.8	0.93/23.6
1/2 to 1/2	EFC-75	1.62/41.1	1.35/34.3
3/4 to 3/4	EFC-100	1.96/49.8	1.60/40.6

Commercial Products

COMMERCIAL PRODUCTS: EMT FITTINGS