

## Nonmetallic Sheathed Cable

### Connectors



Cat. No.	Trade Size (in.)	Clamping Range (in.)		Suggested Application
		Min.	Max.	NMD90 (loomex)
One Screw Fittings (Aluminum)				
CI2166	1/2	0.50	0.90	8/3-6/3
CI2167	3/4	0.71	1.10	6/3-4/3
Duplex Fittings (Zinc Alloy)				
One Screw CI2175	3/8	0.15	0.65	14/2-10/2; 14/3-10/3
Nonmetallic Fittings				
CI3360	1/2	0.30	0.60	14/2-10/2; 14/3-10/3 2 cables: 14/2-12/2
CI4004		0.21	0.42	14/2-10/2; 14/3-10/3 2 cables: 14/2-12/2
W100LX-D		0.21	0.42	14/2-10/2; 14/3-10/3 2 cables: 14/2-12/2
One Screw Fittings (Steel)				
CI4040	3/8	0.19	0.57	14/2-10/2; 14/3-10/3 2 cables: 14/2
CI9049		0.13	0.37	14/2-10/2; 14/3-12/3

**CI2166 / CI2167**



Zinc Die Cast Locknut

**CI2175**



Zinc Die Cast Locknut

**CI3360**



**CI4004 / W100LX-D**



**CI4040**



**CI9049**



All NMD90 fittings are also suitable for NMWU90 of equivalent diameters, in dry locations  
NOTE: 3/8 in. trade size connectors require a 1/2 in. knockout

Technical improvements are constantly taking place in the electrical industry. Cable manufacturers are changing their products from time to time. Accordingly, it is strongly suggested that you verify the cable size with the cable manufacturer prior to selecting a fitting.

## Specification Guide

### Cable Connectors

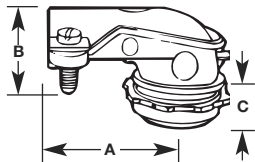
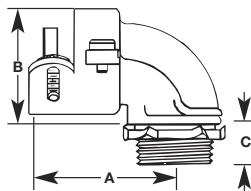
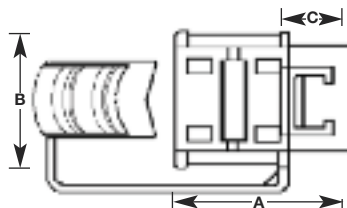
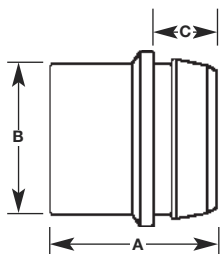
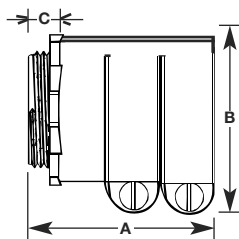
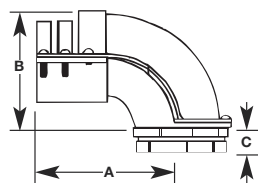
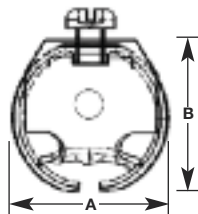
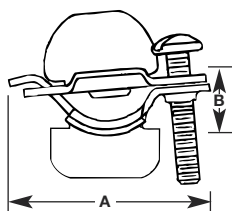
**CI2210 / CI2236**

**CI2238 / CI2240**

**CI3360**

**CI4004**

**CI4000**

**CI4090**

**CI4040**

**CI9049**

Cat. No.	Trade Size	Clamping Range		Dimensions		
		Min.	Max.	A	B	C
90° Connectors (Zinc Alloy)						
CI2210	3/8	0.40	0.63	1-3/8	3/4	3/8
CI2211	1/2	0.65	0.97	1-11/16	1-1/16	3/8
CI2214	3/4	0.77	1.12	1-3/4	1-1/8	1/2
CI2216	1	1.10	1.57	2	1-5/8	5/8
CI2218	1-1/4	1.27	1.75	3-3/8	2-1/8	5/8
CI2234	1-1/2	1.70	2.15	5-1/4	3-1/4	3/4
CI2236	2	2.00	2.62	5-3/8	3-1/4	3/4
90° Connectors (Aluminum)						
CI2238	2-1/2	2.50	3.08	6-1/4	5-1/2	3/4
CI2240	3	2.95	3.55	7-1/4	6-5/8	3/4
Nonmetallic Connector						
CI3360	1/2	0.30	0.60	1-5/16	1-1/16	7/16
Two Screw Connector (Aluminum)						
CI4000	4	4.40	4.55	4-7/8	5-3/4	7/8
Nonmetallic Connector						
CI4004	1/2	0.21	0.42	15/16	7/8	3/8
One Screw Connectors (Steel)						
CI4040	3/8	0.19	0.57	15/16	7/8	—
CI9049	3/8	0.13	0.37	1-3/8	5/16	—
90° Connector (Aluminum)						
CI4090	4	4.17	4.62	8-1/4	6	1

Technical improvements are constantly taking place in the electrical industry. Cable manufacturers are changing their products from time to time. Accordingly, it is strongly suggested that you verify the cable size with the cable manufacturer prior to selecting a fitting.