

Accessories

Closure End Plate



Provides closure for any tray end.
Hardware included.

Material Prefix	Siderail Height (in.)	Width of Tray (in.)	Cat. No.
ALUW	2	6	(Prefix)-2-**-CEP
SPUW		12	
SHUW		18	
SSUW		24	
		30	
		36	

Material Prefix	Siderail Height (in.)	Width of Tray (in.)	Cat. No.
ALUW	3	6	(Prefix)-3-**-CEP
SPW	6	12	(Prefix)-6-**-CEP
SHW		18	
SSW		24	
		30	
		36	

** Insert Width of Tray

Drop-Out



Designed to provide a smooth radiused surface at any position on the tray or trough bottom. Drop-Outs are easily attached using hardware provided. Standard Radius = 4 in.

Material Prefix	Width (in.)	Cat. No.
ALUW	6	(Prefix)-**-DOS
SPW	12	
SSW	18	
SHW	24	
	30	
	36	

** Insert Width of Tray

Steel Tray Hardware

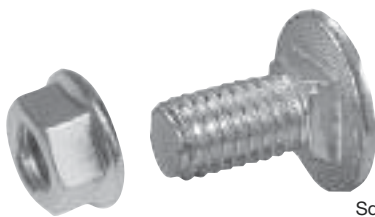

Square shoulder self-positioning carriage bolt.

Description	Material	Cat. No.
1/4 in. Carriage Bolt	Zinc Plated Steel	SPW-1/4-CB
SPW3/8 in. Carriage Bolt	Zinc Plated Steel	SPW-3/8-CB
SSW1/4 in. Hex. Nut	Zinc Plated Steel	SPW-1/4-HN
3/8 in. Hex. Nut	Zinc Plated Steel	SPW-3/8-HN
3/8 in. Carriage Bolt	316 Stainless	SSW-3/8-CB
3/8 in. Hex. Nut	316 Stainless	SSW-3/8-HN
316 Stainless Steel	316 Stainless	SSW-3/8-HWK*
Hardware Kit		

* Contains 8 nuts, 8 bolts, 8 lock washers