

# Color-Keyed

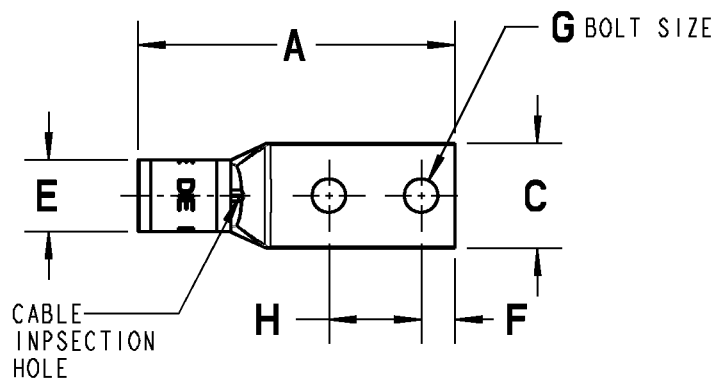

FIG. 1

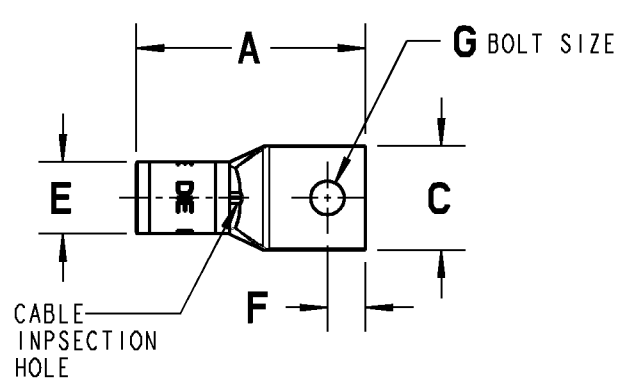
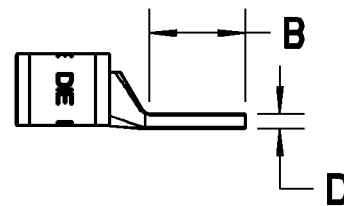
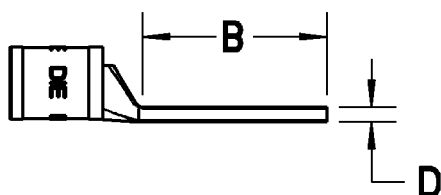

FIG. 2



CAT. NO.	FIG.	CODE CABLE	FLEX CABLE	A	B	C	D	E		F	G	H	COLOR KEY	DIE CODE
				±1/16	MIN.	±1/16	±3/64	±1/32	±1/32	BOLT	±1/32			
								O.D.	I.D.					
256-30695-1403	2	500	925/24	3.00	1.312	1.600	.220	1.100	.882	.630	3/8	--	BROWN	87
256-30695-1404	2	700	1325/24	3.29	1.290	1.810	.280	1.240	.997	.650	3/8	--	PINK	99
256-30695-1405	2	700	1325/24	3.29	1.290	1.810	.280	1.240	.997	.500	1/2	--	PINK	99
256-30695-1406	1	700	1325/24	4.05	2.110	1.810	.280	1.240	.997	.650	3/8	1.000	PINK	99

- MATERIAL: HIGH CONDUCTIVITY WROUGHT COPPER
- FINISH: ELECTRO TİM PLATED

<b>GENERAL NOTES</b>		<b>Thomas &amp; Betts</b> A Member of the ABB Group			
1. ALL DIMENSIONS ARE FOR REFERENCE ONLY. 2. DIMENSIONS IN BRACKETS [ ] ARE IN METRIC UNITS.					
<b>REVISIONS</b>		DESCRIPTION: <b>COPPER LUG T&amp;B METHOD</b>			
** SEE ERN (****) FOR APPROVAL SIGNATURES & RELEASE DATE. PROJECT NO: ****		ORIGINAL PROJECT NO / ( ERN NO ) <b>CM402358 / ( 2015943 )</b>	SHEET NO: <b>1 OF 1</b>	REV. NO: <b>**</b>	DRAWING NO: <b>WSD-001321</b>