

# OVS

## Residential Wall Fan Heater



# OVRP

## Residential Ceiling Fan Heater

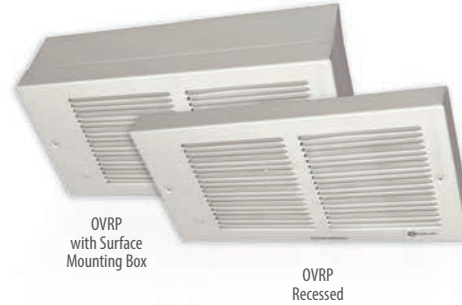

### Features

#### Color

- Standard: white, almond.
- Optional (upcharge applicable): metallic silver, bronze, metallic charcoal, aluminum, semi-gloss black, sand.
- Custom colors available upon request.

#### Finish

- Standard: epoxy/polyester powder paint.

#### Construction

- 20-gauge steel cabinet.
- 22-gauge steel front cover.
- High-limit temperature control with automatic reset.

#### Fan

- Quiet fan operating.
- 120V, 208V, 240/208V models: 500W to 1000W; 40 cfm fan and 1250W to 2000W; 80 cfm fan.
- 347V models : 80 cfm fan.
- Factory-lubricated motor.

#### Heating element

- 120V, 208V, 208/240V: durable tubular heating element with fins.
- Factory sealed element available.
- 347V: Iron-Chromium-Aluminum alloy.

#### Control

- If an electronic thermostat is used, it must be compatible with forced-air heaters.

#### Installation

- Quick installation with recess box mounting holes.
- Large wiring compartment.
- Surface mounting box available.
- Tight fit with V-shaped recess box.

#### Warranty

- 5-year warranty against defects.

#### Application

- Entrance way, kitchen, bathroom, family room, basement.

### OVS Features

#### Voltage

- 120V, 208V, 240/208V, 347V, 1-phase.

#### Control

- Built-in thermostat available with a control knob or tamperproof.

#### Installation

- Wall installation only.
- The air outlet should be installed at least 10 in. (25.4 cm) above floor.
- May be recessed in 2 in. X 3 in. stud partitions.

### OVRP Features

#### Voltage

- 120V, 240/208V, 347V, 1-phase.

#### Control

- Must be used with a compatible wall thermostat (not included).

#### Installation

- Ceiling installation only.
- The air outlet should be installed at least 10 in. (25.4 cm) from the wall.
- May be recessed in ceiling.

Mounting positions available. Pictures showing front panel. Directional vane air flow.

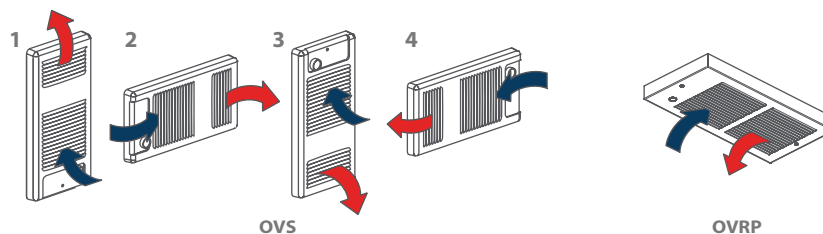

## OVS Models

Watts	Watts 240/208V	Product #		Price		Price		Weight	
		120V	208V	240/208V	347V	lb	kg		
500	500/375	OVS0502	-	OVS0500	-	194.00	190.00	-	9.0 4.1
750	750/563	OVS0752	-	OVS0750	-	194.00	190.00	-	9.0 4.1
1000	1000/750	OVS1002	-	OVS1000	OVS1007	206.00	201.00	250.00	9.0 4.1
1250	1250/938	OVS1252	-	OVS1250	-	224.00	201.00	-	9.0 4.1
1500	1500/1125	OVS1502	-	OVS1500	OVS1507	224.00	221.00	264.00	9.0 4.1
2000	2000/1500	-	OVS2008	OVS2000	OVS2007	-	245.00	277.00	9.0 4.1

## OVS Options

Product #	Price	Description	Factory Installed	Kit
OVS-BS	46.00	Surface mounting box	-	✓
OVS-DIS <sup>1</sup>	112.00	Disconnect switch, 20A at 277V max. (120V, 208V, 240/208V only)	✓	✓
OVS-ES <sup>2</sup>	21.00	Factory sealed element (120V, 208V, 240/208V only)	✓	-
OVS-TB6	41.00	Single-pole bi-metal thermostat (347V factory installed only)	✓	✓
OVS-TB26 <sup>3</sup>	50.00	Double-pole bi-metal thermostat (347V factory installed only)	✓	✓
OVS-TB6-AV	47.00	Single-pole bi-metal tamperproof thermostat (347V factory installed only)	✓	✓
OVS-TB26-AV <sup>3</sup>	50.00	Double-pole bi-metal tamperproof thermostat (347V factory installed only)	✓	✓

## OVRP Models

Watts	Watts 240/208V	Product #		Price		Price		Weight	
		120V	240/208V	347V	lb	kg			
500	500/375	OVRP0502	OVRP0500	-	-	233.00	227.00	9.0 4.1	
750	750/563	OVRP0752	OVRP0750	-	-	233.00	227.00	9.0 4.1	
1000	1000/750	OVRP1002	OVRP1000	OVRP1007	-	248.00	240.00	367.00	9.0 4.1
1250	1250/938	OVRP1252	OVRP1250	-	-	272.00	240.00	9.0 4.1	
1500	1500/1125	OVRP1502	OVRP1500	OVRP1507	-	272.00	265.00	393.00	9.0 4.1
2000	2000/1500	-	-	OVRP2007	-	-	435.00	9.0 4.1	

## OVRP Options

Product #	Price	Description	Factory Installed	Kit
OVR-BS	46.00	Surface mounting box	-	✓
OVR-DIS <sup>1</sup>	112.00	Disconnect switch, 20A at 277V max. (120V, 208V, 240/208V only)	✓	✓
OVR-ES <sup>2</sup>	21.00	Factory sealed element (120V, 208V, 240/208V only)	✓	-

<sup>1</sup>For the U.S. only: The nominal current of the unit must not exceed 80% of the capacity of the disconnect.

<sup>2</sup>The option "sealed element" increases the reliability of these in humid environments. It does not completely eliminate the leakage currents of metal sheathed heating elements.

<sup>3</sup>Off position.

Add "BL" for white, "AM" for almond.

Upcharge applicable for optional colors shown in the color chart section.

For options available as factory installed and kit, if not mentioned on the order, will automatically be shipped as a kit.

