

SINGLE CONDUCTOR COPPER CORFLEX* II 600 VOLTS

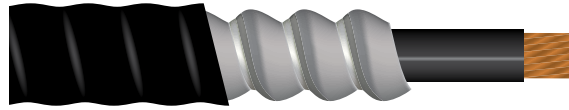

Size	Approximate Diameter (Sheath)		Approximate Diameter (PVC)		Approx Net Cable Weight Sans Jacket		Approx Net Cable Weight w/ PVC		Connectors		Min# Bending Radius		Amp 30°C Ambient (amps)
	mm	in	mm	in	kg/km	lbs/ft	kg/km	lbs/ft	Type D	Type W	mm	in	
1	16.0	.63	18.5	.73	536	360	640	430	16D2	16W2	178	7	210
1/0	19.1	.75	21.8	.86	674	453	796	535	20D3	20W3	203	8	245
2/0	19.6	.77	22.4	.88	804	540	930	625	20D3	20W3	203	8	285
3/0	20.3	.80	23.1	.91	970	652	1101	740	20D3	20W3	229	9	330
4/0	23.1	.91	25.9	1.02	1213	815	1362	915	25D3	25W3	254	10	385
250	24.1	.95	26.9	1.06	1400	941	1555	1045	25D3	25W3	254	10	425
300	25.1	.99	27.7	1.09	1640	1102	1801	1210	25D3	25W3	254	10	480
350	28.7	1.13	31.5	1.24	1968	1322	2150	1445	30D4	30W4	305	12	530
400	29.7	1.17	32.3	1.27	2208	1484	2396	1610	30D4	30W4	305	12	575
500	30.9	1.22	33.8	1.34	2683	1803	2896	1946	30D4	30W4	305	12	660
600	35.1	1.38	37.6	1.48	3246	2181	3467	2330	35D5	35W5	356	14	740
750	38.9	1.53	41.7	1.64	4044	2717	4293	2885	40D5	40W5	381	15	845
1000	42.4	1.67	45.2	1.78	5273	3543	5543	3725	45D6	45W6	432	17	1000

ewc05_cu_armour_04