

# R17d BASE DOUBLE RECESSED CONTACTS

E5

**FL631-L** Fixed end, wire leads, for 800 and 1500mA lamps

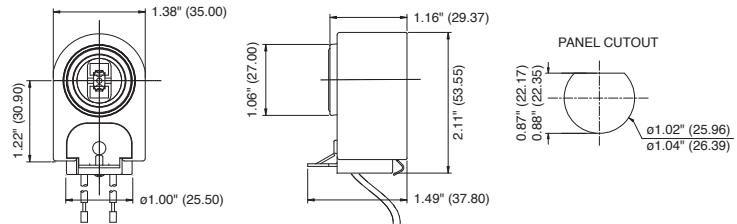

- Body made from PC material
- Silver plated Phosphor Bronze contacts
- Fixed end of set, both are required
- 9" 18AWG TEW AWN 105°C wire leads, stripped 1/2" or per customer specifications

- Neoprene "O" ring gasket
- Mounts into "D" hole in panel
- For .036" to .048" panel thickness
- Available in vertical or horizontal contacts

- Rated 600V 660W or 1000V 660W for non-home use
- Certified for outdoor use in enclosed fixtures
- cCSA<sub>US</sub> and cUL<sub>US</sub> listed

**FL631-PI** Fixed end, push-in terminals, for 800 and 1500mA lamps

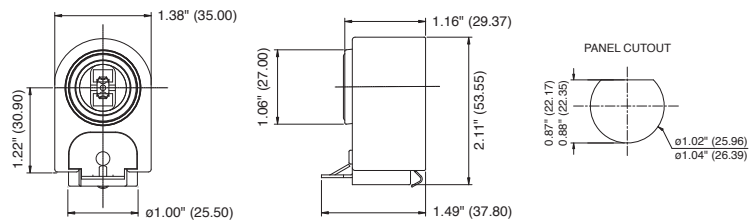

- Body made from PC material
- Silver plated Phosphor Bronze contacts
- Fixed end of set, both are required
- Push-in terminals for solid ballast wires direct into the lampholder, no extra connections

- Neoprene "O" ring gasket
- Mounts into "D" hole in panel
- For .036" to .048" panel thickness
- Available in vertical or horizontal contacts

- Rated 600V 660W or 1000V 660W for non-home use
- Certified for outdoor use in enclosed fixtures
- cCSA<sub>US</sub> and cUL<sub>US</sub> listed

**FL700W/701W** Tall Profile Lampholder Set

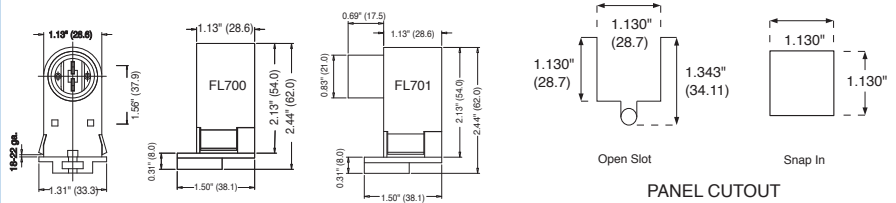

- Made of Polycarbonate
- For 60W - 112W lamps
- Flexible snap-in wings for quick, easy insertion into panel
- Snap-in/Slot-in mount, available with captive nuts for screw mount

- Quick connect push-in wire terminals accept 18 AWG solid or solder dipped leads, stripped 3/8"
- Vertical contacts

- Two wire ports per terminal to speed harness wiring
- Rated 660W, 1,600V
- cCSA<sub>US</sub> Certified / cUL<sub>US</sub> Listed

HO Fluorescent