

135 Series

LAG SHIELDS

Zinc Alloy Rust Proof Medium Duty
Concrete or Masonry Anchor

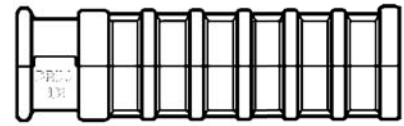

Lag Shields are a screw type anchor designed to be used with Lag Screws. Short type shields are used in harder masonry materials to reduce drilling time. The Long version is used in soft masonry to develop better holding strength. For use in concrete or mortar joints of brick or block walls. Drill hole size embossed on shield to the depth of embedment required plus 1/2". Clean hole of dust after drilling. Tap in anchor until head is flush with surface. Apply lag screw and tighten.

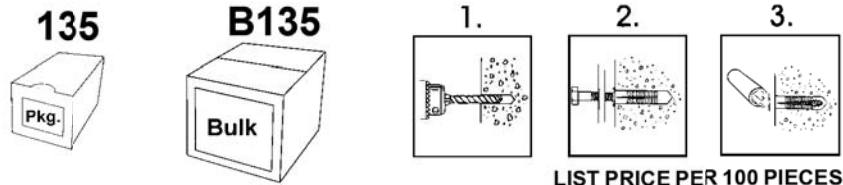

Load Capacities for Block

Anchor Size	Depth	Tension (Lbs)	Shear (Lbs)
1/4"	1"	390	800
5/16"	1-1/4"	580	1140
3/8"	1-1/2"	920	1250
1/2"	1-1/2"	1210	1780

Load Capacities for Brick

Anchor Size	Depth	Tension (Lbs)	Shear (Lbs)
1/4"	1"	410	1140
5/16"	1-1/4"	980	1650
3/8"	1-1/2"	1380	1800
1/2"	1-1/2"	1980	2380

Size No.	Shield Diameter and Length	CASE-Plated 135		BULK-Plated B135		Approx. Wt. 100 Pcs.	Hole Drill Size
		Pkg Qty	Case Qty	Bulk Qty	Bulk Qty		
-800	1/4x1 S	50	1200		1300	2.4	1/2"
-802	1/4x1-1/2 L	50	800		1000	3.4	1/2"
-804	5/16x1-1/4 S	50	800		1050	2.6	1/2"
-806	5/16x1-3/4 L	50	600		1000	3.2	1/2"
-808	3/8x1-3/4 S	50	400		450	5.2	5/8"
-810	3/8x2-1/2 L	50	300		350	4.8	5/8"
-812	1/2x2 S	25	300		400	4.2	3/4"
-814	1/2x3 L	25	150		170	3.8	3/4"

227 Series

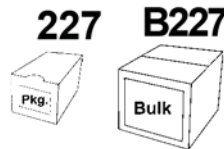

DROP-IN ANCHORS

Zinc Plated Steel Medium Duty
Concrete or Masonry Anchor



Paulin Drop-In Anchors are ideal for anchoring bolts or threaded rod into concrete, brick, block or stone. The anchor is expanded with a setting tool which drives the internal plug to the end of the anchor. This in turn expands the four slots surrounding the plug holding the anchor in place. Drill hole size indicated in chart below. Clean hole of dust after drilling. Tap the anchor flush to the surface. Set the internal anchor using the Paulin setting tool. Drive the tool into the anchor until the tool sits flush with the surface.

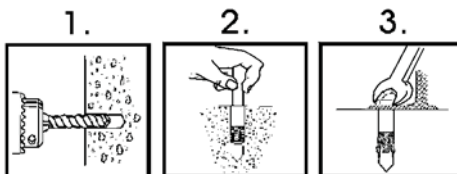

2000 p.s.i. concrete		4000 p.s.i. concrete		6000 p.s.i. concrete	
Tension	Shear	Tension	Shear	Tension	Shear
1950	1760	3400	1800	3880	3120
3230	3990	6400	4220	5740	5970
4100	5940	9000	6640	10660	11000

Load Capacities

Anchor Size	Drill Size	Min. Depth
1/4"	3/8"	1-1/4"
3/8"	1/2"	1-7/8"
1/2"	5/8"	2-3/8"

Size No.	Anchor Diameter and Length	CASE-Plated 227		BULK-Plated B227		Approx. Wt. 100 Pcs.	Hole Drill Size
		Pkg Qty	Case Qty	Bulk Qty	Bulk Qty		
-200	1/4x1	25	800		2000	2.7	3/8"
-202	3/8x1-9/16	25	800		1000	5.7	1/2"
-204	1/2x2	25	500		500	11.7	5/8"

DROP-IN ANCHORS SETTING TOOL

LIST PRICE PER 100 PIECES

Size No.	Anchor Diameter	PACKAGE-Plated 227		BULK-Plated B227	
		Pkg Qty	Bulk Qty	Pkg Qty	Bulk Qty
-210	1/4	1	15		
-212	3/8	1	15		
-244	1/2	1	15		



Note: Please use Series and Size No. when ordering:

Example: 1/4 x 1 Drop-In Anchors

Series Size No.
Case - 227 -200
Bulk - B227 -200

Revised July 11th, 2012