

# BS100

INDUSTRIAL



Type: \_\_\_\_\_

Project: \_\_\_\_\_

The ILLUMINA® BS100 features eight (8) closure clips that securely and evenly seal the luminaire

The ILLUMINA® BS100 is corrosion, flame and vandal resistant

Unique three piece design that allows effortless assembly without any tools

**DIFFUSER:** The UV stabilized polycarbonate diffuser optimizes light output and distribution.

The ILLUMINA® BS100 is ideal for parking structures, warehouses, breezeways, canopies and schools

## CONFIGURATIONS

MODEL	LENGTH	OPERATION	LAMPS	INPUT	MOUNTING	OPTIONS
BS100T5	2 (2 foot)	HT (AC only)	114W (1x14 T5)	120V	AC_3 (aviation cable)	SS (stainless steel clips)
BS100T5HO	4 (4 foot)	SA (AC & Emergency)	214W (2x14 T5)	277V	SPK_4 (single pendant kit)	CH (chain hang kit)
BS100T8			128W (1x28 T5)	120/277V	DPK_4 (double pendant kit)	SL (sanitation listed)
			228W (2x28 T5)	347V <sup>1</sup>	CH_4 (chain hang kit)	TP (tamper proof)
			124W (1x24 T5HO)	480V <sup>2</sup>	TM_4 (trunion mount)	OCC (occupancy sensor)
			224W (2x24 T5HO)		JM <sup>5</sup> (direct mount to j-box)	FP (inline fuse protection)
			154W (1x54 T5HO)		MM (magnetic mount)	
			254W (2x54 T5HO)		PM (pivot mount)	
			117W (1x17 T8)			
			217W (2x17 T8)			
			132W (1x32 T8)			
			232W (2x32 T8)			

NOTE<sup>1</sup>: consult factory for 347V (SA); NOTE<sup>2</sup>: 480V available in AC only.

NOTE<sup>3</sup>: specify length for AC: 72", 150", 250" fully adjustable; NOTE<sup>4</sup>: specify length SPK, DPK, CH & TM options, min 6". Note<sup>5</sup>: JM option - the unit is no longer wet location / IP66 rated.

**HOUSING:** 100% UV stabilized polycarbonate, liquid silicone perimeter gasket with memory retention, integrated stainless steel mounting brackets.

**REFLECTOR:** Dual parabolic (2-lamp versions) and single parabolic (1-lamp versions) high emission reflector. Vacuum metallized finish. Direct mount reflector configuration supports all electrical components.

**DIFFUSER:** High performance diffuser. Complete light emission (CLE) technology. 100% Polycarbonate construction, impact resistant, UV stabilized to reduce yellowing index.

**LAMP/SOCKET:** Two or four T5, T5HO or T8 ratchet type sockets with Beghelli adaptor extenders.

**MOUNTING:** Surface mount configuration as standard. Additional mounting systems are available: including aviation cable, pendants, chain, trunion, magnetic, pivot and direct configurations. Suspension height is to be specified when ordering any suspension mount units: AC, SPK, DPK, CH & TM. (DM configuration mounts directly to the j-box; no longer complies with IP66 wet location rating. Fixture will be suitable for damp environments only.)

**POWER LINE/FEED:** 3-wire, solid type 18awg, pre-stripped 12" leads for quick in-field connection.

**EMERGENCY (SA):** Integral emergency ballast to operate one lamp for a minimum duration of 90 minutes. Reflector mounted monitor indicator and test switch. (SA) for AC & emergency operation. The (SA) version is only available with either 120V or 277V inputs, (consult factory for 347V).

**WEIGHT:** 6.5 lbs. / 2.948 kilo.

**SANITATION LISTED (SL):** is equivalent to the NSF standard 2, meeting the rigorous sanitation, electrical safety and performance standards. The ILLUMINA® BS100 is ideal for use in food service equipment environments.

**WARRANTY:** 5 year warranty, see website for full warranty details.

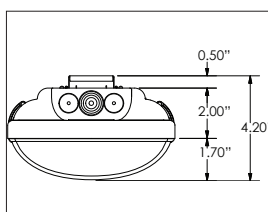
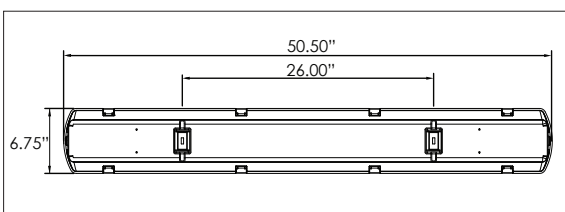

**PHOTOMETRIC DATA:**

**Configuration:** BS100T5HO-4-HT-254W-120/277V  
**Initial Lamp Lumens:** 4450  
**Luminaire Efficiency:** 84.5%

**CANDLE POWER SUMMARY**

ANGLE	ALONG	22.5	45	67.5	ACROSS	OUTPUT LUMENS
0	1862	1862	1862	1862	1862	
5	1857	1869	1897	1925	1935	186
15	1797	1882	1984	2046	2063	553
25	1663	1816	1918	1946	1970	863
35	1462	1659	1747	1828	1948	1092
45	1197	1365	1598	1972	2026	1254
55	894	1076	1449	1527	1478	1163
65	552	842	975	931	908	863
75	230	400	579	661	789	579
85	34	153	342	648	765	429
90	2	115	318	636	713	429
95	11	58	290	547	610	324
105	8	20	135	246	289	151
115	0	4	47	81	85	47
125	0	0	10	24	28	12
135	0	0	2	8	11	3
145	0	0	3	5	5	2
155	0	1	3	5	5	1
165	0	1	2	3	4	0
175	0	0	1	1	2	0
180	0	0	0	0	0	

ZONE	LUMENS	% LAMP	% LUMINAIRE
0-30	1601	17.99	21.29
0-40	2693	30.26	35.81
0-60	5110	57.42	67.94
0-90	6980	78.43	92.81
40-90	4287	48.18	57.01
60-90	1870	21.02	24.87
90-180	540	6.07	7.19
0-180	7521	84.51	100.00

**LUMINANCE SUMMARY**

Angle°	ALONG	45	ACROSS
45°	10803	11653	13884
55°	9797	11897	11197
65°	8019	9485	7957
75°	5187	7163	8516
85°	1857	6091	11175

