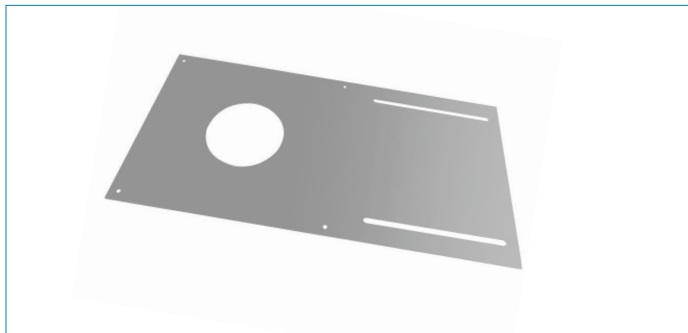
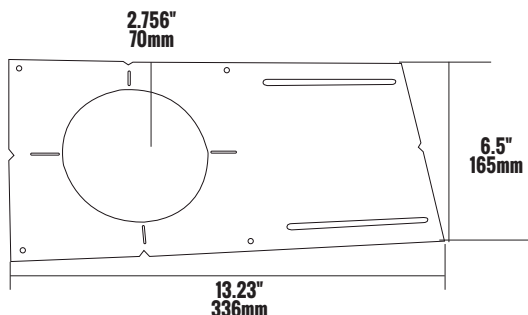

CATALOG #		TYPE
PROJECT		DATE
PREPARED BY		

PRODUCT CODE: DLSGR3-RIP3
ROUGH-IN PLATE FOR 3" ROUND SLIM DOWN LIGHT

PRODUCT DESCRIPTION

The Etlin-Daniels DLSGR3-RIP3 mounting plate is designed for a new construction application. The DLSGR3-RIP3 has multiple nail holes and slots for installation flexibility.

FEATURES

- Constructed from galvanized steel.
- Mounting plate compatible with 3" DLGR LED Slim Gimbal Downlight Series
- Size is: 13.23" x 6.5"
- Cuthole opening size: Ø 2.756"