

Universal Device Mount Covers

Single Gang

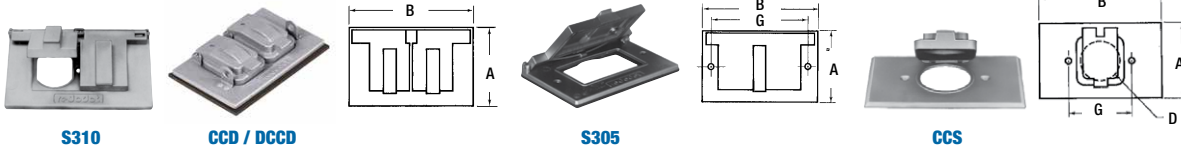

Cat. No.	Description	A (in.)	B (in.)	D (in.)	G (in.)
Single Gang Device Mount Covers – Horizontal (zinc)					
S310BRE	For duplex receptacle – Bronze	2-27/32	4-9/16	-	-
S310E	For duplex receptacle – Silver				
S310WHE	For duplex receptacle – White				
CCD-L	For duplex receptacle with Lock Option				
DCCDS0	For duplex receptacle with Lock Option Stay open – Silver				
DCCDP	For duplex receptacle with Lock Option Stay open – Plastic – Silver				
S305BRE	For GFCI receptacle – Bronze	2-13/16		1-1/2	3-13/16
S305E	For GFCI receptacle – Silver				
S305WHE	For GFCI receptacle – White				
CCS	For single receptacle				

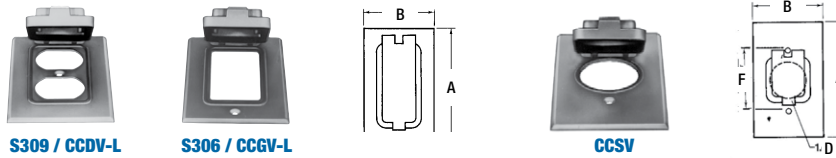

Cat. No.	Description	A (in.)	B (in.)	D (in.)	F (in.)
Single Gang Device Mount Covers – Vertical (zinc)					
S309BRE	For duplex receptacle – Bronze	4-9/16	2-13/16	-	-
S309E	For duplex receptacle – Silver				
S309WHE	For duplex receptacle – White				
CCDV-L	For duplex receptacle with Lock Option				
S306BRE	For GFCI receptacle – Bronze				
S306E	For GFCI receptacle – Silver				
S306WHE	For GFCI receptacle – White				
CCGV-L	For GFCI receptacle with Lock Option				
CCSV	For single receptacle	1-1/2	2-3/8		

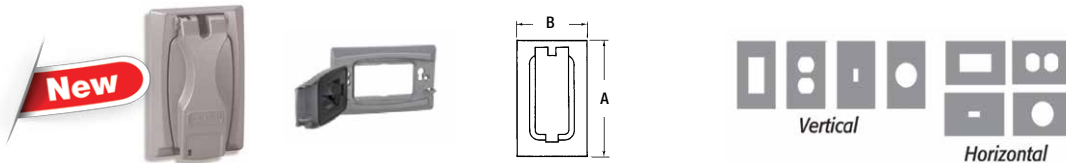

Cat. No.	Description	A (in.)	B (in.)
Single Gang Device Mount Cover – Horizontal and Vertical (zinc)			
CCU'	Flip-lid cover - silver for GFCI, single, duplex or switch configuration supplied with 2 adapters and 2 screws, lockable	4-9/16	2-13/16

Raintight with cover closed and when used with appropriate Red Dot® boxes

† Lock not included

Universal Device Mount Covers

Single Gang



S340E

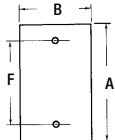

CCMB

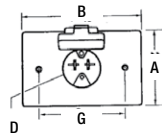

CCPO

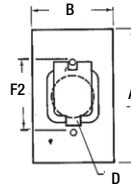

S321E / CCT-1 / SW20-2

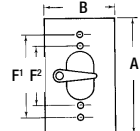

Cat. No.	Description	A (in.)	B (in.)	F (in.)
Single Gang Device Mount Covers (zinc)				
S340E	Blank Cover (Stamped aluminum) – Silver	4-9/16	2-13/16	3-9/32
S340BRE	Blank Cover (Stamped aluminum) – Bronze			
S340WHE	Blank Cover (Stamped aluminum) – White			



Cat. No.	Description	A (in.)	B (in.)	D (in.)	F1 (in.)	F2 (in.)	G (in.)
Single Gang Device Mount Covers (zinc)							
CCMB	Motor Base Cover with 15A, 125V plug	2-3/8	4-9/16	1-35/64	-	-	3-9/32
CCPO	Power outlet cover for 30A and 50A receptacles Box Mount	4-9/16	2-13/16	2-5/32	3-9/32	2-3/8	-
S321E	For switch packed with spacers						
CCT-1	Switch cover with single pole switch 15A, 125V AC						
CCT-1-20	Switch cover with single pole 20A switch, 120V, 277V AC						
SW20-2	Switch cover with double pole 20A switch, 120V, 277V AC (all with spacers and screws)						

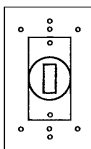

CCK

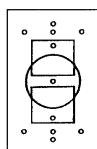

CCSK / S620E



Cat. No.	Description
Single Gang Gaskets	
CCK	Neoprene Gasket
CCSK	Neoprene Gasket
S620E	Neoprene Gasket

Universal Device Mount Covers

Two and Three Gang

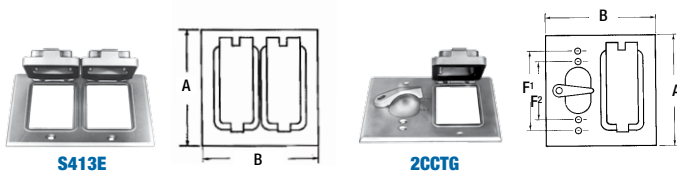

Cat. No.	Description	A (in.)	B (in.)	F1 (in.)	F2 (in.)
Two and Three Gang Device Mount Covers (zinc)					
S413E*	For two GFCI receptacles	4-9/16	4-5/8	-	-
2CCTG*	For switch and GFCI receptacle with spacers			3-9/32	2-3/8

*Raintight with cover closed and when used with appropriate Red Dot® boxes

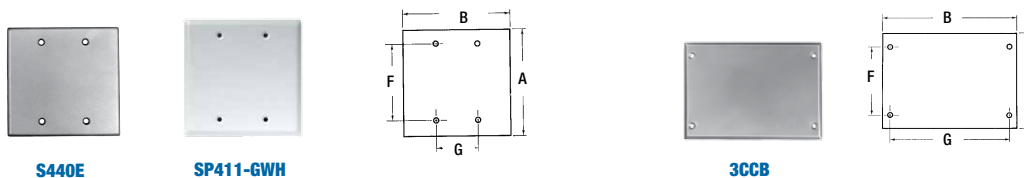

Cat. No.	Description	A (in.)	B (in.)	F (in.)	G (in.)
Two and Three Gang Device Mount Covers (Stamped Aluminum)					
S440E	Blank Cover, Two Gang	4-9/16	4-5/8	3-9/32	1-13/16
SP411-GWH	Blank Cover, Two Gang (Stamped Aluminum) - White	4-1/2	6-3/8	3-1/4	5-5/8
3CCB	Blank Cover, Three Gang	4-9/16	4-5/8	3-9/32	1-13/16



Cat. No.	Colour	Description	A (in.)	B (in.)
Two Gang Covers (zinc)				
2CCU	Silver	Flip-lid cover for GFCI, duplex or single switch configurations supplied with 4 adapters and 4 screws lockable (lock not included)	4-9/16	4-5/8
2CCU-BR	Bronze			
2CCU-WH	White			

Universal Device Mount Covers

Two Gang

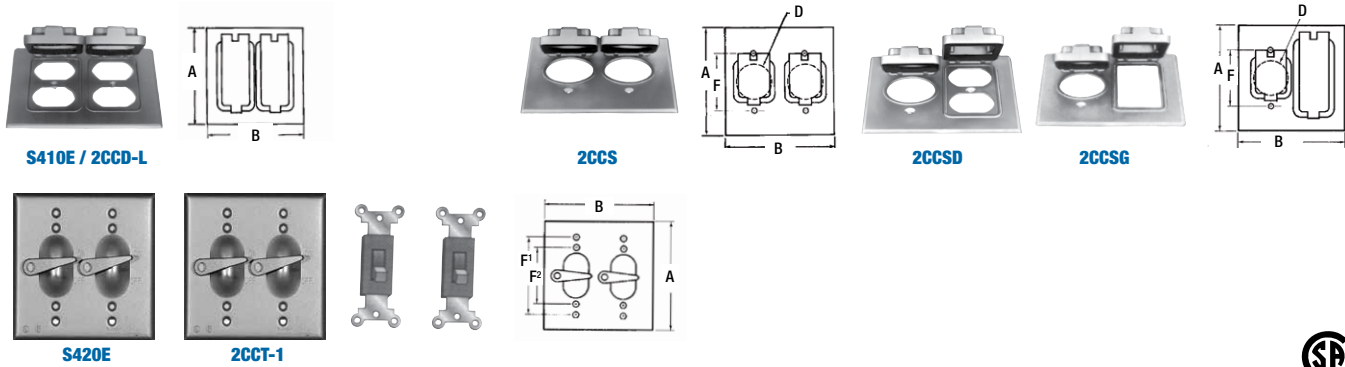

Cat. No.	Description	A (in.)	B (in.)	D (in.)	F (in.)	F1 (in.)	F2 (in.)
Two Gang Device Mount Covers (zinc)							
S410E*	For two duplex receptacles	4-9/16	4-5/8	-	-	-	-
2CCD-L*	For two duplex receptacles with Lock Option (lock not included)			-	-		
2CCS*	For two single receptacles			1-31/64	2-3/8		
2CCSD*	For single and duplex receptacles						
2CCSD-L*	For single and duplex receptacles with Lock Option (lock not included)						
2CCSG*	For single and GFCI receptacles						
S420E*	For two switches with spacers			-	-		
2CCT-1*	Switch cover with two single pole switches 15A, 125V AC						

*Raintight with cover closed and when used with appropriate Red Dot® boxes