

SIGNALLING COLUMN SINGLE-FLASH LIGHT  
ELEMENT YELLOW, 115V AC



Figure similar

General technical data:		
product brand name		SIRIUS
Product designation		Flashlight element
Product component Light source		Yes
Design of the optical signal		flash light
Type of voltage of the operating voltage		AC
Operating voltage		
• 1 at AC at 50 Hz rated value	V	115
• 1 at AC at 60 Hz rated value	V	115
Equipment marking acc. to DIN EN 61346-2		P

Mechanical data:		
Outer diameter of the signal column element	mm	70





Lamp:		
Type of light source		Xenon gas discharge lamp

Ambient conditions:		
Ambient temperature during operation	°C	-20 ... +50
Protection class IP		IP65
Height	mm	65.5

Width

mm 70

Certificates/ approvals:

General Product Approval	EMC	Declaration of Conformity	Shipping Approval	other	
 UL	 EAC	 C-TICK	 EG-Konf.	 DNV	<a href="#">Bestätigungen</a>

Further information

Information- and Downloadcenter (Catalogs, Brochures,...)

<http://www.siemens.com/industrial-controls/catalogs>

Industry Mall (Online ordering system)

<http://www.siemens.com/industrymall>

Cax online generator

<http://support.automation.siemens.com/WW/CAXorder/default.aspx?lang=en&mlfb=8WD44400CD>

Service&Support (Manuals, Certificates, Characteristics, FAQs,...)

<https://support.industry.siemens.com/cs/ww/en/ps/8WD44400CD>

Image database (product images, 2D dimension drawings, 3D models, device circuit diagrams, EPLAN macros, ...)

[http://www.automation.siemens.com/bilddb/cax\\_de.aspx?mlfb=8WD44400CD&lang=en](http://www.automation.siemens.com/bilddb/cax_de.aspx?mlfb=8WD44400CD&lang=en)

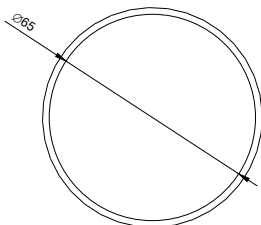
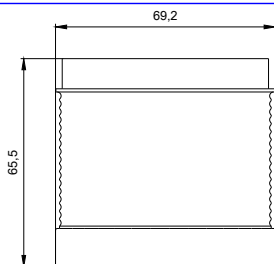

WB:8333: 8WD44...\_ALL

last modified:

23.11.2015