

SIGNALLING COLUMN SINGLE-FLASH LIGHT
ELEMENT TRANSP., 115V AC



Figure similar

General technical data:

| | | |
|--|---|--------------------|
| product brand name | | SIRIUS |
| Product designation | | Flashlight element |
| Product component Light source | | Yes |
| Design of the optical signal | | flash light |
| Type of voltage of the operating voltage | | AC |
| Operating voltage | | |
| • 1 at AC at 50 Hz rated value | V | 115 |
| • 1 at AC at 60 Hz rated value | V | 115 |
| Equipment marking acc. to DIN EN 61346-2 | | P |

Mechanical data:

| | | |
|---|----|----|
| Outer diameter of the signal column element | mm | 70 |
|---|----|----|

Lamp:

| | | |
|----------------------|--|--------------------------|
| Type of light source | | Xenon gas discharge lamp |
|----------------------|--|--------------------------|





Ambient conditions:

| | | |
|--------------------------------------|----|-------------|
| Ambient temperature during operation | °C | -20 ... +50 |
| Protection class IP | | IP65 |
| Height | mm | 65.5 |

Width

mm 70

Certificates/ approvals:

| General Product Approval | EMC | Declaration of Conformity | Shipping Approval | other | |
|---|---|---|---|--|-------------------------------|
|  UL |  |  C-TICK |  EG-Konf. |  DNV | Bestätigungen |

Further information

Information- and Downloadcenter (Catalogs, Brochures,...)

<http://www.siemens.com/industrial-controls/catalogs>

Industry Mall (Online ordering system)

<http://www.siemens.com/industrymall>

Cax online generator

<http://support.automation.siemens.com/WW/CAXorder/default.aspx?lang=en&mlfb=8WD44400CE>

Service&Support (Manuals, Certificates, Characteristics, FAQs,...)

<https://support.industry.siemens.com/cs/ww/en/ps/8WD44400CE>

Image database (product images, 2D dimension drawings, 3D models, device circuit diagrams, EPLAN macros, ...)

http://www.automation.siemens.com/bilddb/cax_de.aspx?mlfb=8WD44400CE&lang=en

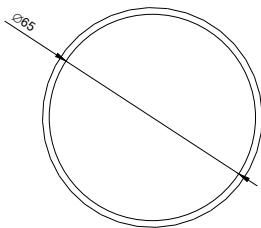
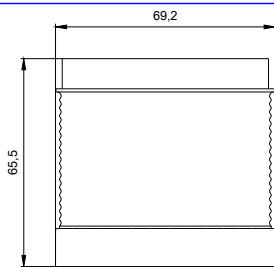

WB:8444: 8WD44..._ALL

last modified:

23.11.2015