

SIGNALLING COLUMN SINGLE-FLASH LIGHT  
ELEMENT TRANSP., 24V DC



#### General technical data:

product brand name		SIRIUS
Product designation		Flashlight element
Product component Light source		Yes
Design of the optical signal		flash light
Type of voltage of the operating voltage		DC
Operating voltage		
• 1 at DC rated value	V	24
Equipment marking acc. to DIN EN 61346-2		P

#### Mechanical data:

Outer diameter of the signal column element	mm	70
---	----	----

#### Lamp:

Type of light source		Xenon gas discharge lamp
----------------------	--	--------------------------

#### Ambient conditions:

Ambient temperature during operation	°C	-20 ... +50
Protection class IP		IP65
Height	mm	65.5
Width	mm	70

Certificates/ approvals:

General Product Approval	EMC	Declaration of Conformity	Shipping Approval	other
--------------------------	-----	---------------------------	-------------------	-------



[Bestätigungen](#)

Further information

**Information- and Downloadcenter (Catalogs, Brochures,...)**

<http://www.siemens.com/industrial-controls/catalogs>

**Industry Mall (Online ordering system)**

<http://www.siemens.com/industrymall>

**Cax online generator**

<http://support.automation.siemens.com/WW/CAXorder/default.aspx?lang=en&mlfb=8WD44200CE>

**Service&Support (Manuals, Certificates, Characteristics, FAQs,...)**

<https://support.industry.siemens.com/cs/ww/en/ps/8WD44200CE>

**Image database (product images, 2D dimension drawings, 3D models, device circuit diagrams, EPLAN macros, ...)**

[http://www.automation.siemens.com/bilddb/cax\\_de.aspx?mlfb=8WD44200CE&lang=en](http://www.automation.siemens.com/bilddb/cax_de.aspx?mlfb=8WD44200CE&lang=en)

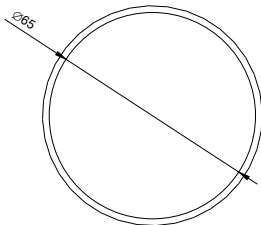
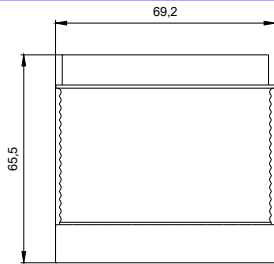

WB 4444: 8WD44-...\_ALL

last modified:

23.11.2015