

SIGNALING COLUMN AS-INTERFACE ELEMENT  
WITH EXT. AUX. VOLTAGE OR WITHOUT EXT. AUX.  
VOLTAGE 24V DC, FOR MAX.4 SIGNAL ELEMENTS



Figure similar

General technical data:		
product brand name		SIRIUS
Type of voltage of the operating voltage		DC
Operating voltage		
• at DC Rated value	V	31.6 ... 18.5
• 1 at DC Rated value	V	24
Equipment marking acc. to DIN EN 61346-2		B
Mechanical data:		
Outer diameter of the signal column element	mm	70
Ambient conditions:		
Ambient temperature during operation	°C	-20 ... +50
Protection class IP		IP65
Design of the interface AS-interface protocol		Yes
Height	mm	65.5
Width	mm	70
Certificates/ approvals:		

General Product Approval	EMC	Declaration of Conformity	Shipping Approval
--------------------------	-----	---------------------------	-------------------



### Further information

**Information- and Downloadcenter (Catalogs, Brochures,...)**

<http://www.siemens.com/industrial-controls/catalogs>

**Industry Mall (Online ordering system)**

<http://www.siemens.com/industrymall>

**Cax online generator**

<http://support.automation.siemens.com/WW/CAXorder/default.aspx?lang=en&mlfb=8WD44280BE>

**Service&Support (Manuals, Certificates, Characteristics, FAQs,...)**

<https://support.industry.siemens.com/cs/ww/en/ps/8WD44280BE>

**Image database (product images, 2D dimension drawings, 3D models, device circuit diagrams, EPLAN macros, ...)**

[http://www.automation.siemens.com/bilddb/cax\\_de.aspx?mlfb=8WD44280BE&lang=en](http://www.automation.siemens.com/bilddb/cax_de.aspx?mlfb=8WD44280BE&lang=en)

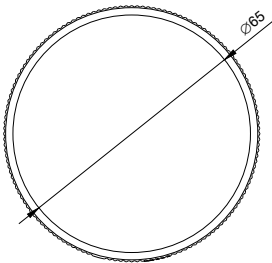
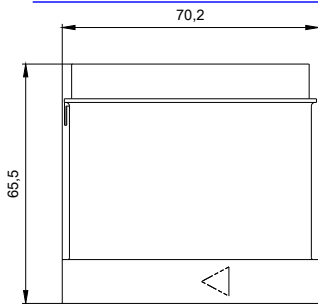

W3 4444  
W3 375; 8WD4428-0Bx\_ALL

last modified:

17.07.2015