

CONTACTOR, 200KW/400V/AC-3 AC(40...60HZ)/DC OPERATION
 UC 575-600V AUXILIARY CONTACTS 2NO+2NC 3-POLE, SIZE
 S12 BAR CONNECTIONS CONVENT. OPERATING MECHANISM
 SCREW TERMINAL



Figure similar

product brand name	SIRIUS
Product designation	power contactor

General technical data:	
Size of contactor	S12
Insulation voltage	
• Rated value	1 000 V
Surge voltage resistance Rated value	8 kV
Protection class IP	
• on the front	IP00
• of the terminal	IP00
Degree of pollution	3
Mechanical service life (switching cycles)	
• of the contactor typical	10 000 000
• of the contactor with added electronics-compatible auxiliary switch block typical	5 000 000
• of the contactor with added auxiliary switch block typical	10 000 000

Ambient conditions:

Installation altitude at height above sea level maximum	2 000 m
Ambient temperature	
• during operation	-25 ... +60 °C
• during storage	-55 ... +80 °C
Main circuit:	
Number of NO contacts for main contacts	3
Number of NC contacts for main contacts	0
Operating current	
• at AC-1 at 400 V	
— at ambient temperature 40 °C Rated value	430 A
• at AC-1 up to 690 V	
— at ambient temperature 40 °C Rated value	430 A
— at ambient temperature 60 °C Rated value	400 A
• at AC-3	
— at 400 V Rated value	400 A
— at 690 V Rated value	400 A
Connectable conductor cross-section in main circuit at AC-1	
• at 60 °C minimum permissible	240 mm ²
• at 40 °C minimum permissible	300 mm ²
Operating current for ≥ 200000 operating cycles at AC-4	
• at 400 V Rated value	150 A
• at 690 V Rated value	135 A
Operating current	
• at 1 current path at DC-1	
— at 24 V Rated value	400 A
— at 110 V Rated value	33 A
• with 2 current paths in series at DC-1	
— at 24 V Rated value	400 A
— at 110 V Rated value	400 A
• with 3 current paths in series at DC-1	
— at 24 V Rated value	400 A
— at 110 V Rated value	400 A
Operating current	
• at 1 current path at DC-3 at DC-5	
— at 24 V Rated value	400 A
— at 110 V Rated value	3 A
• with 2 current paths in series at DC-3 at DC-5	
— at 110 V Rated value	400 A
— at 24 V Rated value	400 A

<ul style="list-style-type: none"> • with 3 current paths in series at DC-3 at DC-5 <ul style="list-style-type: none"> — at 110 V Rated value — at 24 V Rated value 	<p>400 A</p> <p>400 A</p>
Operating power	
<ul style="list-style-type: none"> • at AC-1 <ul style="list-style-type: none"> — at 230 V at 60 °C Rated value — at 400 V Rated value — at 690 V Rated value — at 690 V at 60 °C Rated value • at AC-2 at 400 V Rated value • at AC-3 <ul style="list-style-type: none"> — at 230 V Rated value — at 400 V Rated value — at 500 V Rated value — at 690 V Rated value 	<p>151 kW</p> <p>263 kW</p> <p>454 kW</p> <p>454 kW</p> <p>231 kW</p> <p>132 kW</p> <p>231 kW</p> <p>291 kW</p> <p>400 kW</p>
Operating power for ≥ 200000 operating cycles at AC-4	
<ul style="list-style-type: none"> • at 400 V Rated value • at 690 V Rated value 	<p>85 kW</p> <p>133 kW</p>
Thermal short-time current limited to 10 s	3 200 A
Active power loss at AC-3 at 400 V for rated value of the operating current per conductor	35 W
No-load switching frequency	
<ul style="list-style-type: none"> • at AC • at DC 	<p>2 000 1/h</p> <p>2 000 1/h</p>
Operating frequency	
<ul style="list-style-type: none"> • at AC-1 maximum • at AC-2 maximum • at AC-3 maximum • at AC-4 maximum 	<p>700 1/h</p> <p>200 1/h</p> <p>500 1/h</p> <p>130 1/h</p>
Control circuit/ Control:	
Type of voltage of the control supply voltage	AC/DC
Control supply voltage at AC	
<ul style="list-style-type: none"> • at 50 Hz Rated value • at 60 Hz Rated value 	<p>575 ... 600 V</p> <p>575 ... 600 V</p>
Control supply voltage at DC	
<ul style="list-style-type: none"> • Rated value • Rated value 	<p>575 ... 600 V</p> <p>40 Hz</p>
Control supply voltage frequency 2 Rated value	60 Hz
Operating range factor control supply voltage rated value of the magnet coil at AC	
<ul style="list-style-type: none"> • at 50 Hz 	0.8 ... 1.1

<ul style="list-style-type: none"> • at 60 Hz 	0.8 ... 1.1
Operating range factor control supply voltage rated value of the magnet coil at DC	0.8 ... 1.1
Design of the surge suppressor	with varistor
Apparent pick-up power of the magnet coil at AC	830 V·A
Inductive power factor with closing power of the coil	0.9
Apparent holding power of the magnet coil at AC	9.2 V·A
Inductive power factor with the holding power of the coil	0.9
Closing power of the magnet coil at DC	920 W
Holding power of the magnet coil at DC	10 W
Closing delay	
<ul style="list-style-type: none"> • at AC 	45 ... 100 ms
<ul style="list-style-type: none"> • at DC 	45 ... 100 ms
Arcing time	10 ... 15 ms

Auxiliary circuit:

Number of NC contacts	
<ul style="list-style-type: none"> • for auxiliary contacts <ul style="list-style-type: none"> — instantaneous contact 	2
Number of NO contacts	
<ul style="list-style-type: none"> • for auxiliary contacts <ul style="list-style-type: none"> — instantaneous contact 	2
Operating current at AC-12 maximum	10 A
Operating current at AC-15	
<ul style="list-style-type: none"> • at 230 V Rated value • at 400 V Rated value 	6 A 3 A
Operating current at DC-12	
<ul style="list-style-type: none"> • at 60 V Rated value • at 110 V Rated value • at 220 V Rated value 	6 A 3 A 1 A
Operating current at DC-13	
<ul style="list-style-type: none"> • at 24 V Rated value • at 60 V Rated value • at 110 V Rated value • at 220 V Rated value 	10 A 2 A 1 A 0.3 A

UL/CSA ratings:

Contact rating of the auxiliary contacts acc. to UL	A600 / Q600
--	-------------

Short-circuit:

Design of the fuse link	
<ul style="list-style-type: none"> • for short-circuit protection of the main circuit <ul style="list-style-type: none"> — with type of assignment 1 required 	fuse gL/gG: 630 A

- with type of assignment 2 required
- for short-circuit protection of the auxiliary switch required

fuse gL/gG: 500 A

fuse gL/gG: 10 A

Installation/ mounting/ dimensions:

Mounting type	screw fixing
• Side-by-side mounting	Yes
Height	214 mm
Width	160 mm
Depth	225 mm
Required spacing	
• for grounded parts	
— at the side	10 mm

Connections/ Terminals:

Type of electrical connection	
• for main current circuit	screw-type terminals
• for auxiliary and control current circuit	screw-type terminals
Type of connectable conductor cross-section	
• for AWG conductors for main contacts	2/0 ... 500 kcmil
Type of connectable conductor cross-section	
• for auxiliary contacts	
— solid	2x (0.5 ... 1.5 mm ²), 2x (0.75 ... 2.5 mm ²), max. 2x (0.75 ... 4 mm ²)
— finely stranded with core end processing	2x (0.5 ... 1.5 mm ²), 2x (0.75 ... 2.5 mm ²)
• for AWG conductors for auxiliary contacts	2x (20 ... 16), 2x (18 ... 14), 1x 12

Certificates/ approvals:

General Product Approval	Functional Safety/Safety of Machinery	Declaration of Conformity
--------------------------	---------------------------------------	---------------------------



[Baumusterbescheinigung](#)



Test Certificates	Shipping Approval
-------------------	-------------------

[Typprüfbescheinigung/Werkszeugnis](#)

[spezielle Prüfbescheinigungen](#)



other

[Umweltbestätigung](#)

[Bestätigungen](#)

[sonstige](#)

Further information

Information- and Downloadcenter (Catalogs, Brochures,...)

<http://www.siemens.com/industrial-controls/catalogs>

Industry Mall (Online ordering system)

<http://www.siemens.com/industrymall>

Cax online generator

<http://support.automation.siemens.com/WW/CAXorder/default.aspx?lang=en&mfb=3RT10756AT36>

Service&Support (Manuals, Certificates, Characteristics, FAQs,...)

<https://support.industry.siemens.com/cs/ww/en/ps/3RT10756AT36>

Image database (product images, 2D dimension drawings, 3D models, device circuit diagrams, EPLAN macros, ...)

http://www.automation.siemens.com/bilddb/cax_de.aspx?mfb=3RT10756AT36&lang=en

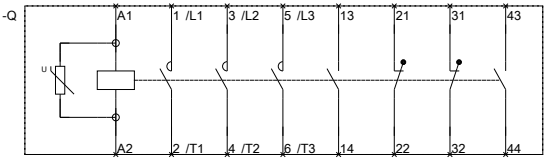
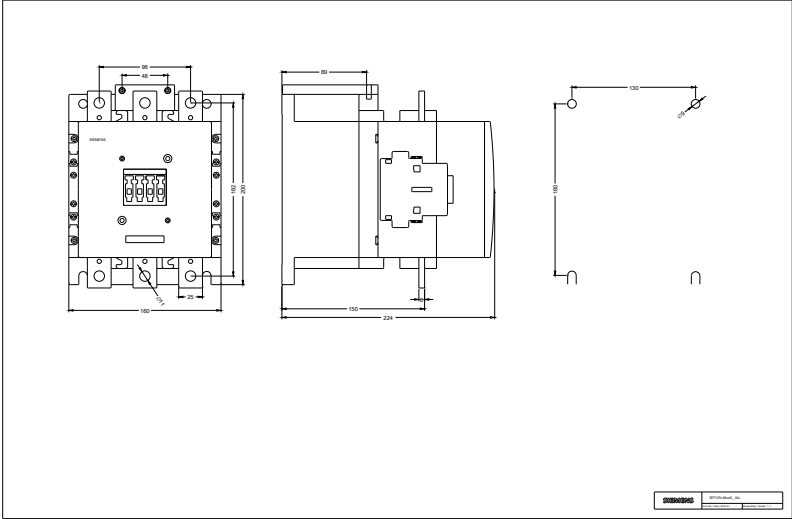

last modified:

29.07.2015

3RT106-A-6_01_4_IEC.DXF
3RT107-A-6_01_4_IEC.DXF