



**Medium Base
Lamp Receptacle
with Strap
Shock Absorbing**

Cat. #
V84✓



Reflectors



Dome



30° Angle

Max. Lamp Size	Dome Cat. #	30° Angle Cat. #
150 watt, A-21	RD64✓	RA64✓
200 watt, A-23, A-25, PS-25 and 300 watt, PS-30	RD71✓	RA71✓



VXFT – 5 Hubs, 4 Plugs

Hub Size	Cat. #
1/2	VXFT10✓
3/4	VXFT20✓

For use when rear wiring entry is required. Use in lieu of VXF10 or VXF20.

✓ – available with Lightning Service™
See Section G for complete details

Globes† and Guards



150 and 200W globe



300W globe

Maximum Lamp Size		
150 Watt, A-21	200 Watt, A-23, A-25, PS-25	300 Watt, PS-25, PS-30‡

Color	Cat. #	Cat. #	Cat. #
Clear (heat-resisting)	G54✓	G24♦✓	{ G34✓ G251✓
Green	G55*✓	G25	
Blue	G56*✓	G26	
Red	G57*✓	G27	
Amber	G58*✓	G28	



Guard P50 and P21



Guard P22

Guards for Glass Globes (Not for use with plastic globes)

Cat. #	Maximum Lamp Size
P50✓	150 watt, A-21
P21✓	200 watt, A-23, A-25, PS-25
P22✓	300 watt, PS-30 (with G251 only)

Plastic Globes ①



Shatterproof polycarbonate plastic globe**

Application:

- For use in:
- food processing plants and canneries, dairies, breweries and bakeries
 - emergency lighting

Features:

- Shatterproof, which precludes contamination of food products with broken particles of glass.
- Designed to comply with U.S. Dept. of Agriculture specification for food processing plants.
- Provides protection against vandalism, with resultant lower replacement and maintenance costs.
- Particularly adaptable for use on emergency police or fire alarm boxes.
- Same size as G24 series glass globes. Existing installations can be changed to plastic globes simply by replacing globe.
- For use with 200 watt series luminaires such as VDA22, etc.
- For use without guard.

Color	Max. Wattage, Lamp Size	Cat. #
Natural	200 watt, A-23	G63✓
Green	200 watt, A-23	G65
Red	200 watt, A-23	G67

Note: Polycarbonate globes for non-hazardous locations only.

♦ G24 is available with a TEFLON® coating for increased shatter protection by adding suffix S808.

* With G55, G56, G57, G58 color globes, maximum lamp size is 60 watt for outdoor applications.

** Prior to wash-down, globes must be cool.

† All glass globes are configured type, having fluted side and stippled bottom.

‡ Globe G251 required when guard P22 is used. Use globe G34 when guard is not used.

① Lamp must be mounted in vertical position base up to 45°C (stanchion) only.

Application:

Corro•Gard™ NDA series Luminaires made of Krydon® fiberglass-reinforced polyester are used to provide incandescent lighting:

- indoors or outdoors in industrial wet or dirty locations and where corrosion is a problem
- in marine applications, above and below deck, where salt spray corrosion shortens fixture life
- in food and beverage industries where frequent wash-downs are necessary
- for walkways, bridges, tunnels, security lighting, cold storage facilities, garages, coal handling areas, shipboard, processing plants, and nuclear generating plant containment areas

Features:

- Luminaire is molded Krydon® for excellent corrosion, heat, and impact resistance.
- Accommodates all popular incandescent lamps up to 300W, PS-25.
- Attractive modern design and color complement other Corro•Gard products.
- Weighs only 8½ lbs. complete with lamp and globe.
- Medium screw base porcelain lamp socket has a vibration absorbing mounting bracket.
- All joints are gasketed to ensure watertightness.
- Configured glass globe reduces glare.
- Corro•Gard reflectors made of Krydon® reflect light better than porcelainized steel; do not yellow or discolor with age; cannot chip, peel, rust or dent.

Standard Materials:

- Bodies and reflectors – Krydon® fiberglass-reinforced polyester material
- Globes – configured heat-resistant glass

Standard Finishes:

- Bodies – natural
- Reflectors – natural, high reflectance white

Options:

- TEFLON® coating on G24 globe for increased shatter protection. add suffix S808.

Accessories & Parts

Globe



Color	Cat. #
Clear (heat resisting)	G24
Green	G25
Blue	G26
Red	G27
Amber	G28

Guard



Cat. #
P21



Certifications and Compliances:

- UL Standard: 1598
- Wet Locations
- Suitable for 40°C ambient temperature

Dimensions

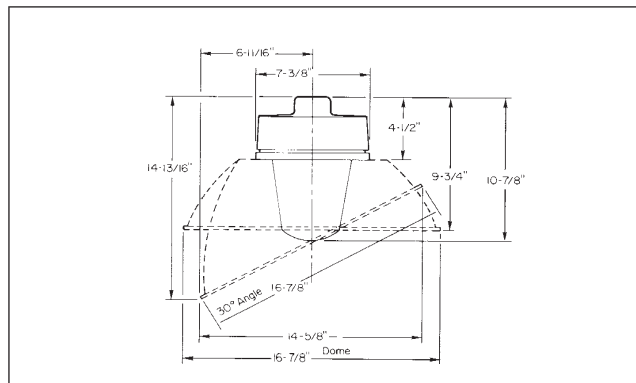

NDA Series Ordering Information For Pendant Mounting

Hub Size	Max. Lamp Size	Body Only Cat. #	Globe Only Cat. #	Body With Globe† Cat. #
¾"	300W PS-25 Med. Base 120V	NDA22	G24	NDA22G

Temperature Performance Data: (based on 40°C ambient)

Max. Lamp Size	T-Number	Supply Wire (°C)
300W	T2A	150°C

(Note: Fixtures are not marked with T-Number.)

Replacement Lamp Receptacles with Strap Shock Absorbing



Cat No. NV84

Reflectors (Order separately)



Dome

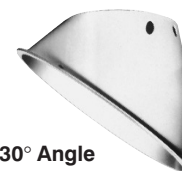

30° Angle

Type	Cat. #
Dome	RD725 (RD75)
30° Angle	RA725 (RA75)